

**LEASE**  
6235 N. Fresno, SP 103

Fresno, CA 93710

**PRESENTED BY:**

**CAMERON GRAHAM**

O: 559.400.0830

cameron.graham@svn.com

CalDRE #01970844



# PROPERTY SUMMARY

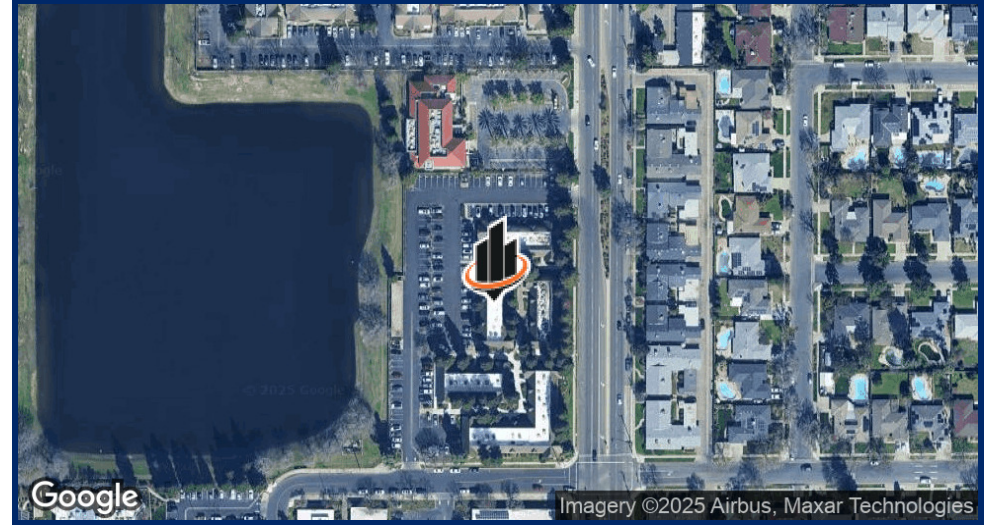

## OFFERING SUMMARY

|                       |                      |
|-----------------------|----------------------|
| <b>LEASE RATE:</b>    | \$1.95 SF/month (MG) |
| <b>AVAILABLE SF:</b>  | 1,944 SF             |
| <b>LOT SIZE:</b>      | 0.38 Acres           |
| <b>BUILDING SIZE:</b> | 5,504 SF             |

## PROPERTY DESCRIPTION

6235 N Fresno St Suite 103 is located on the corner of N Fresno St and E Escalon Ave in Coventry Square. Coventry Square is comprised of five buildings with medical and general office use. Property includes ample parking, and is located in close proximity to Highway 41.

## PROPERTY HIGHLIGHTS

- Great Location
- Ample Parking
- Close to Hwy 41

### CAMERON GRAHAM

O: 559.400.0830  
cameron.graham@svn.com  
CalDRE #01970844

**FLOOR PLANS**

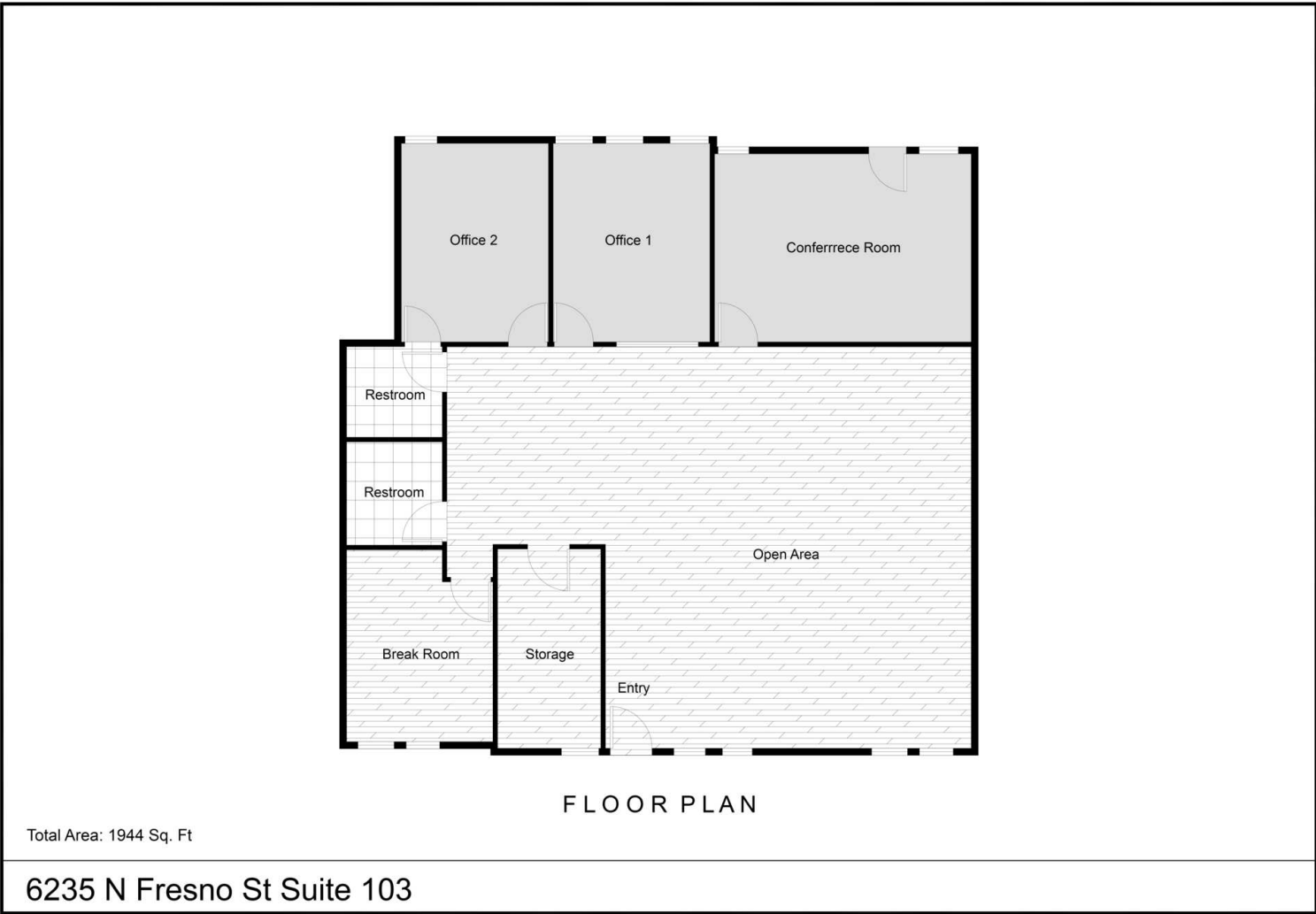

**CAMERON GRAHAM**  
O: 559.400.0830  
cameron.graham@svn.com  
CalDRE #01970844

## ADDITIONAL PHOTOS



**CAMERON GRAHAM**  
O: 559.400.0830  
cameron.graham@svn.com  
CalDRE #01970844

# LOCATION MAP

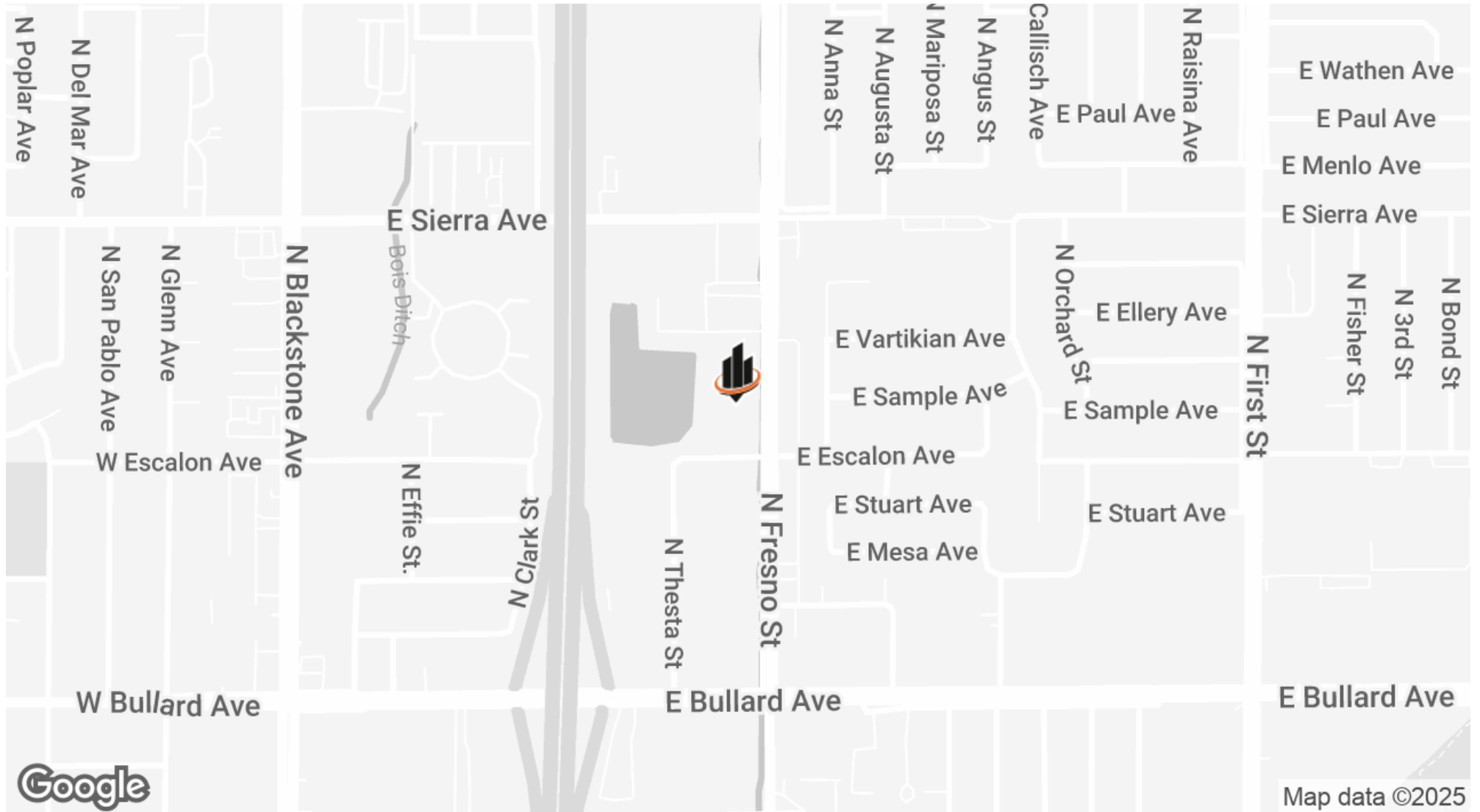

**CAMERON GRAHAM**  
O: 559.400.0830  
cameron.graham@svn.com  
CalDRE #01970844