

SPACE FOR LEASE

1879 N State Road 7 - Lauderhill

Address: 1879 N SR 7, LAUDERHILL, FL 33313

**Only 2 Spaces Remaining
7,883 SF. & 7,025 SF.**



SPACE FEATURES

- + 2 units remaining
- + 7,883 SF.
- + 7,025 SF.
- + Signage available

Demographics

1 Mile

Population - 29,919
Households - 11,050
Median Household Income - \$37,553

3 Mile

Population - 199,082
Households - 72,159
Median Household Income - \$46,062

Traffic : 50,000 State Rd 7

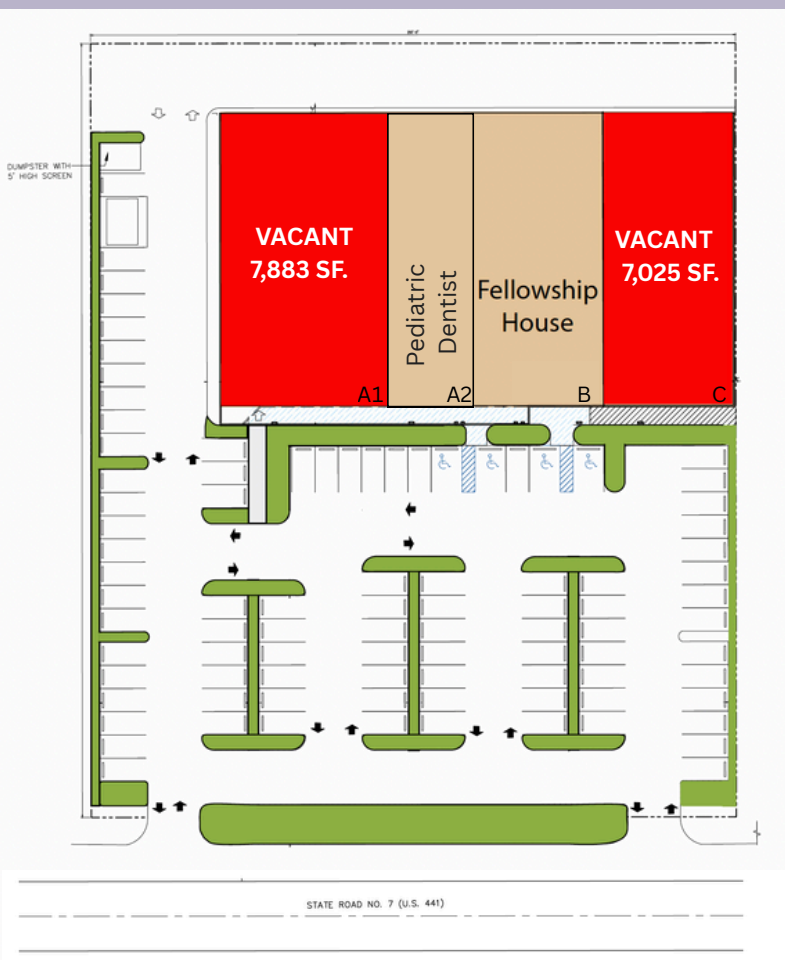

For More Information contact Hector Gutierrez
305.527.7170 - Hector.Gutierrez@imcequitygroup.com