

Vail Headquarters at Redhawk Towne Center

32115-32127 Temecula Parkway
Temecula, CA 92592

FOR LEASE



JOIN:



2,231± SF

- Endcap with large potential outdoor area
- Historical Development within the Redhawk Towne Center Shopping Center in the heart of South Temecula
- One of the top shopping destinations in Temecula

**WATCH
CENTER
VIDEO**



Exclusively Marketed By:

Scott Forest
Senior Vice President
CA License # 01396577
(951) 491-6300
sforest@westmarcre.com



41623 Margarita Road, Suite 100, Temecula, CA 92591 | Ph: 951.491.6300 | www.WestMarCRE.com

The above information, while not guaranteed, has been secured from sources we believe to be reliable. Floor plan, site plan, price, tenant mix, and availability subject to change without notice.



State Highway Route 79 South / Temecula Parkway

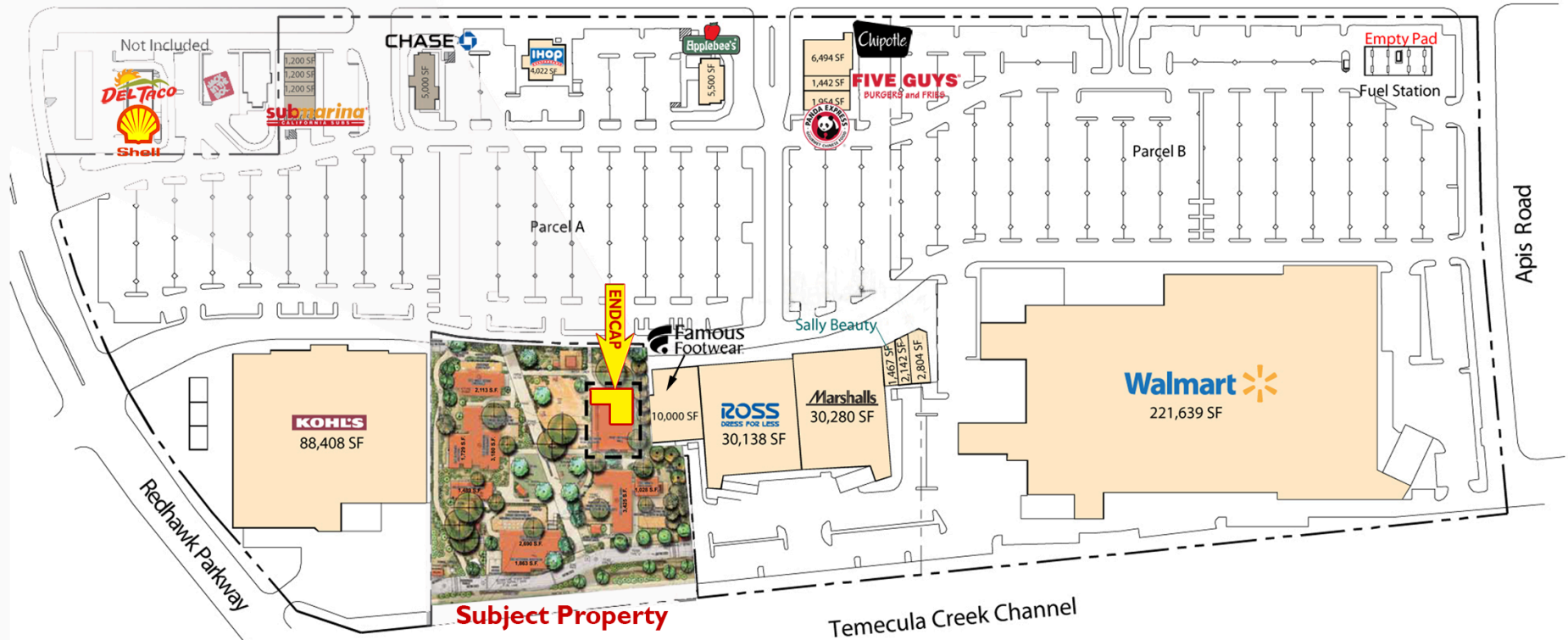

Vail Headquarters at Redhawk Towne Center | 32115-32127 Temecula Parkway, Temecula, CA 92592

FOR LEASE



41623 Margarita Road, Suite 100, Temecula, CA 92591 | Ph: 951.491.6300 | www.WestMarCRE.com

The above information, while not guaranteed, has been secured from sources we believe to be reliable. Floor plan, site plan, price, tenant mix, and availability subject to change without notice.

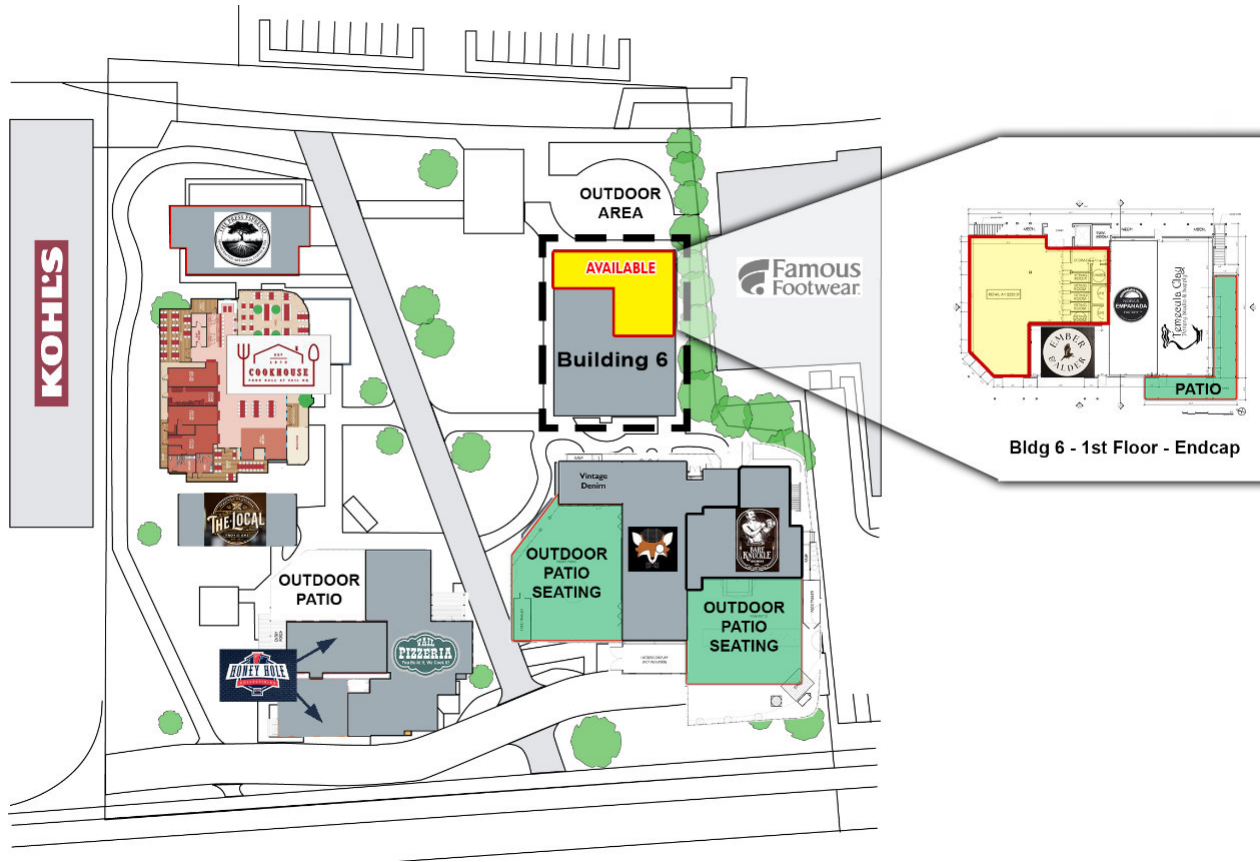

BUILDING	TENANT	SQ.FT.	PSF RATE (NNN)
1 (32115)	The Press Espresso	2,337±	----
2 (32117)	Food Court	5,202±	----
3A (32123-A1)	Honey Hole Collectibles	1,556±	----
3A (32123-A2)	Honey Hole Collectibles	1,094±	----
3B (32123-B)	Vail Pizzeria	1,094±	----
4A (32125-A)	Escape Room	2,259±	----
4B (32125-B)	Vintage Denim	1,227±	----
4C (32125-C)	Bare Knuckle Brewery	2,403±	----
4 - 2nd Floor			
5 (32119)	The Local	1,473±	----
6 - First Floor (32127)			
A	Available	2,231±	\$3.25 Plus NNN
B	Ember & Alder	540±	----
C	Nora's Empanadas	1,131±	----
D	Temecula Clay	1,358±	----
6 - Second Floor (32127)			
D	Buffalo Barber Shop	2,953±	----
E	Tech Steam	1,780±	----

**2026 NNN Estimated at \$1.15 PSF*



Vail Headquarters at Redhawk Towne Center | 32115-32127 Temecula Parkway, Temecula, CA 92592

FOR LEASE



41623 Margarita Road, Suite 100, Temecula, CA 92591 | Ph: 951.491.6300 | www.WestMarCRE.com

The above information, while not guaranteed, has been secured from sources we believe to be reliable. Floor plan, site plan, price, tenant mix, and availability subject to change without notice.

Features

- Monument signage available
- Unique historic redevelopment within the prominent Redhawk Towne Center
- 4 Acre historic redevelopment project in park-like setting surrounded by major anchor tenants
- Entertainment and special events including Sunday Funday, Farmer’s Market, etc.
- Walking distance to Temecula Hospital
- SEC Temecula Parkway & Redhawk Parkway
- 5,000± SF Foodhall with 4 restaurants & bar



Demographics

Source: CoStar 2025	1 mile	3 mile	5 mile
2025 Population (Estimated)	16,131	78,295	114,343
2030 Population (Projected)	16,353	79,579	116,786
Daytime Employee Population	6,890	19,982	53,489
Average Household Income	\$140,709	\$153,486	\$145,663

Traffic Counts

Source: CoStar 2025	ADT
Temecula Parkway and Margarita Road	40,326
Redhawk Parkway South of Temecula Parkway	27,397



Vail Headquarters at Redhawk Towne Center | 32115-32127 Temecula Parkway, Temecula, CA 92592

FOR LEASE



41623 Margarita Road, Suite 100, Temecula, CA 92591 | Ph: 951.491.6300 | www.WestMarCRE.com

The above information, while not guaranteed, has been secured from sources we believe to be reliable. Floor plan, site plan, price, tenant mix, and availability subject to change without notice.

BUILDING 6 - FIRST FLOOR - FLOOR PLAN

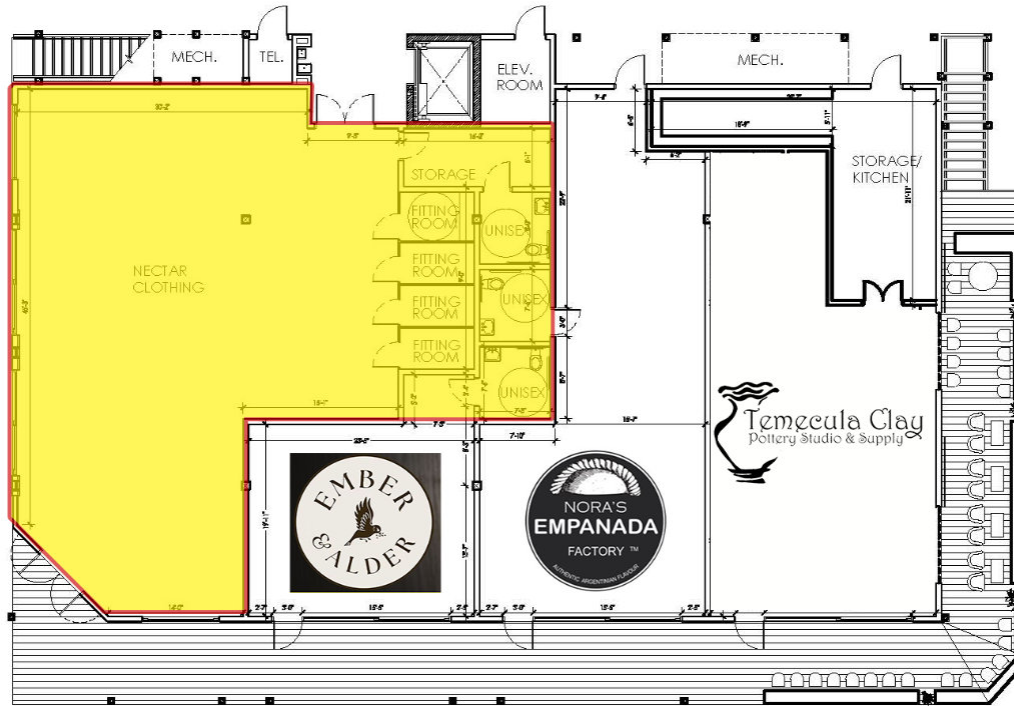

WATCH BUILDING VIDEO

FIRST FLOOR ENDCAP AVAILABLE



Vail Headquarters at Redhawk Towne Center | 32115-32127 Temecula Parkway, Temecula, CA 92592

FOR LEASE



41623 Margarita Road, Suite 100, Temecula, CA 92591 | Ph: 951.491.6300 | www.WestMarCRE.com

The above information, while not guaranteed, has been secured from sources we believe to be reliable. Floor plan, site plan, price, tenant mix, and availability subject to change without notice.



Vail Headquarters at Redhawk Towne Center | 32115-32127 Temecula Parkway, Temecula, CA 92592

FOR LEASE



41623 Margarita Road, Suite 100, Temecula, CA 92591 | Ph: 951.491.6300 | www.WestMarCRE.com
 The above information, while not guaranteed, has been secured from sources we believe to be reliable. Floor plan, site plan, price, tenant mix, and availability subject to change without notice.



Other retailers at intersection:



Vail Headquarters at Redhawk Towne Center | 32115-32127 Temecula Parkway, Temecula, CA 92592

FOR LEASE



41623 Margarita Road, Suite 100, Temecula, CA 92591 | Ph: 951.491.6300 | www.WestMarCRE.com

The above information, while not guaranteed, has been secured from sources we believe to be reliable. Floor plan, site plan, price, tenant mix, and availability subject to change without notice.