

# 9720 TOPANGA CANYON PLACE

Chatsworth, CA 91311

UNIT  
**B**

INDUSTRIAL/OFFICE UNIT | FOR LEASE



## JOE JUSKO

Principal

818.223.4397

[jjusko@lee-re.com](mailto:jjusko@lee-re.com)

[www.jjusko.com](http://www.jjusko.com)

DRE #00875413



**LEE & ASSOCIATES**  
COMMERCIAL REAL ESTATE SERVICES

**Lee & Associates®-LA North/Ventura, Inc.**

*A Member of the Lee & Associates Group of Companies*

Corporate ID #01191898

5707 Corsa Ave, Suite 200, Westlake Village, CA 91362

818.223.4388 M 818.591.1450 F

All information furnished regarding the property is from sources deemed reliable, but no warranty or representation is made as to the accuracy thereof. This information is submitted subject to errors, omissions, change of price or terms, prior sale or lease, or withdrawal without notice. No liability of any kind is to be imposed on the broker herein.

# 9720 TOPANGA CANYON PLACE

CHATSWORTH, CA 91311

## Industrial/Office Unit for Lease



### SPECIFICATIONS

AVAILABLE SF:	4,608 SF
OFFICE SF:	576 SF
LOADING:	12x12 Ground Level
WHSE CLR HEIGHT:	16'
POWER:	200A/240V/3Ph
PARKING:	6 Spaces

### HIGHLIGHTS

- Ideal Multi-Purpose Facility
- Convenient Chatsworth Location
- Rear Yard Area

### LEASE RATE

- \$1.35 PSF/Mo/Industrial Gross
- 3-5 Years w/COLA
- Plus Prorata Utilities



# 9720 TOPANGA CANYON PLACE

CHATSWORTH, CA 91311

Industrial/Office Unit for Lease

All Temperatures Controlled  
9720 Topanga Canyon Place, Chatsworth, CA 91311

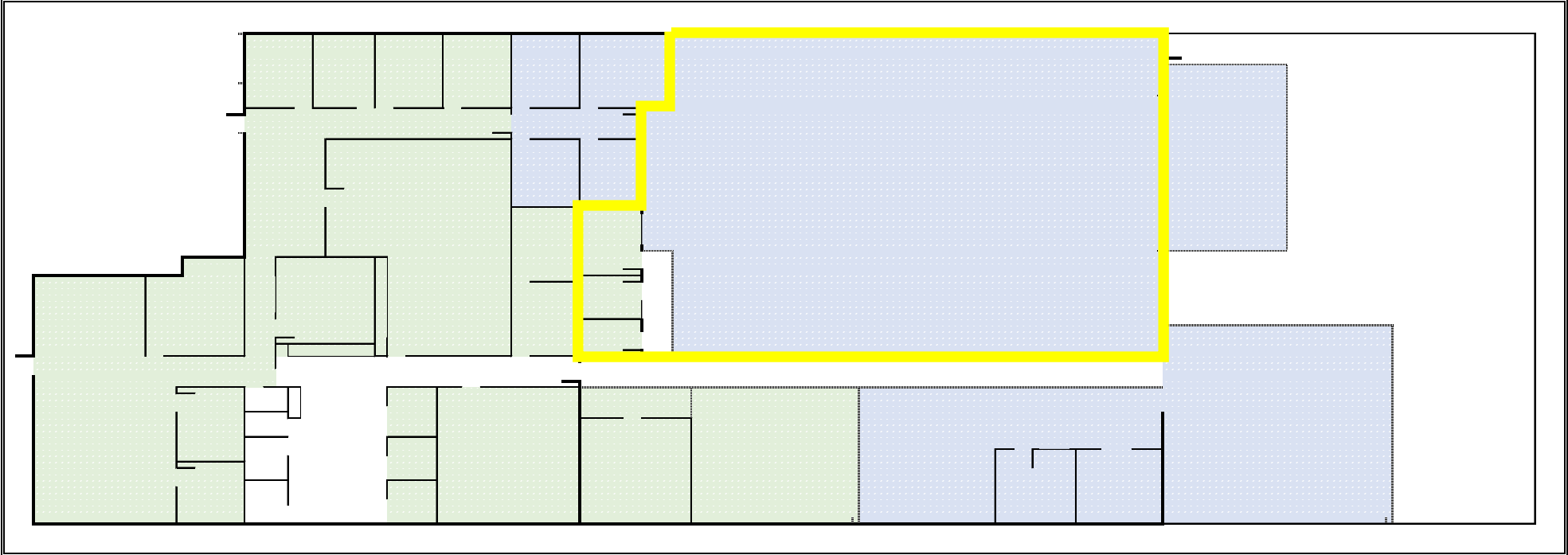

— AVAILABLE



# 9720 TOPANGA CANYON PLACE

CHATSWORTH, CA 91311

Industrial/Office Unit for Lease

9720 TOPANGA CANYON PL, UNIT B

CHATSWORTH, CA



# 9720 TOPANGA CANYON PLACE

CHATSWORTH, CA 91311

## Industrial/Office Unit for Lease

