

AVAILABLE IMMEDIATELY

±310,100 SQUARE FOOT INDUSTRIAL BUILDING

VINTAGE PARK EAST

11754 CABERNET DRIVE, FONTANA, CALIFORNIA



Voit
REAL ESTATE SERVICES

INSTITUTIONALLY OWNED BY:

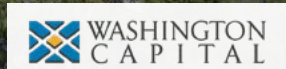

11754 CABERNET DRIVE

FONTANA, CALIFORNIA

PROPERTY OVERVIEW



±310,100 SQUARE FOOT INDUSTRIAL BUILDING



±3,000 SQUARE FOOT OFFICE



ESFR SPRINKLER SYSTEM



30' CLEARANCE HEIGHT



CROSS DOCK LOADING



79 DOCK HIGH DOORS
14 MECHANICAL LOAD LEVELERS



2 GROUND LEVEL DOORS
12' X 14'



50' X 52'
COLUMN SPACING



2000 AMPS (VERIFY)



BATTERY CHARGING STATIONS



LED MOTION SENSOR LIGHTING



LOW OPERATING EXPENSES

Voit

REAL ESTATE SERVICES

3280 E. GUSTI ROAD, SUITE 100 | ONTARIO | CALIFORNIA 91761 | VOITCO.COM

JUAN GUTIERREZ, SIOR

EXECUTIVE VICE PRESIDENT, PARTNER

909.545.8008

jgutierrez@voitco.com

License #01777990

WALT CHENOWETH

EXECUTIVE VICE PRESIDENT, PARTNER

909.545.8007

wchenoweth@voitco.com

License #00852776

11754 CABERNET DRIVE

FONTANA, CALIFORNIA

SITE PLAN

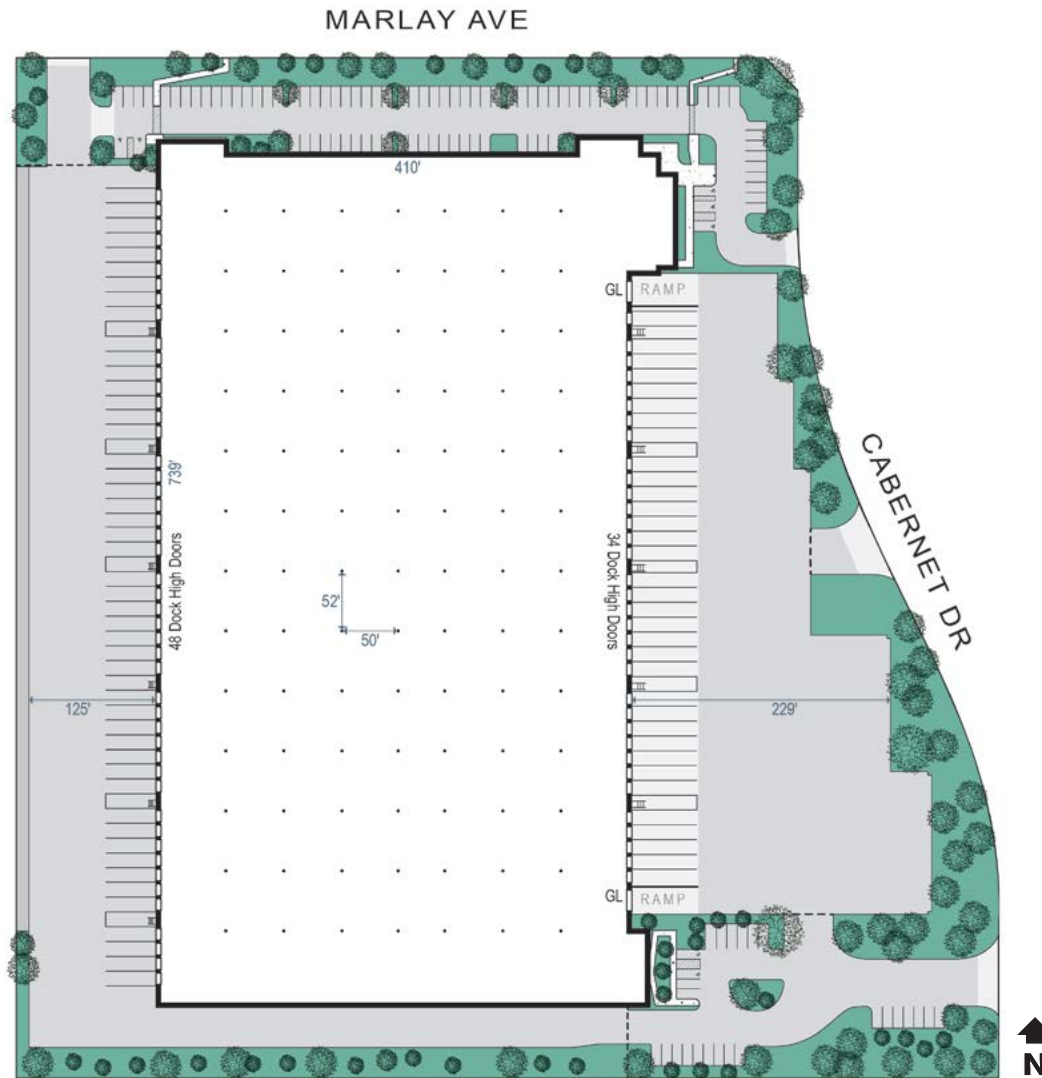

Voit

REAL ESTATE SERVICES

3280 E. GUAISTI ROAD, SUITE 100 | ONTARIO | CALIFORNIA 91761 | VOITCO.COM

JUAN GUTIERREZ, SIOR
EXECUTIVE VICE PRESIDENT, PARTNER
909.545.8008
jgutierrez@voitco.com
License #01777990

WALT CHENOWETH
EXECUTIVE VICE PRESIDENT, PARTNER
909.545.8007
wchenoweth@voitco.com
License #00852776

11754 CABERNET DRIVE

FONTANA, CALIFORNIA

TENANT AERIAL

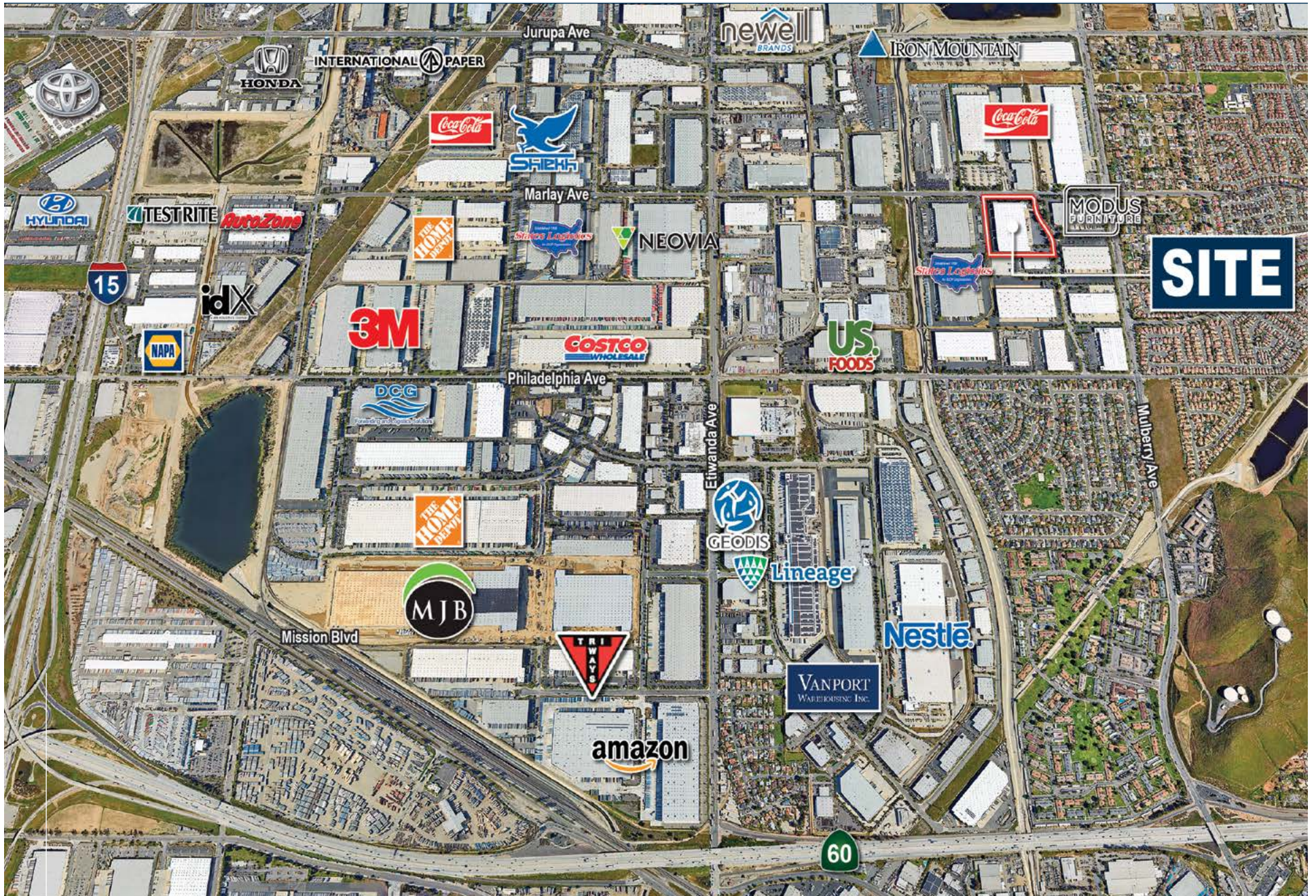

11754 CABERNET DRIVE

FONTANA, CALIFORNIA

LOCATION MAP

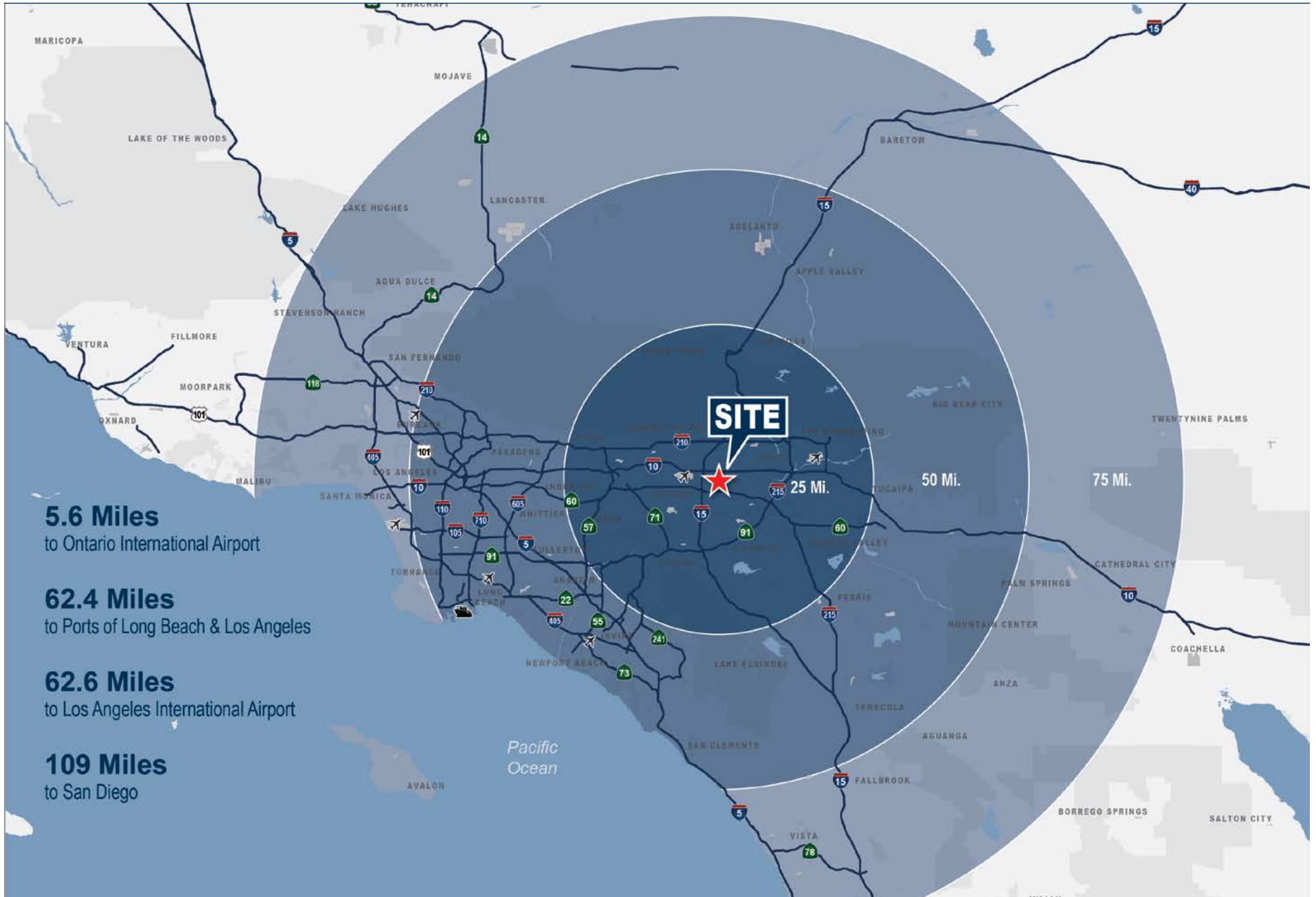

CONTACT INFORMATION

VINTAGE PARK EAST

11754 CABERNET DRIVE, FONTANA, CALIFORNIA



Voit
REAL ESTATE SERVICES

JUAN GUTIERREZ, SIOR
EXECUTIVE VICE PRESIDENT, PARTNER
909.545.8008
jgutierrez@voitco.com
License #01777990

WALT CHENOWETH
EXECUTIVE VICE PRESIDENT, PARTNER
909.545.8007
wchenoweth@voitco.com
License #00852776

INSTITUTIONALLY OWNED BY:

