

Food Service/Retail | For Lease

**CBRE**

# The Pavilion Food Court

@ State House Square | Hartford, CT



Retail Food Service and Professional Service/Amenities Space in Hartford's Premier Office Complex



# Multiple Suites Available

Small-Scale Retail Food-Service Opportunities in the Newly Updated Pavilion Food Court at State House Square



**CBRE is pleased to offer for lease multiple small-scale retail food service suites measuring approximately 900 SF each.** The State House Square Pavilion Food Court has been completely updated with modern furniture and finishes and offers tenants and visitors the option of something quick on the go; as well as ample seating for patrons to meet up with co-workers and friends and enjoy a sit-down lunch - where there's something different for everyone to enjoy. In addition to food-service opportunities, the Pavilion also has several larger suites available for lease that are suitable for a variety of professional services including a gift store/sundries shop, hair salon/beauty services, nail spa, etc. Currently available food court suites include Units 2 - 5 (as numbered on the opposite page). *Join Ajamo, Next Door Burger, Jerk Shack and Poke Sushi in Hartford's premier office complex.*

State House Square offers a prominent corporate address, modern office space and best-in-class tenant amenities, along with ground floor retail services and restaurant/food services; all in a central downtown location that is in close proximity to the majority of Hartford's amenities, recreation and entertainment options. The Pavilion Food Court at State House Square is immediately accessible from the State House Square Plaza and convenient to all of Hartford's daytime population, with public transportation right on Main Street, located directly across from the 10 State House Square lobby entrance.

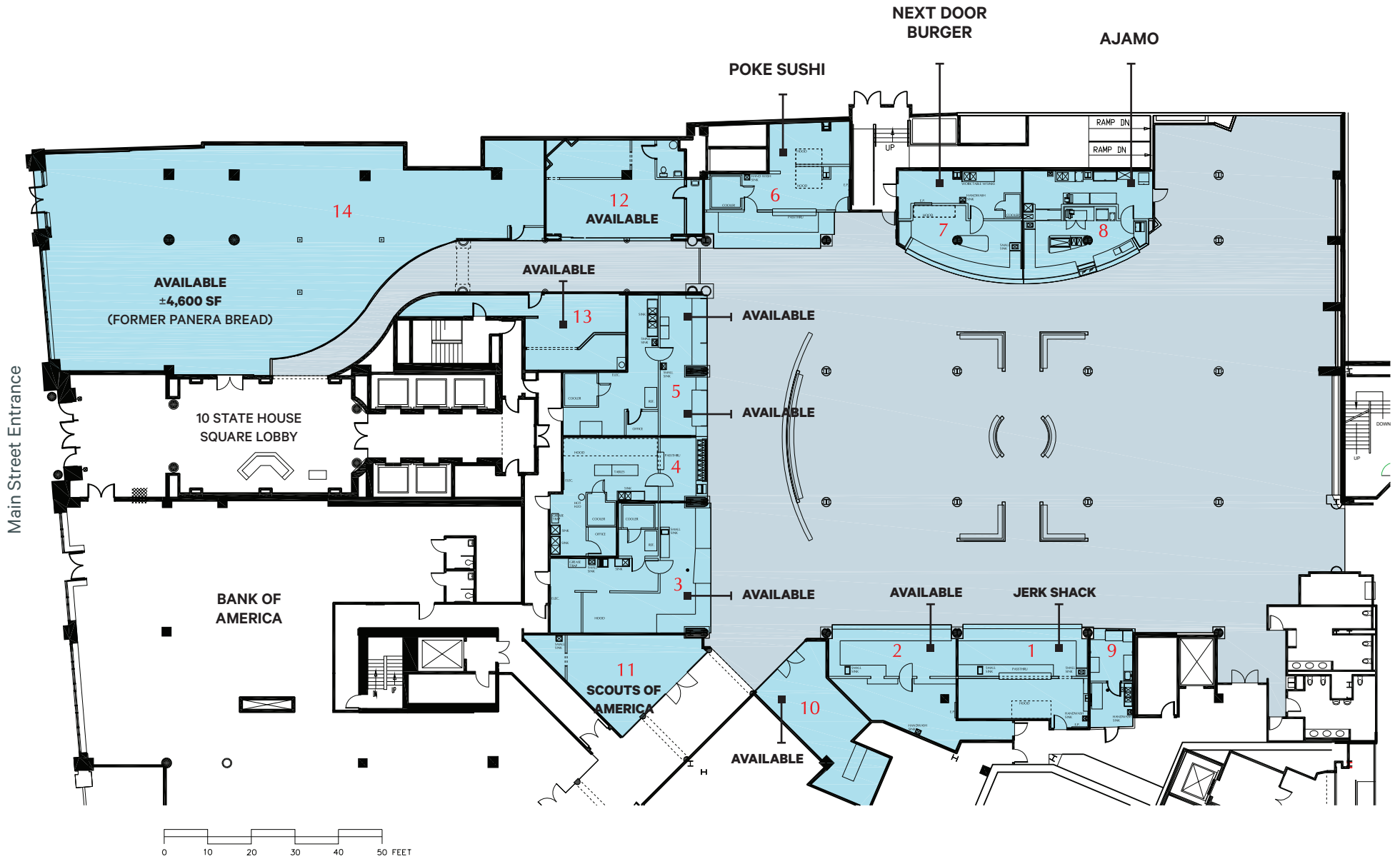

State House Square Plaza



## Contact Us

**John McCormick**  
Executive Vice President  
+1 860 987 4736  
john.mccormick@cbre.com

**Mike Puzzo**  
Senior Vice President  
+1 860 987 4705  
mike.puzzo@cbre.com

**CBRE Inc.**  
+1 860 525 9171

© 2025 CBRE, Inc. All rights reserved. This information has been obtained from sources believed reliable, but has not been verified for accuracy or completeness. You should conduct a careful, independent investigation of the property and verify all information. Any reliance on this information is solely at your own risk. CBRE and the CBRE logo are service marks of CBRE, Inc. All other marks displayed on this document are the property of their respective owners, and the use of such logos does not imply any affiliation with or endorsement of CBRE. Photos herein are the property of their respective owners. Use of these images without the express written consent of the owner is prohibited.