

SHERWOOD EXECUTIVE CENTER

5250 CLAREMONT AVE

STOCKTON, CA

FOR LEASE

477 RSF - 495 RSF OFFICE SUITES

ETHAN CONRAD

PROPERTIES INC.

NOW REMODELED

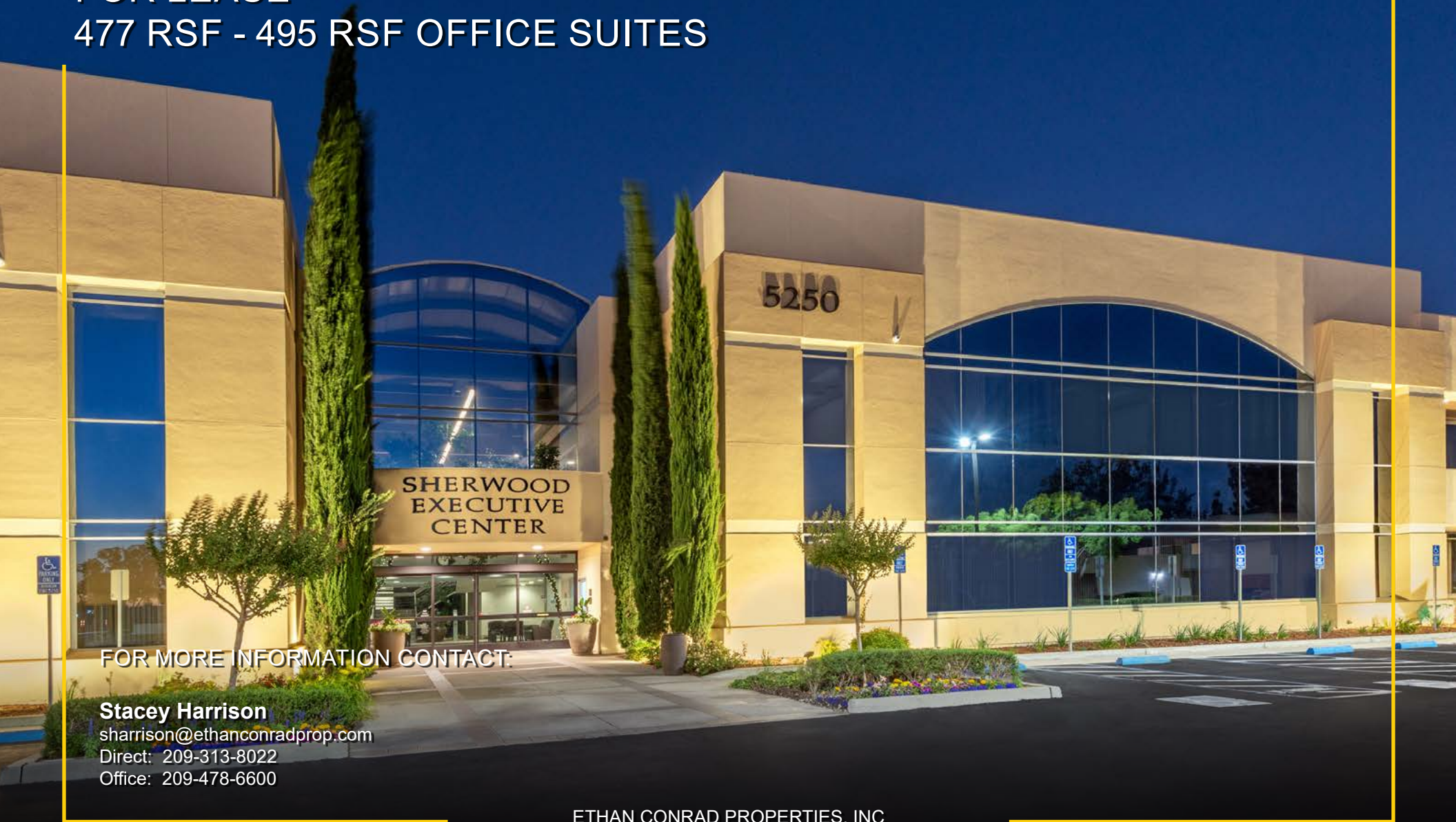

FOR MORE INFORMATION CONTACT:

Stacey Harrison

sharrison@ethanconradprop.com

Direct: 209-313-8022

Office: 209-478-6600

ETHAN CONRAD PROPERTIES, INC

1300 NATIONAL DRIVE, SUITE 100 | SACRAMENTO CA, 95834 | 916.779.1000

www.ethanconradprop.com

FEATURES:

- Executive full service suites, Executive Office services available (furnished suites available)
- Adjacent to Sherwood Mall and Weberstown Mall
- Large lobby with skylights and well-maintained flora through the building
- Minutes from I-5 freeway
- Conference and meeting rooms
- 5.5:1,000 SF parking ratio

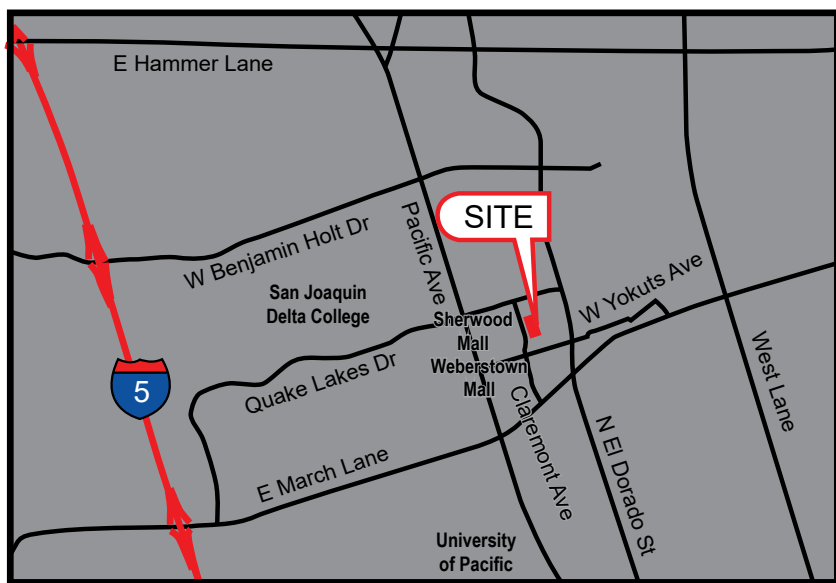

PROPERTY DETAILS:

Sherwood Executive Center, a 2-story, 54,084 RSF multi-tenant executive suite office building located in Stockton, CA. The property sits behind two of the major shopping malls in the region, Sherwood Mall and Weberstown Mall off Pacific Ave which is the major retail corridor in Stockton.

The area is a major hub in Stockton with many national tenants as well as two colleges: San Joaquin Delta College and University of Pacific.

LEASE RATES:

Please see additional pages for more information.



ETHAN CONRAD PROPERTIES, INC.

1300 NATIONAL DRIVE, SUITE 100 | SACRAMENTO CA, 95834 | 916.779.1000

www.ethanconradprop.com

1ST FLOOR

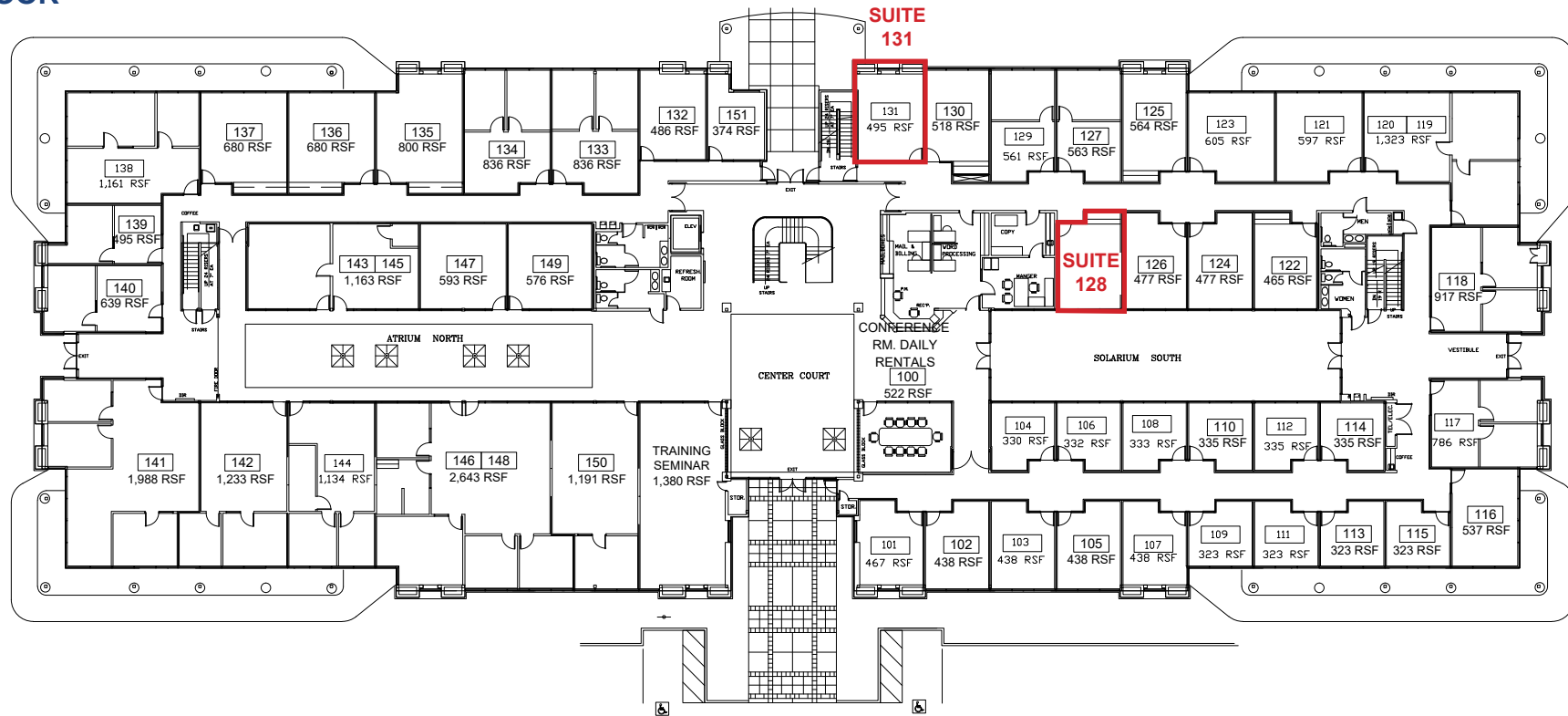

Suite	RSF	Lease Rates	Monthly Rent
128	477	\$2.05 PSF, FS	\$ 978.00
131	495	\$2.05 PSF, FS	\$1,015.00

ETHAN CONRAD PROPERTIES, INC.
 1300 NATIONAL DRIVE, SUITE 100 | SACRAMENTO CA, 95834 | 916.779.1000
www.ethanconradprop.com

The information contained herein has been obtained from sources we believe to be reliable. However, we cannot guarantee, warrant or represent its accuracy and all information is subject to error, change or withdrawal. An interested party and their advisors should conduct an independent investigation of the property to determine to your satisfaction the suitability of the property for your needs.

LOWER LEVEL

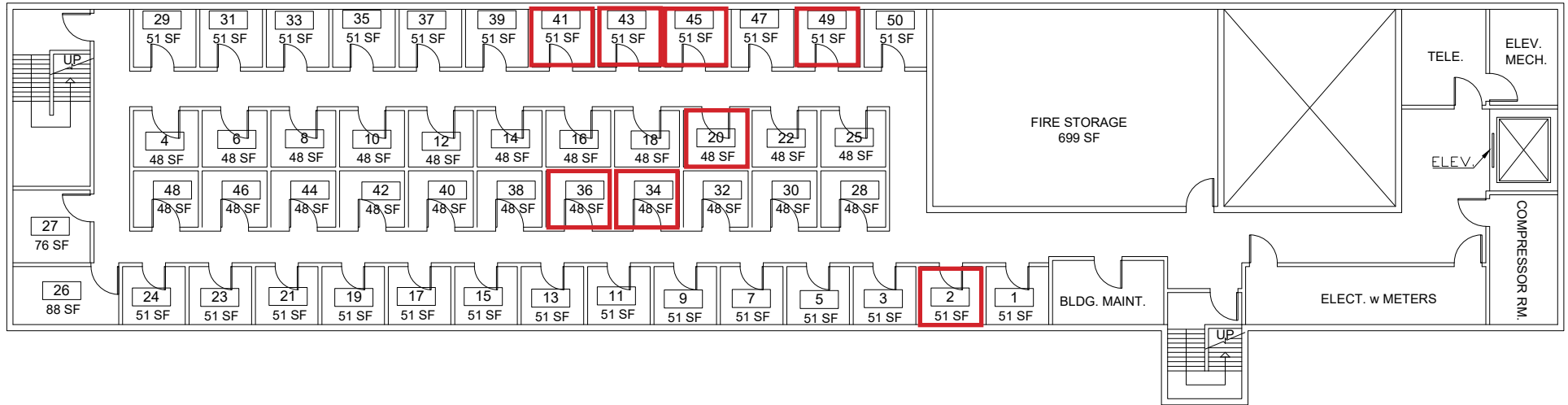

STORAGE ROOMS:
\$45.00 per month

ETHAN CONRAD PROPERTIES, INC.
1300 NATIONAL DRIVE, SUITE 100 | SACRAMENTO CA, 95834 | 916.779.1000
www.ethanconradprop.com

The information contained herein has been obtained from sources we believe to be reliable. However, we cannot guarantee, warrant or represent its accuracy and all information is subject to error, change or withdrawal. An interested party and their advisors should conduct an independent investigation of the property to determine to your satisfaction the suitability of the property for your needs.

SITE PLAN



The information contained herein has been obtained from sources we believe to be reliable. However, we cannot guarantee, warrant or represent its accuracy and all information is subject to error, change or withdrawal. An interested party and their advisors should conduct an independent investigation of the property to determine to your satisfaction the suitability of the property for your needs.

FOR LEASE

SHERWOOD EXECUTIVE CENTER
5250 CLAREMONT AVE
STOCKTON, CA



ETHAN CONRAD PROPERTIES, INC.

1300 NATIONAL DRIVE, SUITE 100 | SACRAMENTO CA, 95834 | 916.779.1000

www.ethanconradprop.com

The information contained herein has been obtained from sources we believe to be reliable. However, we cannot guarantee, warrant or represent its accuracy and all information is subject to error, change or withdrawal. An interested party and their advisors should conduct an independent investigation of the property to determine to your satisfaction the suitability of the property for your needs.

FOR LEASE

SHERWOOD EXECUTIVE CENTER
5250 CLAREMONT AVE
STOCKTON, CA



ETHAN CONRAD PROPERTIES, INC.

1300 NATIONAL DRIVE, SUITE 100 | SACRAMENTO CA, 95834 | 916.779.1000

www.ethanconradprop.com

The information contained herein has been obtained from sources we believe to be reliable. However, we cannot guarantee, warrant or represent its accuracy and all information is subject to error, change or withdrawal. An interested party and their advisors should conduct an independent investigation of the property to determine to your satisfaction the suitability of the property for your needs.