

FIRST PALM SPRINGS LOGISTICS PARK- BLDG 2

Developed by  **FIRST**
INDUSTRIAL
REALTY-TRUST

19th Ave, Palm Springs, CA 92258



391,077 SF
FOR LEASE



Kevin McKenna
Vice Chair
Lic. 00887289
949 300 0084
Kevin.McKenna@colliers.com

Greg Merrill
Associate Vice President
Lic. 01906709
909 937 6361
Greg.Merrill@colliers.com



PROPERTY FEATURES

40'

Warehouse Clearance at
First Column

10,000SF

Two-Story Office Space

46

Dock-High Doors (9'x10')

60

Trailer Stalls (12'x53')

4,000

Amps 277/480 Volt 3-Phase

2

Ground-Level Doors (12'x16')

185'

Secured All-Concrete
Truck Court

9"

Flat, Reinforced Slab

ESFR

Sprinkler System

275

Auto Parking Spaces

Warehouse

Lighting to Suit

56'x60'

Typical Column Spacing



CORPORATE NEIGHBORS



SHEIN



SITE PLAN

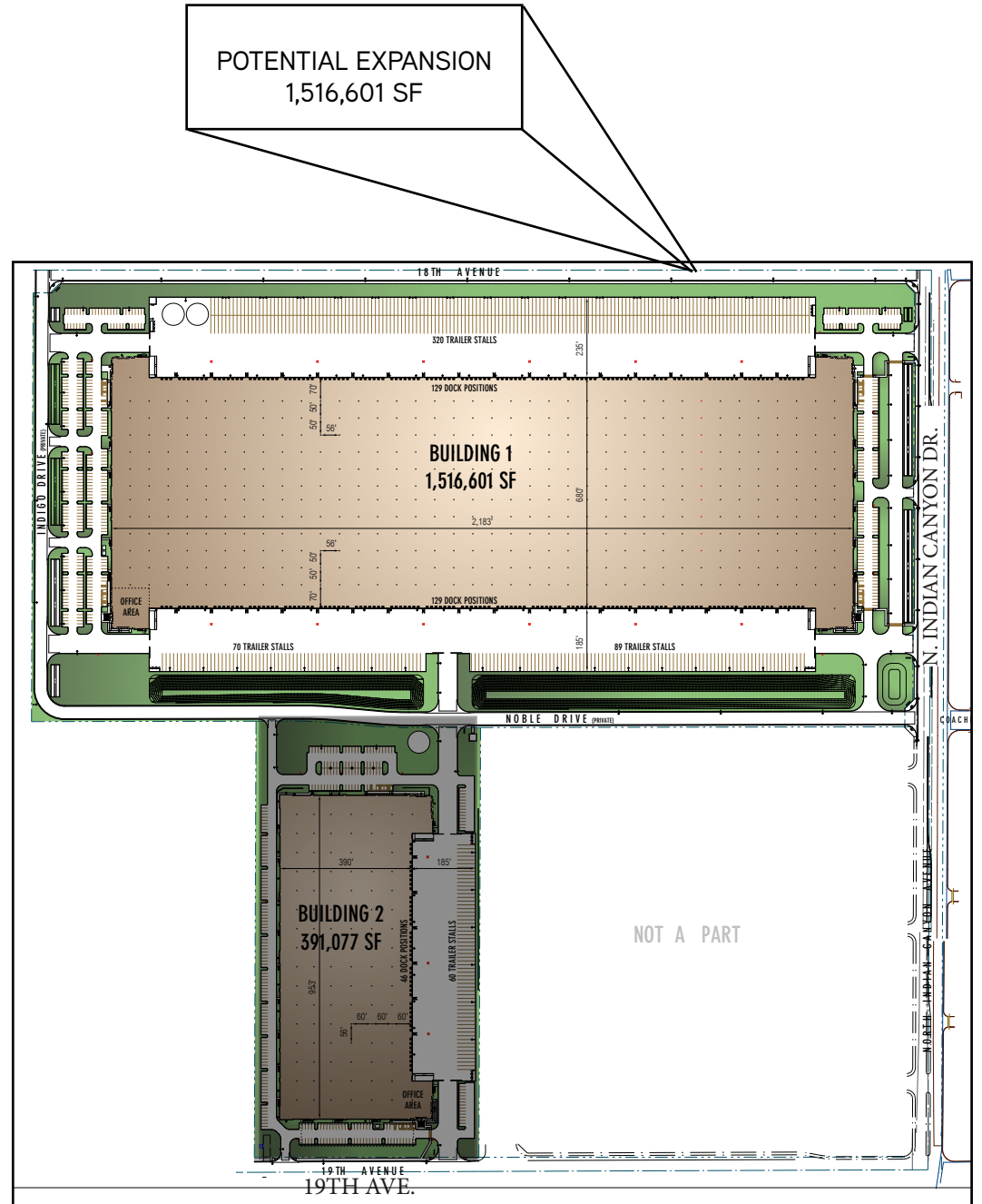
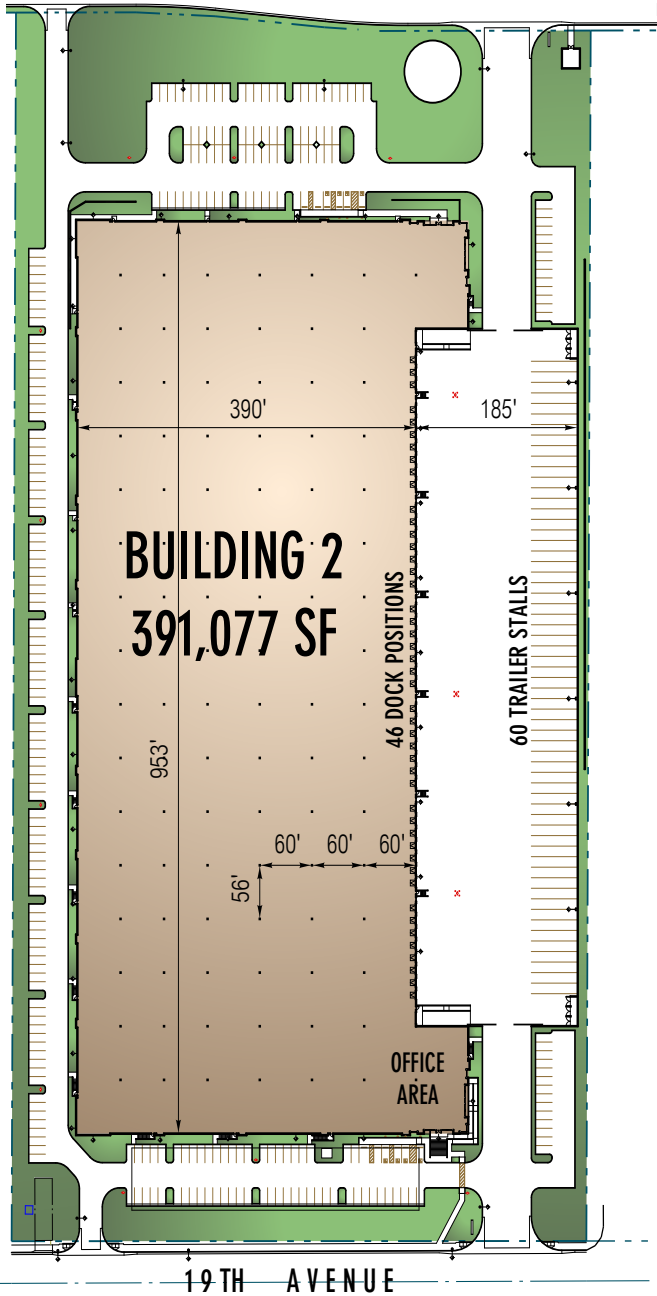

SOUTHERN CALIFORNIA LOGISTICS NETWORK

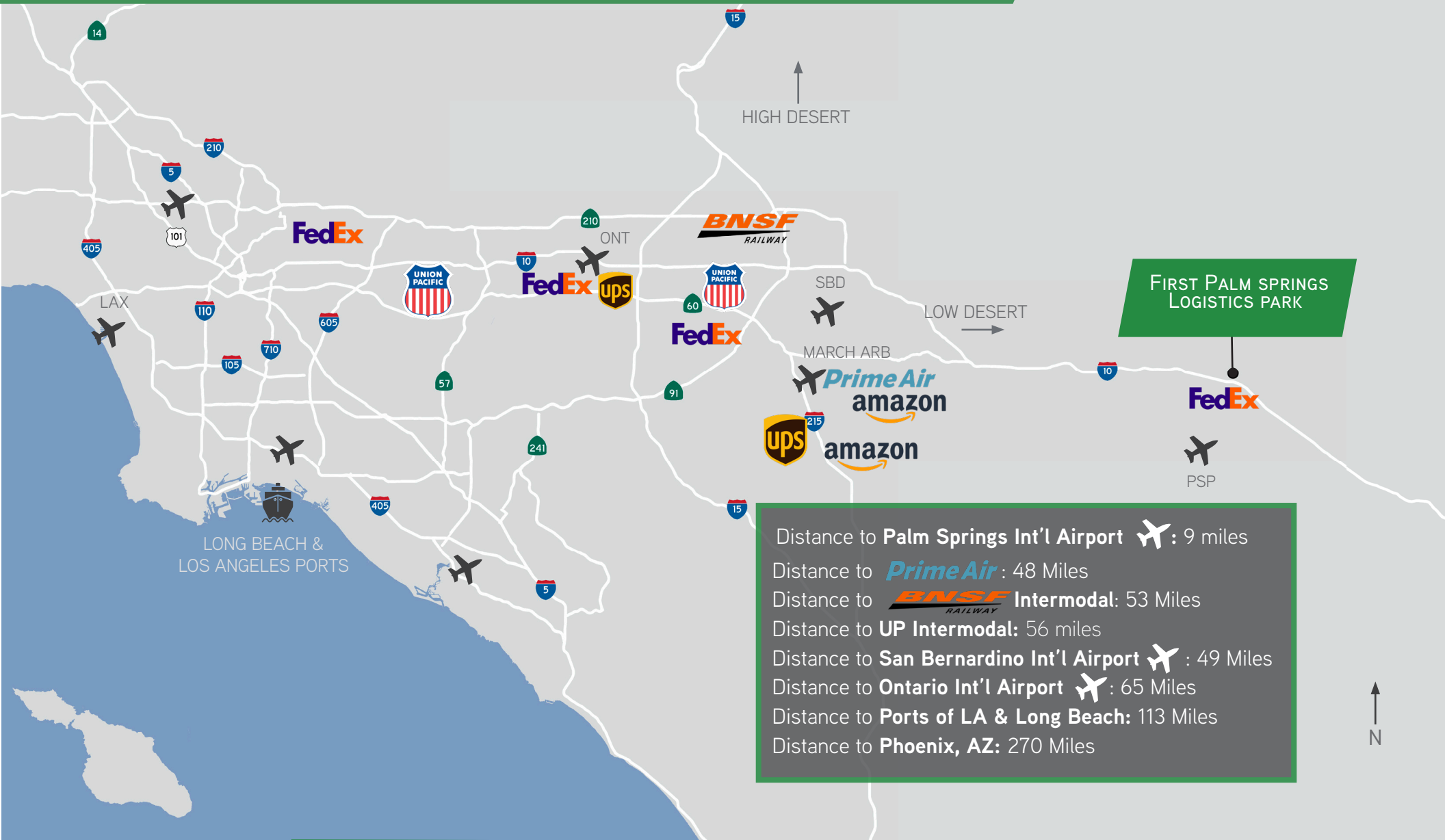

FIRST PALM SPRINGS LOGISTICS PARK

- Distance to **Palm Springs Int'l Airport** ✈️ : 9 miles
- Distance to **Prime Air** : 48 Miles
- Distance to **BNSF Railway Intermodal**: 53 Miles
- Distance to **UP Intermodal**: 56 miles
- Distance to **San Bernardino Int'l Airport** ✈️ : 49 Miles
- Distance to **Ontario Int'l Airport** ✈️ : 65 Miles
- Distance to **Ports of LA & Long Beach**: 113 Miles
- Distance to **Phoenix, AZ**: 270 Miles

