

# 4007 WESTFAX DRIVE

Chantilly, VA 20151

Industrial For Lease

5,380 SF



Leasing Information:  
703.522.4600

**Eamon McCrann**   **Jack Pezzulla**  
703.284.5861   703.284.5864  
emccrann@lpc.com   jpezzulla@lpc.com

# Lincoln

1530 Wilson Boulevard  
Suite 200  
Arlington, VA 22209

[www.lpc.com](http://www.lpc.com)

# 4007 WESTFAX DRIVE

Chantilly, VA 20151

Industrial For Lease

5,380 SF

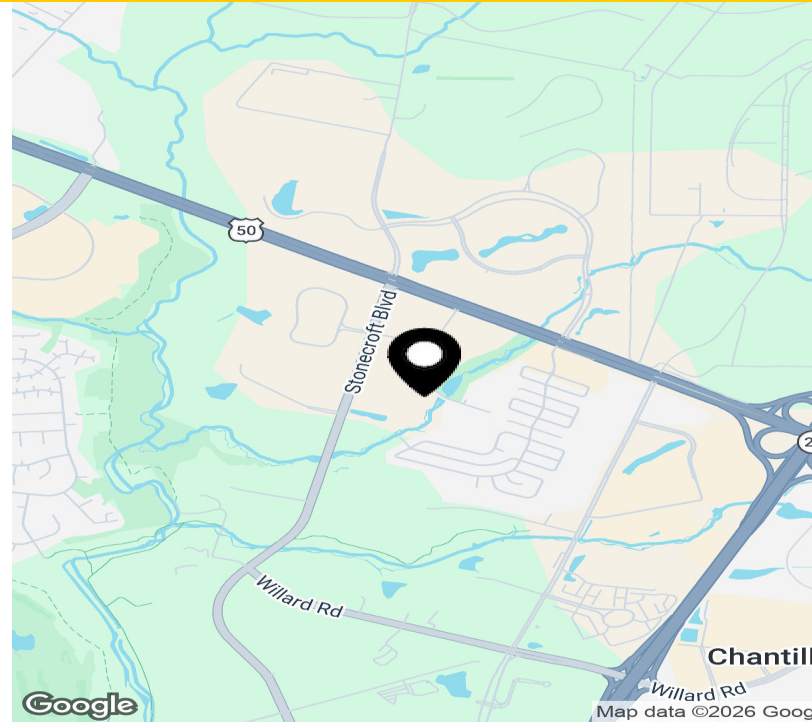

## Property Highlights

- Convenient location
- Great for plug 'n play auto-use
- Natural light-filled interiors
- Professional property management

## Availabilities

4007AB

## SF

5,380 SF

## Lease Rate

Negotiable

## Date Available

Immediately

**Eamon McCrann**

703.284.5861  
emccrann@lpc.com

**Jack Pezzulla**

703.284.5864  
jpezzulla@lpc.com

**Lincoln**

# 4007 WESTFAX DRIVE

Chantilly, VA 20151

**4007AB**

5,380 SF

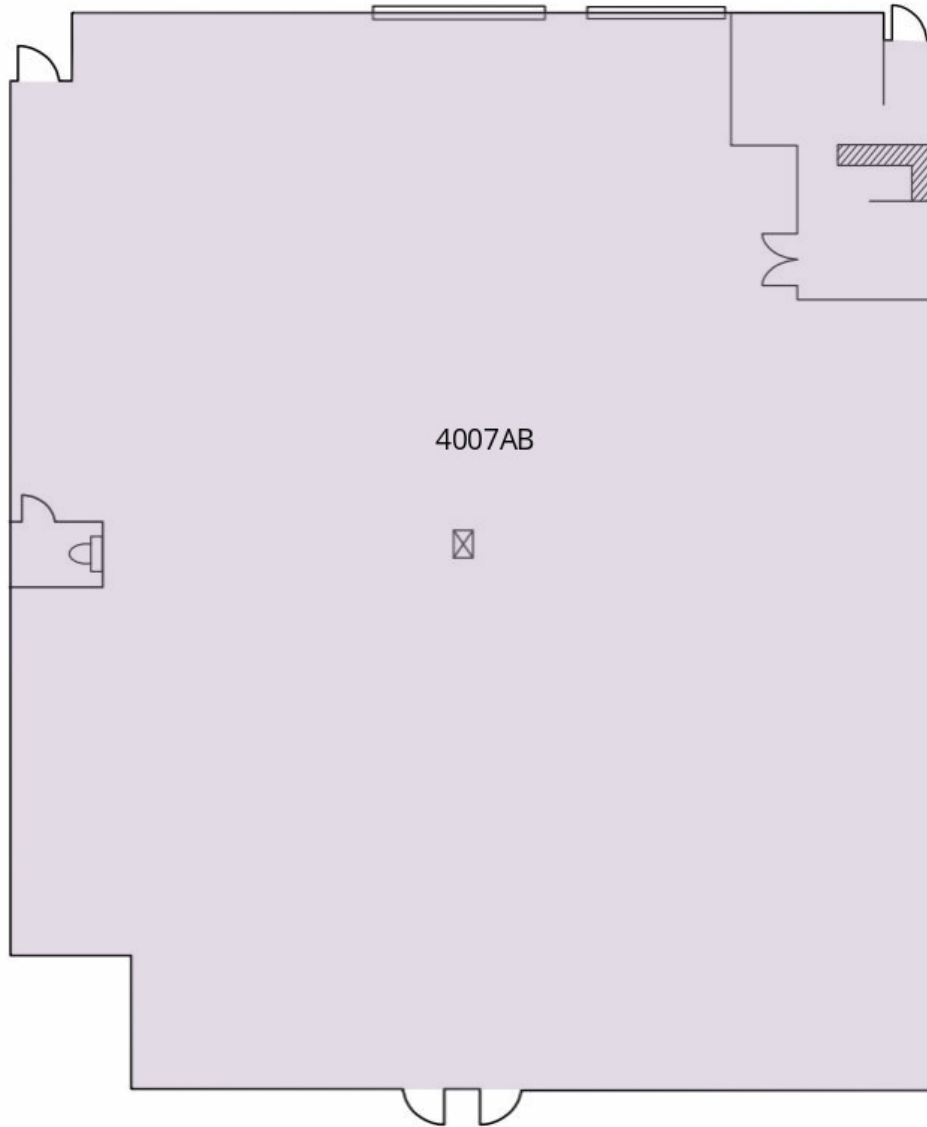

4007AB



Suite	Size	Lease Rate	Description
■ 4007AB	5,380 SF	Negotiable	Currently built out for auto-use. 2 drive-in loading doors. Reception area w/ front desk. Small office. 1 bathroom. Prior tenant willing to sell the majority of their equipment (incl. 8 auto lifts).

**Eamon McCrann**    **Jack Pezulla**  
703.284.5861        703.284.5864  
emccrann@lpc.com    jpezulla@lpc.com

**Lincoln**

# 4007 WESTFAX DRIVE

Chantilly, VA 20151

Map

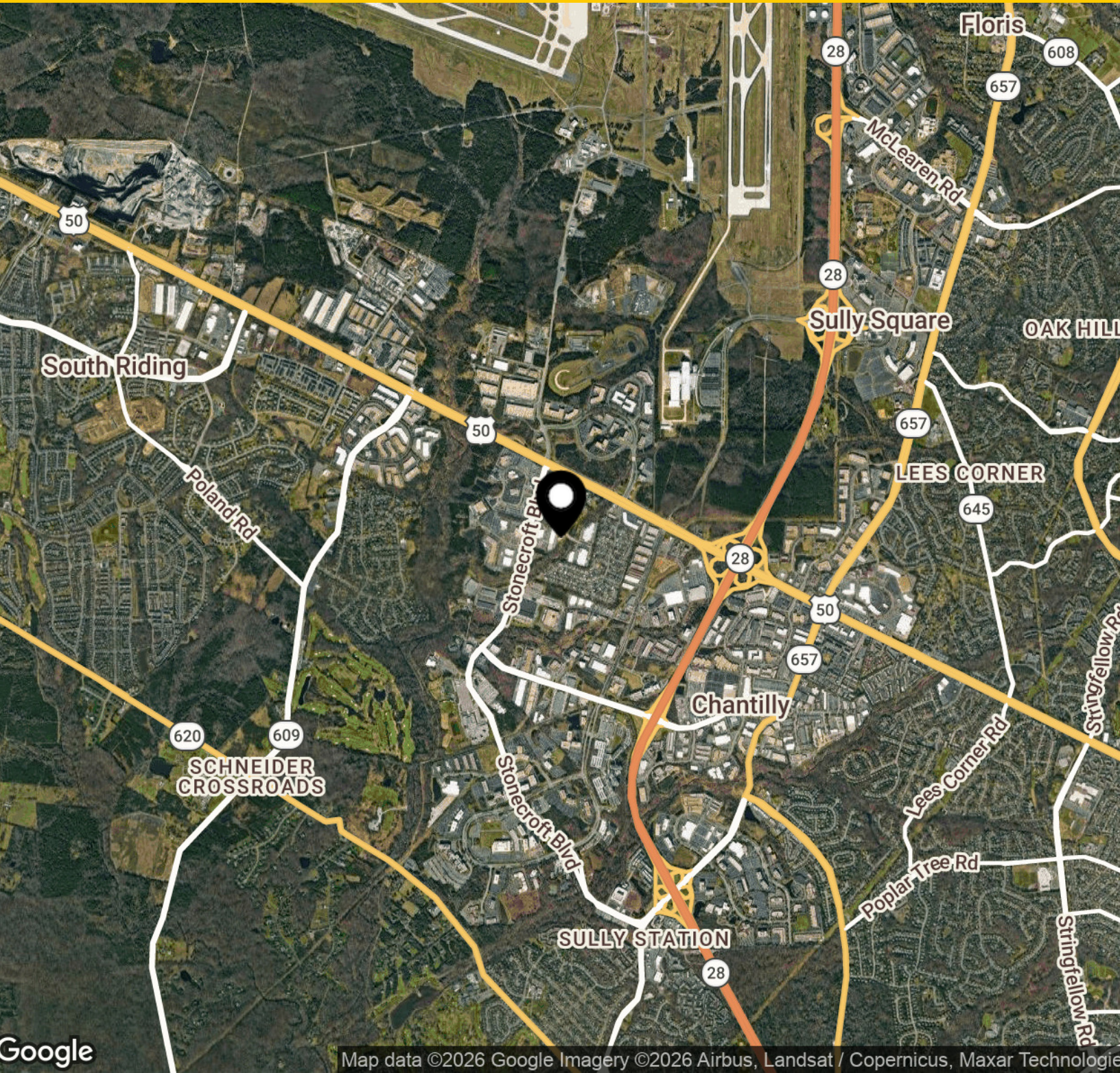

Eamon McCrann

703.284.5861

emccrann@lpc.com

Jack Pezulla

703.284.5864

jpezulla@lpc.com

Lincoln



# 4007 WESTFAX DRIVE

Chantilly, VA 20151

Leasing Information:  
703.522.4600

**Eamon McCrann**  
703.284.5861  
emccrann@lpc.com

**Jack Pezzulla**  
703.284.5864  
jpezzulla@lpc.com

## Lincoln

1530 Wilson Boulevard  
Suite 200  
Arlington, VA 22209

[www.lpc.com](http://www.lpc.com)