



> FOR LEASE - INDUSTRIAL SPACE

4604 62 Avenue
LLYODMINSTER, AB

MAREENA BOBEY
VP OPERATIONS
780.430.0529
EDMONTON, AB
mareena.bobey@camgill.com

CAMGILL DEVELOPMENT CORP
102, 9830 42 Avenue
Edmonton, AB T6E 5V5
Main: 780.430.0529
www.camgill.com



Building Features

- Main floor office, second floor office, and shop area
- Demisable into smaller bays
- 3 phase 4 wire 600/347 V power
- Bridge and jib cranes
- Fenced yard
- Located in Hill Industrial Park, an established and expanding industrial park on the City's west edge
- Close proximity to Highway 16, the main commercial arterial for the City of Lloydminster

Premises

Size: Approx. 32,232 square feet
Demisable into smaller bays

Lease Rate: Market

Tenant Improvement: Negotiable

Op Costs: To be determined

Zoning: I2- Medium Industrial

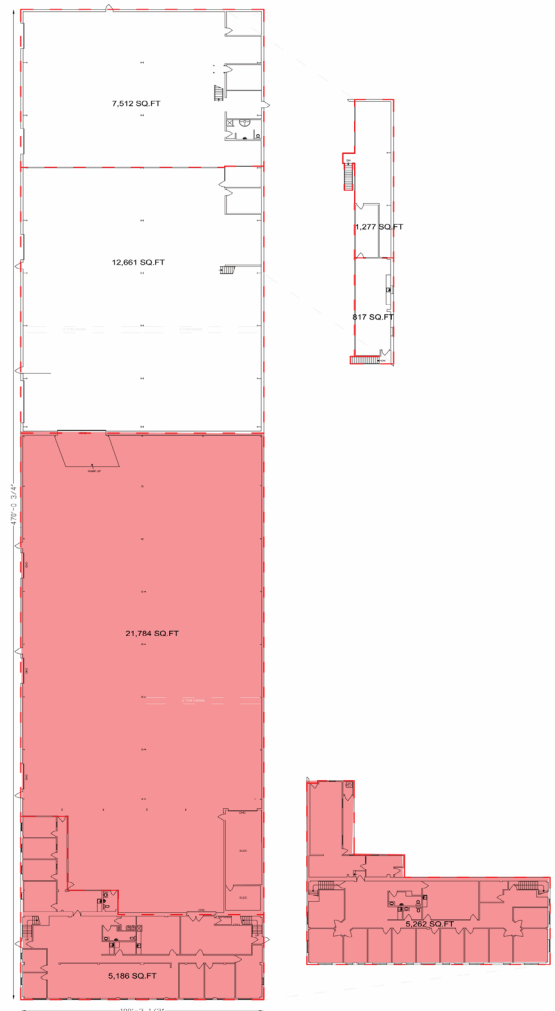

MAREENA BOBEY
VP OPERATIONS
780.430.0529
EDMONTON, AB
mareena.bobey@camgill.com

CAMGILL DEVELOPMENT CORP
102, 9830 42 Avenue
Edmonton, AB T6E 5V5
Main: 780.430.0529
www.camgill.com