



CBRE



Sacramento's Flagship Life Science Hub

THE BRIDGE DISTRICT
38 N. 121 W
SACRAMENTO

BIO- SPACE

AT THE BRIDGE DISTRICT

1.4M SF
CLASS A PURPOSE-
BUILT CAMPUS
Phase I ±430,000 SQ. FT.

Phase I Highlights



±430K
Square Feet



2
Buildings



5
Stories



Established and localized sponsorship in Blue Rise Ventures and Fulcrum Property



Join one of the nation's burgeoning life science clusters with a top national science & agricultural program at UC Davis



Located ~10 minutes from UC Davis Health's Sacramento campus and the recently launched Aggie Square mixed-use Innovation District



Purpose-built buildings & infrastructure meticulously designed to meet the needs of today's lab users



Long term potential to expand into multiple future phases



Research ready, Day-1 & Beyond

Property Characteristics



~125 Lbs/SF
Live Loads



Emergency Power



6,000 Micro-Inches
Per Second Vibration
Tolerance



Premier Amenity
Package



16' To 18' Slab-To-Slab
Heights



Dedicated Shipping
& Receiving



33' Column Bays



5,000 Lbs. Capacity
Freight Elevator



Efficient 43-47K SF
Floor Plates



2,000 SF Dedicated
Storage & Laydown Area



Abundant Primary
Power



Service Yard



Comprehensive HVAC
System 1.5 CFM/SF



Scientific roots for sustainable growth

ESG/Sustainability Measures

- **Locally sourced & manufactured** materials minimize ecological impact
- 70% cement replacement in concrete structure
- **Efficient construction methods** – offsite prefabricated structure for faster assembly
- Building massing for self-shading of outdoor space
- Native and adapted plant species
- Stormwater retention & filtration
- Effort to minimize **non-electric usage**
- Maximize natural light and ventilation - **100' wide floor plate** allows natural lighting in 100% of lab and office space

Facility Amenities

GROUND LEVEL

Phase 1

- Tenant Space
- Tenant Storage
- Commercial Test Kitchen
- Conference Suites
- Gym & Peloton Bike Studio
- Bike Storage



Representative Floor Plans

BUILDING I: ±43,000 RSF
BUILDING II: ±47,000 RSF

LEVELS 2 - 4
Multi-Tenant floor plan

**Tenant Space assumed to be 60/40 Lab/Office Space*

- Lab
- Lab/Lab Support
- Office
- Lobby



Representative Floor Plans

BUILDING I: ±43,000 RSF
BUILDING II: ±47,000 RSF

LEVEL 5
Single-Tenant floor plan

**Tenant Space assumed to be 60/40 Lab/Office Space*

- Lab
- Lab/Lab Support
- Office
- Lobby

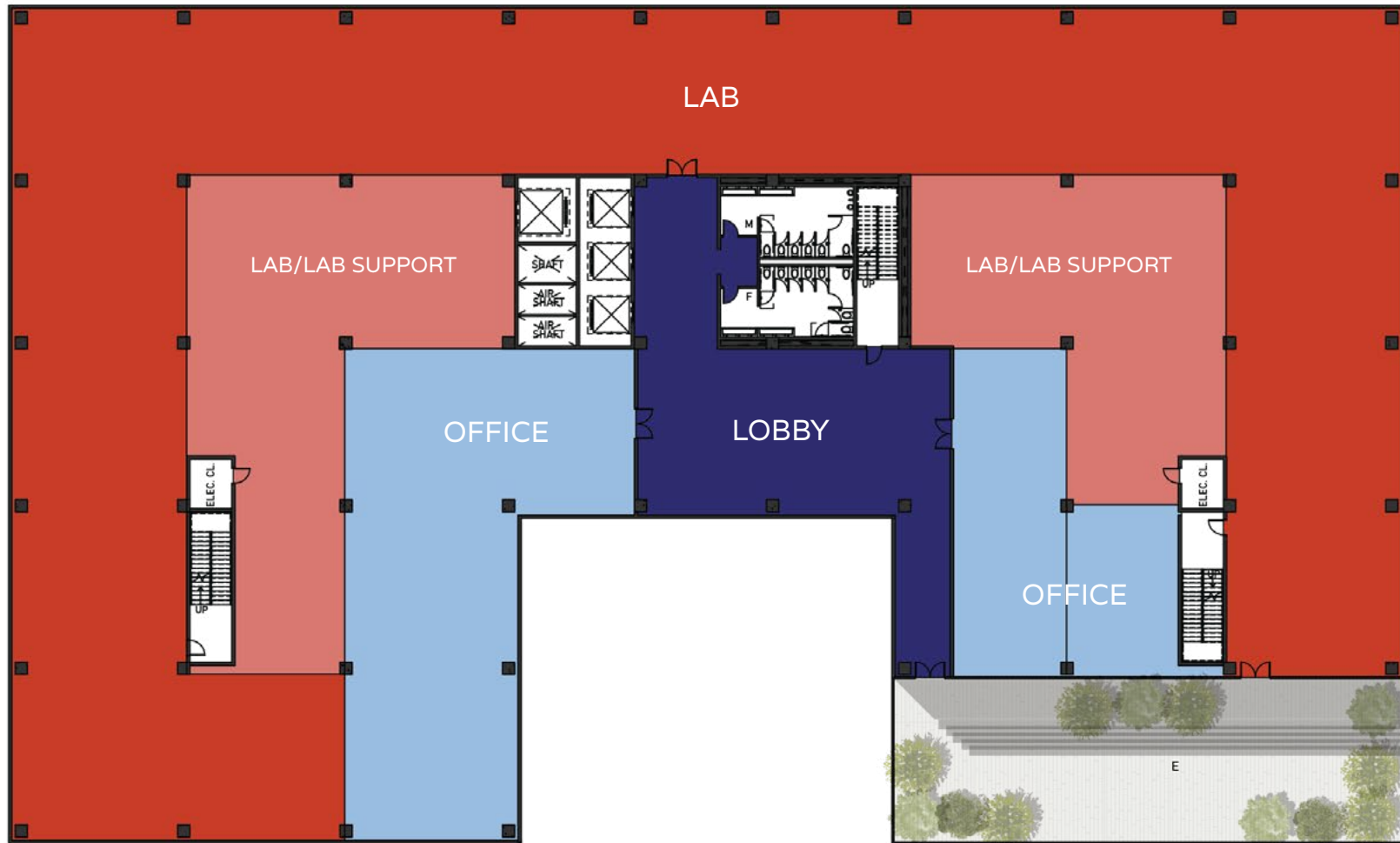

Representative Floor Plans

BUILDING I: ±43,000 RSF
BUILDING II: ±47,000 RSF

LEVEL 2
Single-Tenant floor plan

**Tenant Space assumed to be 60/40 Lab/Office Space*

- Lab
- Lab/Lab Support
- Office
- Lobby

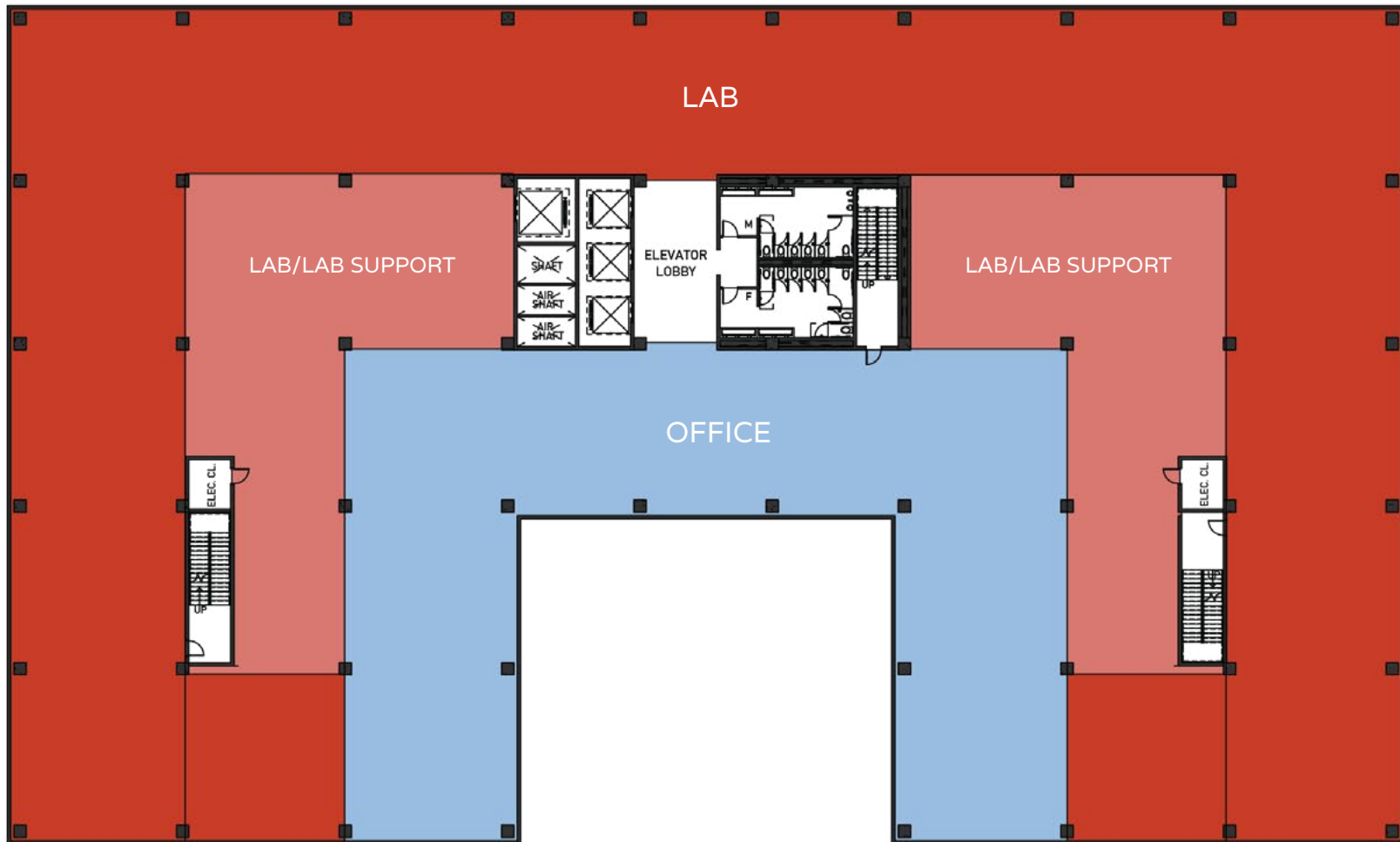

Life @ The Bridge District

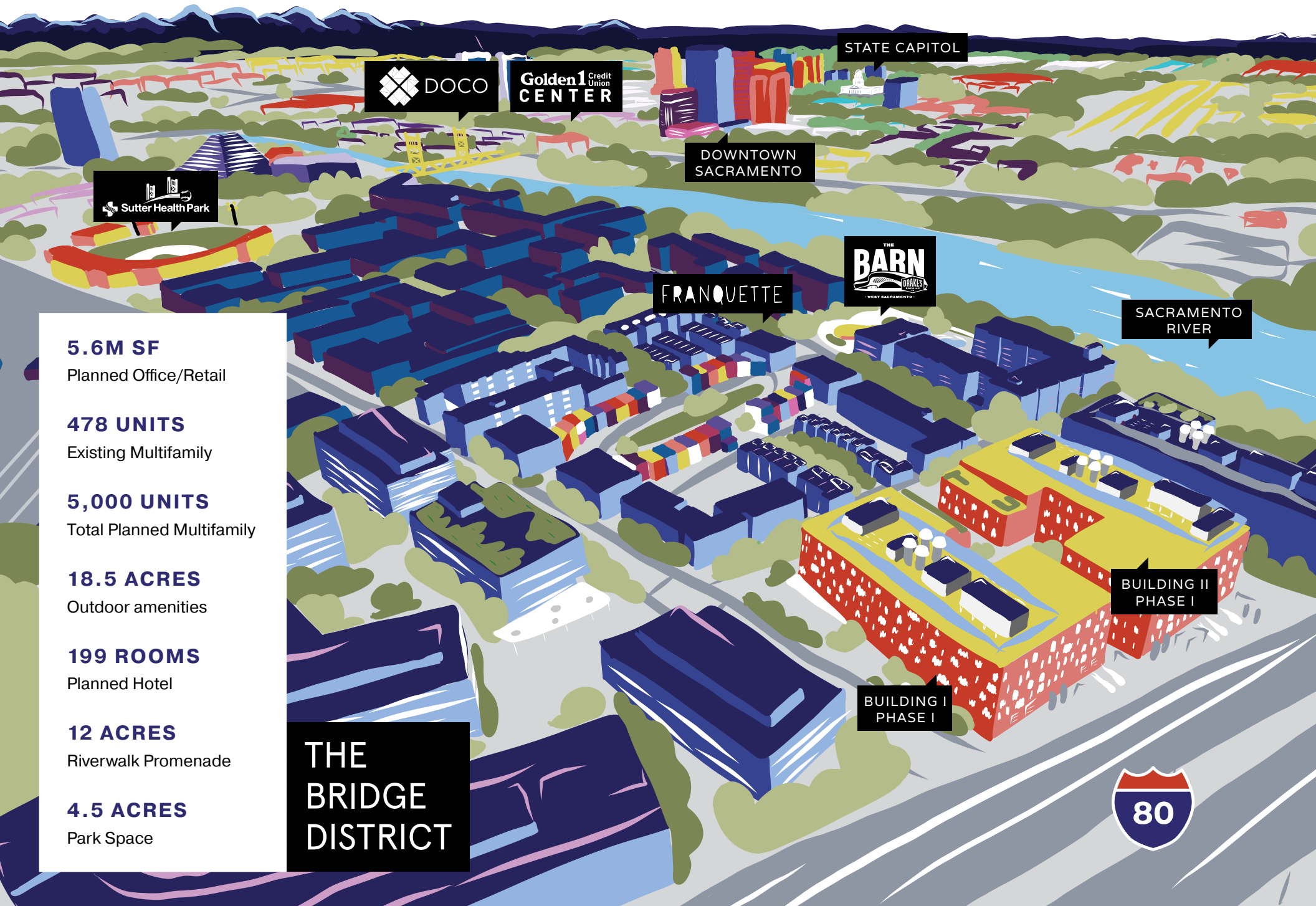

5.6M SF

Planned Office/Retail

478 UNITS

Existing Multifamily

5,000 UNITS

Total Planned Multifamily

18.5 ACRES

Outdoor amenities

199 ROOMS

Planned Hotel

12 ACRES

Riverwalk Promenade

4.5 ACRES

Park Space

**THE
BRIDGE
DISTRICT**



BIO_ SPACE

AT THE BRIDGE DISTRICT

MARK J. KOL

Executive Vice President

Mark.Kol@cbre.com

T 510 874 1992

Lic. 01251158

NELLIE CRUZ

Vice President

Nellie.Cruz@cbre.com

T 916 492 6915

Lic. 02086140

EVAN CHANG

Vice President

Evan.Chang@cbre.com

T 650 577 2962

Lic. 02010044



FULCRUM



BLUE RISE
VENTURES

CBRE

© 2025 CBRE, Inc. All rights reserved. This information has been obtained from sources believed reliable, but has not been verified for accuracy or completeness. You should conduct a careful, independent investigation of the property and verify all information. Any reliance on this information is solely at your own risk. CBRE and the CBRE logo are service marks of CBRE, Inc. All other marks displayed on this document are the property of their respective owners, and the use of such logos does not imply any affiliation with or endorsement of CBRE. Photos herein are the property of their respective owners. Use of these images without the express written consent of the owner is prohibited.