

THE CHESTNUT

AT UNIVERSITY CITY



3720 CHESTNUT STREET
PHILDELPHIA, PA

±2,982 SF & ±1,149 SF
RETAIL/RESTAURANT
OPPORTUNITIES

Get in touch

IRYNA IRYK

Office 215.893.0300

Direct 215.282.0156

iiryk@metrocommercial.com



METRO[®]
COMMERCIAL



**CUSHMAN &
WAKEFIELD**



CHESTNUT STREET VIEW



SANSOM STREET VIEW

SPACES

- SPACE A: $\pm 2,982$ SF facing Chestnut Street
- SPACE B: $\pm 1,149$ SF facing Sansom Street

HIGHLIGHTS

- Situated at the base of a stunning 405-unit, 29-story luxury residential tower, The Chestnut
- Strategically located within the retail and restaurant hub of University City
- An unparalleled captured audience comprised of nearly 44,000 students and over 75,000 workers
- Outdoor patio seating available



DEMOGRAPHICS

*1 MILE RADIUS: ESRI 2021

58,292

Population

20,942

Households

\$62,281

Avg. Household Income

\$390,677

Avg. Home Value

24.4

Median Age

2,056

Total Businesses

66,294

Total Employees

91,832

Daytime Population

DENSITY MAP

APARTMENTS

- 1 Hamilton Court Apartments (110 Units)
- 2 The Radian (154 Units)
- 3 Chestnut Hall (315 Units)
- 4 Domus (290 Units)
- 5 Next LVL (281 Units)
- 6 The Mason on Chestnut (409 Units)
- 7 evo at Cira Centre South (850 Units)
- 8 The Chestnut (405 Units)
- 9 Arrive University City (363 Units)
- 10 Vue32 (170 Units)
- 11 AKA University City (181 Units)
- 12 ANOVA uCity Square (461 Units)
- 13 Korman Residential at 3737 Chestnut (276 Units)
- 14 The HUB on Chestnut (101 Units)
- 15 The Left Bank Apartments (282 Units)

EDUCATION/ MEDICAL

- 16 University of Pennsylvania
- 17 Drexel University
- 18 University of Sciences
- 19 Hospital of the University of Pennsylvania
- 20 Children's Hospital of Philadelphia

OFFICE

- 21 uCity Square (7,000,000 sq ft)
- 22 Schuylkill Yards (6,832,000 sq ft)
- 23 Cira Centre (730,187 sq ft)
- 24 FMC Tower at Cira Centre South (625,863 sq ft)



The information and images contained herein are from sources deemed reliable. However, Metro Commercial Real Estate, Inc. makes no representation whatsoever as to their accuracy or authenticity. Images shown may be modified for illustrative purposes. Images may be out-of-date and not current. 7.14.22



THE CHESTNUT
3720 CHESTNUT STREET, PHILDELPHIA, PA



www.metrocommercial.com

RETAIL & DINING MAP

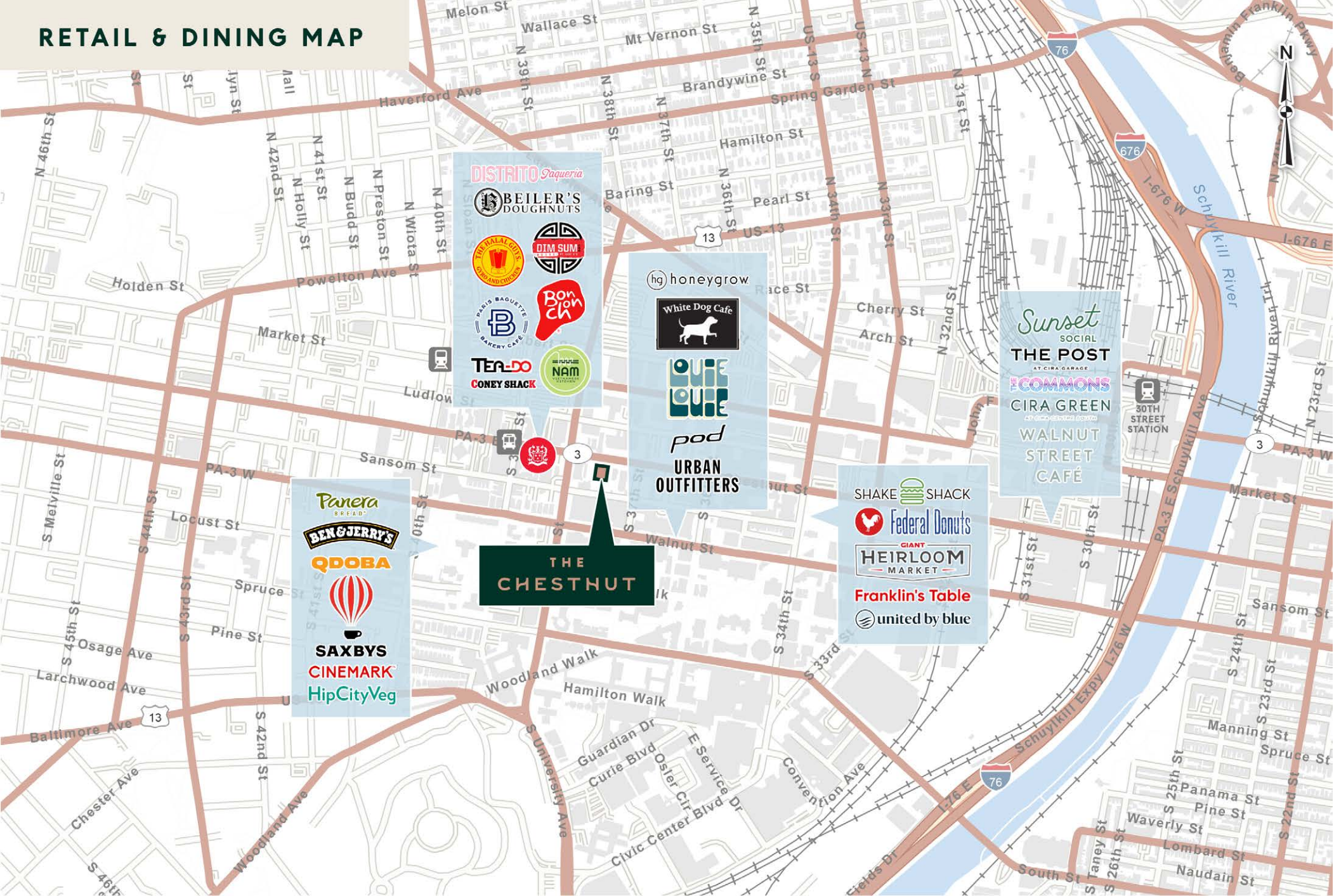

The information and images contained herein are from sources deemed reliable. However, Metro Commercial Real Estate, Inc. makes no representation whatsoever as to their accuracy or authenticity. Images shown may be modified for illustrative purposes. Images may be out-of-date and not current. 7.14.22



THE CHESTNUT
3720 CHESTNUT STREET, PHILDELPHIA, PA



www.metrocommercial.com

SITE PLAN

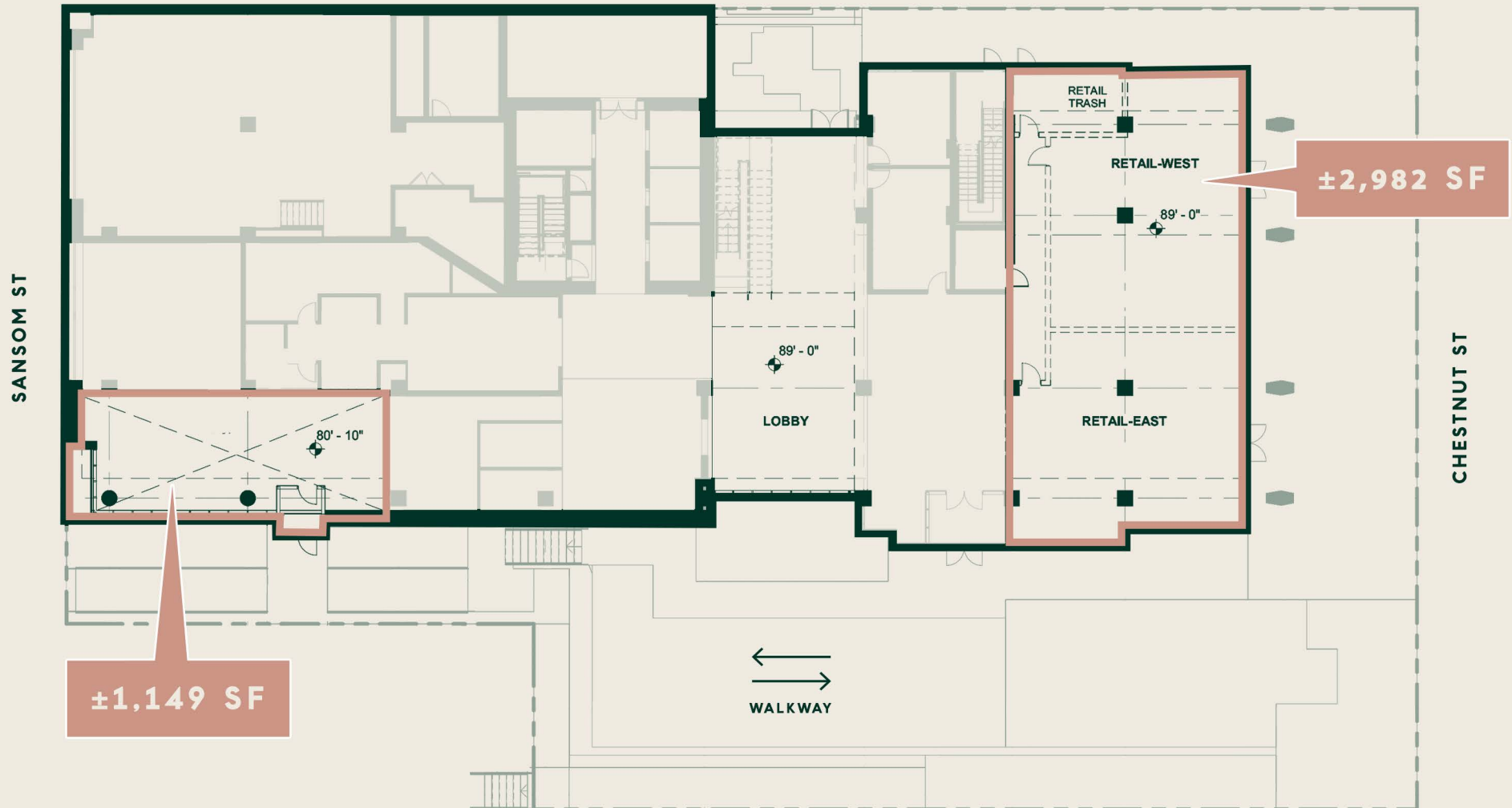

The information and images contained herein are from sources deemed reliable. However, Metro Commercial Real Estate, Inc. makes no representation whatsoever as to their accuracy or authenticity. Images shown may be modified for illustrative purposes. Images may be out-of-date and not current. 7.14.22



THE CHESTNUT
3720 CHESTNUT STREET, PHILDELPHIA, PA



www.metrocommercial.com

THE CHESTNUT

AT UNIVERSITY CITY



METRO[®]
COMMERCIAL



**CUSHMAN &
WAKEFIELD**



PENNSYLVANIA OFFICE

660 West Germantown Pike
Suite LL 200

Plymouth Meeting, PA 19462

PHONE 610.825.5222

NEW JERSEY OFFICE

307 Fellowship Road
Suite 300

Mount Laurel, NJ 08054

PHONE 856.866.1900

FLORIDA OFFICE

703 Waterford Way
Suite 800

Miami, FL 33126

PHONE 786.388.6470

METROCOMMERCIAL.COM