

# 6TH FLOOR

Suite	650
Size (RSF)	3,244
Date Available	Now

Second generation space

\*\*Can be combined with Suite 600 for a total of 11,437 RSF.

ONE  
POST

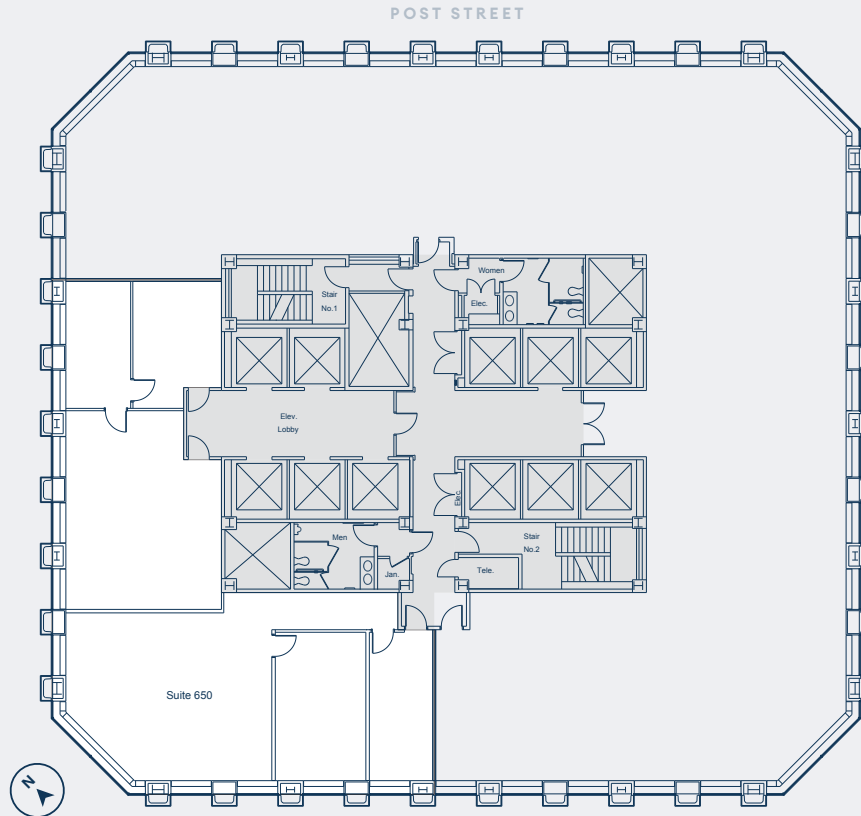

**MATTHEW SHEWEY**  
Senior Managing Director

415.395.7255  
matt.shewey@jll.com  
# License 0144515

**JAK CHURTON**  
Managing Director

415.395.7292  
jak.churton@jll.com  
# License 0127724

**CHARLIE HANAFIN**  
Senior Vice President

415.395.4951  
charlie.hanafin@jll.com  
# License 01856260

**CHRISTOPHER T. ROEDER**  
Vice Chairman

415.395.4971  
chris.roeder@jll.com  
# License 01190523

**JLL** | **Brookfield**  
Properties

Jones Lang LaSalle Americas, Inc.  
Real Estate License # 01223413