



For Lease/Sale

Retail/Light Industrial

+/- 26,628 SF

611 Union Blvd
Totowa, NJ

Property specifications

Available	26,628 SF
Office/showroom	5,348 SF
Ceiling Height	12'8"-18'6"
Docks	2 drive-ins
Parking	21 spaces
Floors	Sealed
Power	800 amps/240 volts/3 phase
Building Improvements	<ul style="list-style-type: none"> • New LED lighting • New windows and doors • New bathrooms • New kitchen • New HVAC systems • New epoxy floors • New building exterior
Proposed Uses	<ul style="list-style-type: none"> • Retail stores • Light industrial uses to include wholesale supply and storage • Service establishment • Banks and other financial institutions

Howard Weinberg, SIOR
Broker-Salesperson, Managing Director, Northeast
Industrial Region
+1 973 829 4727
howard.weinberg@jll.com

jll.com





Site Plan

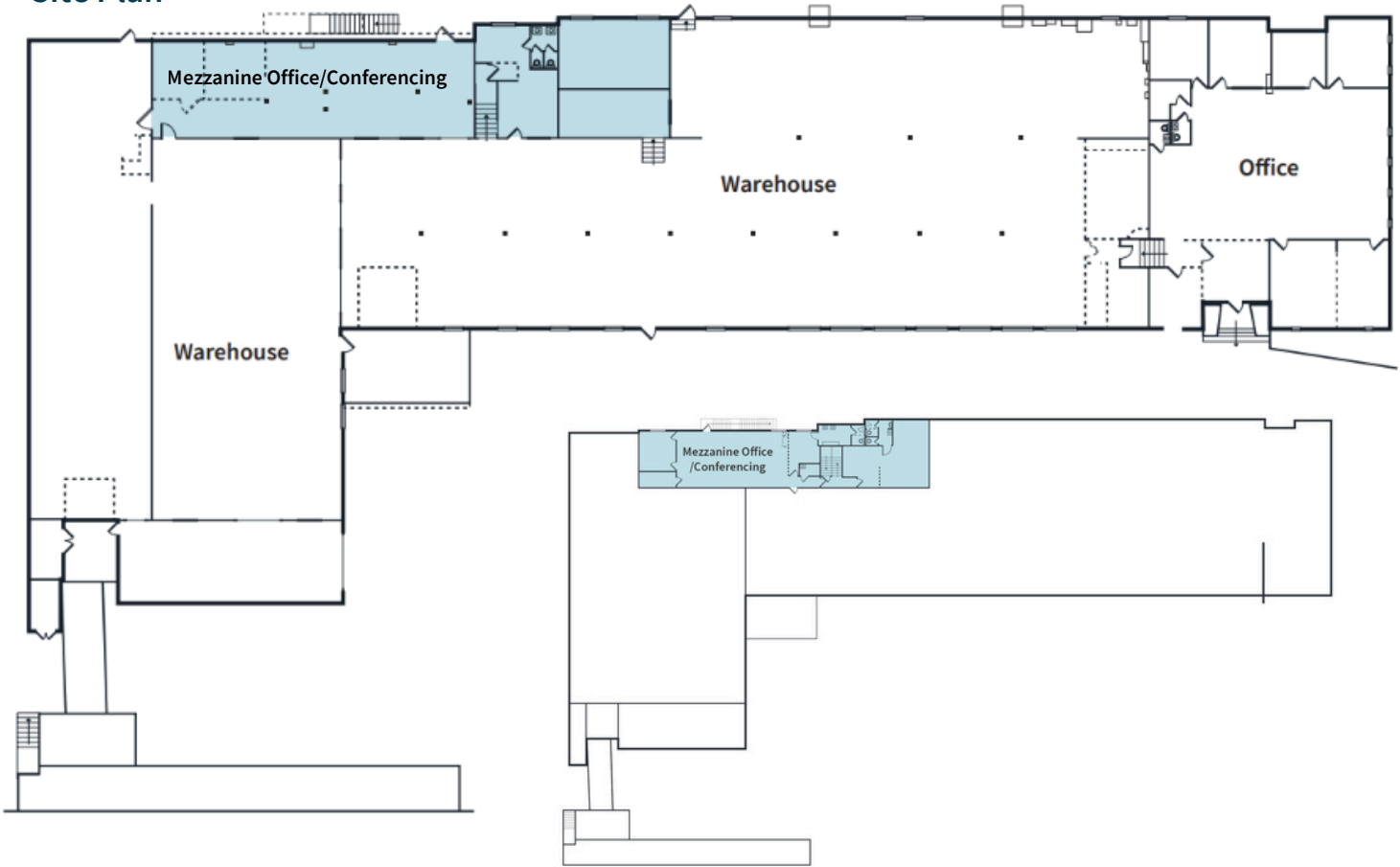

Location Map

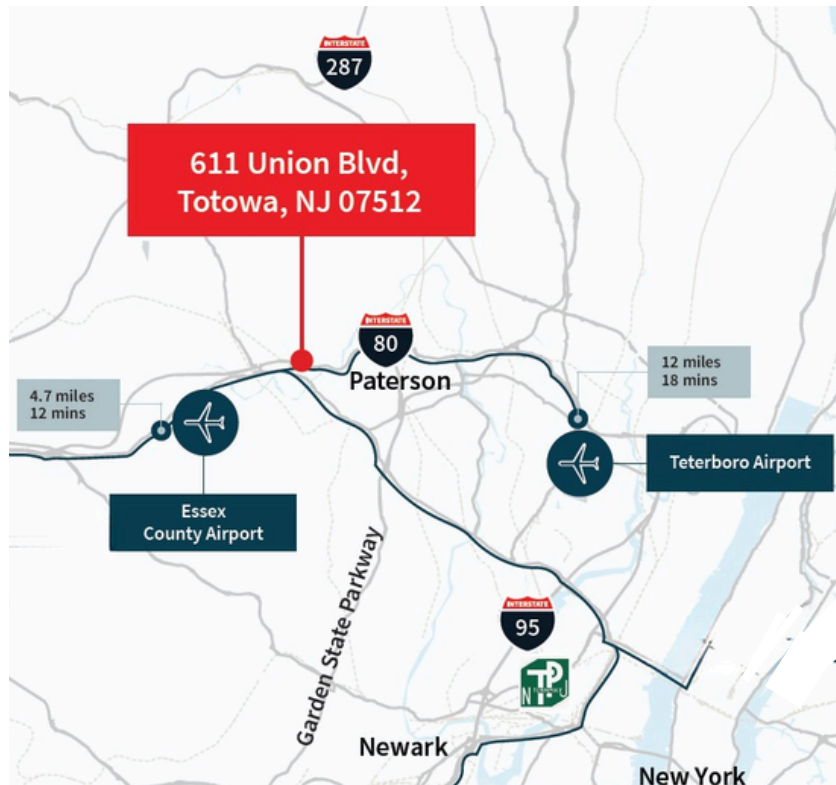

Although information has been obtained from sources deemed reliable, neither Owner nor JLL makes any guarantees, warranties or representations, express or implied, as to the completeness or accuracy as to the information contained herein. Any projections, opinions, assumptions or estimates used are for example only. There may be differences between projected and actual results, and those differences may be material. The Property may be withdrawn without notice. Neither Owner nor JLL accepts any liability for any loss or damage suffered by any party resulting from reliance on this information. If the recipient of this information has signed a confidentiality agreement regarding this matter, this information is subject to the terms of that agreement. ©2024 Jones Lang LaSalle IP, Inc. All rights reserved.