

5301 STEVENS
CREEK
BLVD

SANTA CLARA, CA

For Lease
Building 4



BUILDING 4 - POWER CAPACITY 4,000 AMPS @ 480V

1ST FLOOR 51,458 SF | OFFICE AND LAB

2ND FLOOR 27,932 SF | OFFICE AND LAB

CBRE

A SILICON VALLEY CLASSIC

Timeless design tuned to today's workplace needs.

A mid-century styled campus at the epicenter of Silicon Valley, 5301 Stevens Creek Blvd. is Santa Clara's premier workplace for growing technology companies.

BUILDING 4

1st Floor 51,458 SF | Office and Lab

2nd Floor 27,932 SF | Office and Lab

TURNKEY SPACE

RICH AMENITY PROGRAM

FLEXIBLE LEASE TERMS

FLOOR PLAN

Building 4 | First Floor

51,458 SF

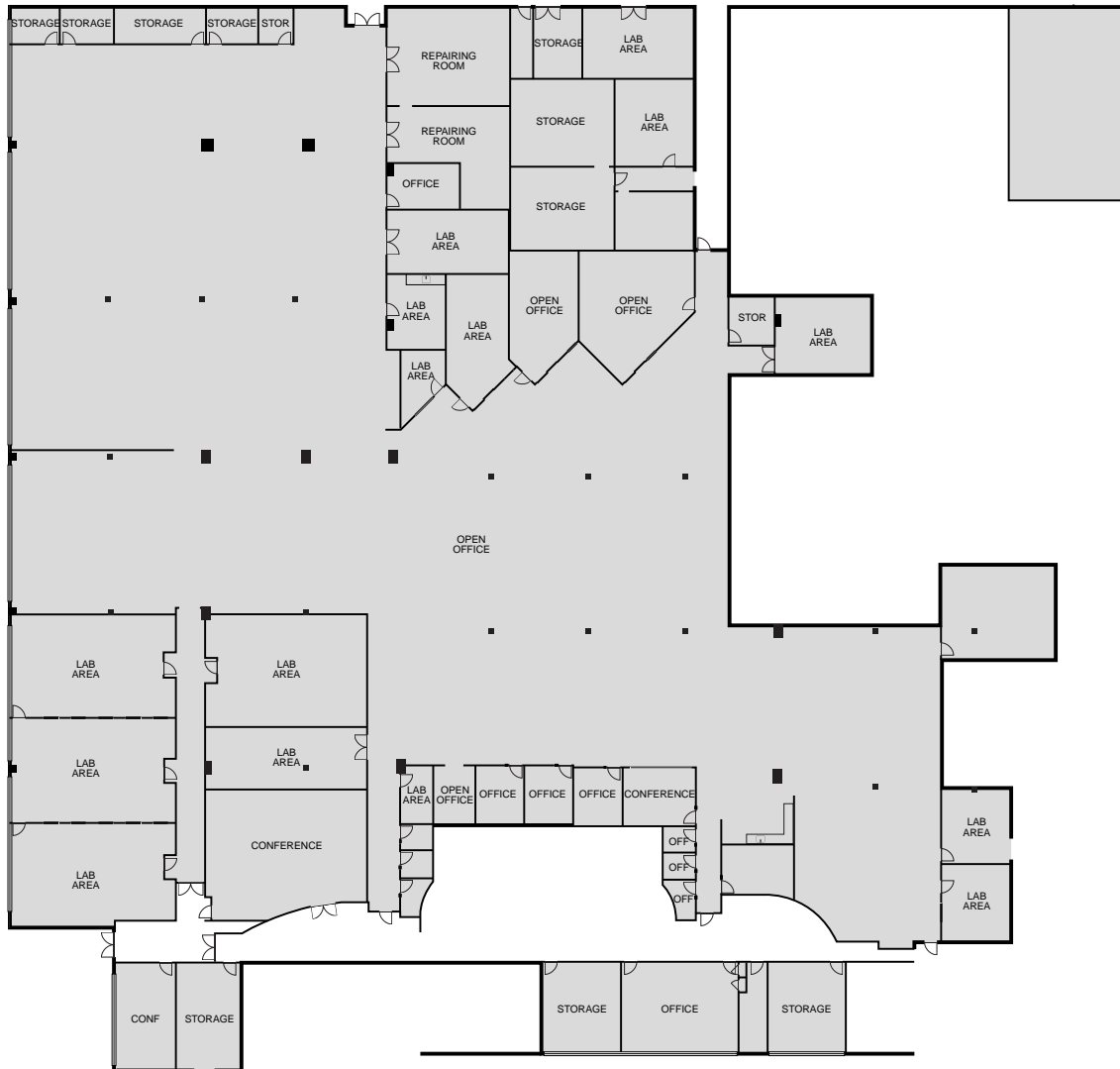

FLOOR PLAN

Building 4 | Second Floor

27,932 SF



AMENITIES

- CAFÉ SUBSIDIZED MENU
- GYM
- PICKLEBALL + BASKETBALL COURTS
- SAND VOLLEYBALL COURT
- LAWN VOLLEYBALL COURT
- CAR CHARGERS COMPLIMENTARY
- ROOF TOP LOUNGES
- POND
- AMPLE PARKING



OFFICE

PLUG-AND-PLAY
FLEXIBLE LEASE TERM
FURNITURE AVAILABLE
CONCIERGE
ON-SITE SERVICES: MANAGEMENT, SECURITY, MAINTENANCE



CAMPUS MAP

Where Innovation Meets Legacy.

A Mid-Century Modern Private Hub
in the Heart of Accessibility



AMENITIES MAP

DRIVE TIMES

MAIN STREET CUPERTINO:	3 MIN
APPLE PARK VISITOR CENTER:	5 MIN
SANTANA ROW:	8 MIN
WESTFIELD VALLEY FAIR:	10 MIN

5301
STEVENS CREEK BLVD
SANTA CLARA, CA

Westfield Valley Fair
225 Restaurant/Retail Amenities

- bloomingdales
- Bowlero
- MASTRO'S STEAKHOUSE
- The Cheesecake Factory
- EATALY
- NORDSTROM
- SEPHORA

Santana Row
62 Restaurant/Retail Amenities

- LB STEAK
- Peets Coffee & Tea
- Starbucks
- MAGGIANO'S Little Italy
- pressed
- Mendocino Farms
- Yard House
- Vans

Main Street Cupertino

- ALEXANDER'S STEAKHOUSE
- MAIN ST CUPERTINO LOFTS
- Lazy DOG
- MERIWEST CREDIT UNION
- Philz Coffee
- Orangetheory FITNESS
- PIZZA HEART

Woodcrest Hotel

Residence INN
BY HARRIOTT

Apple Park Visitor Center

HYATT house

Hilton Garden Inn

COURTYARD
BY HARRIOTT

The Row Hotel
BW
SIGNATURE COLLECTION
BY BEST WESTERN

HOTEL VALENCIA
SANTANA ROW





5301 STEVENS
CREEK
BLVD
SANTA CLARA, CA

CONTACTS

VINCE MACHADO

Executive Vice President
+1 415 310 7191
vince.machado@cbre.com
Lic. 01317553

ANTHONY PODESTA

First Vice President
+1 408 646 2778
anthony.podesta@cbre.com
Lic. 01467260

CBRE

© 2025 CBRE, Inc. All rights reserved. This information has been obtained from sources believed reliable but has not been verified for accuracy or completeness. CBRE, Inc. makes no guarantee, representation or warranty and accepts no responsibility or liability as to the accuracy, completeness, or reliability of the information contained herein. You should conduct a careful, independent investigation of the property and verify all information. Any reliance on this information is solely at your own risk. CBRE and the CBRE logo are service marks of CBRE, Inc. All other marks displayed on this document are the property of their respective owners, and the use of such marks does not imply any affiliation with or endorsement of CBRE. Photos herein are the property of their respective owners. Use of these images without the express written consent of the owner is prohibited.