

International Warehouse

±16,616 SF Available

4750 NW 15th Avenue
Fort Lauderdale, FL 33064



Property Description

International Warehouse is located just off of Commercial Blvd. and I-95 in Fort Lauderdale, FL. Building 4750 consists of a total of 4 different spaces ranging from ±6,109 SF to ±16,616 SF with a total available of ±16,616 SF. This space offers 2 grade level doors, 1 dock high and 2 van height doors. The suites offer additional features including; LED lighting, a Twin T-Roof, ±22' clear height, professional property management and institutional ownership.

Features:

- + ±16,616 SF available for lease
- + ±750 SF office
- + Available 4/1/2024
- + Newly renovated office space
- + 22' clear height
- + Zoned AIP
- + 2 grade level doors, 1 dock high door & 2 van height doors
- + 87% of South Florida's population lives within a 60-minute drive of the property
- + Strategic Broward County location
 - 2 mins. - 1 mile to I-95
 - 6 mins. - 3 miles to the Florida Turnpike
 - Centrally located between West Palm Beach & Miami

Contact Us

Michael Oretsky
Senior Associate
+1 954 798 4284
michael.oretzsky@cbre.com

Tom O'Loughlin
Vice Chairman
+1 954 817 3919
tom.oloughlin@cbre.com

Owned by:



Floor Plan

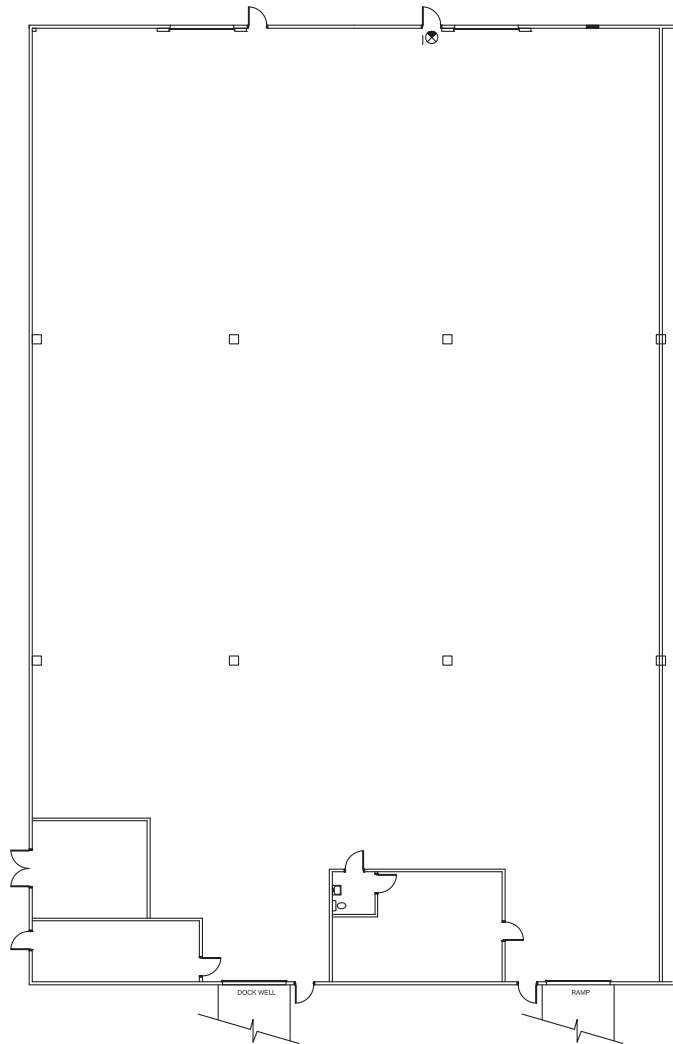

© 2024 CBRE, Inc. All rights reserved. This information has been obtained from sources believed reliable, but has not been verified for accuracy or completeness. You should conduct a careful, independent investigation of the property and verify all information. Any reliance on this information is solely at your own risk. CBRE and the CBRE logo are service marks of CBRE, Inc. All other marks displayed on this document are the property of their respective owners, and the use of such logos does not imply any affiliation with or endorsement of CBRE. Photos herein are the property of their respective owners. Use of these images without the express written consent of the owner is prohibited.