

# THE MARKET AT REDWOOD SHORES

📍 210-290 REDWOOD SHORES PKWY, REDWOOD CITY, CA



REMODEL COMING

**NICOLE LYON** [nlyon@theeconomiccompany.com](mailto:nlyon@theeconomiccompany.com) | (408) 400-7008 | LIC. 01975898

**STEPHEN RUSHER** [srusher@theeconomiccompany.com](mailto:srusher@theeconomiccompany.com) | (925) 236-2660 | LIC. 01439740



# SITE PLAN

UNIT	TENANT	SF
210	Provident Credit Union	±3,656
220	Bagel Street Cafe	±1,200
224	Chipotle Mexican Grill, Inc	±1,825
226	Amici's East Coast Pizzeria	±4,089
236	Orangetheory Fitness	±3,000
238	Five Guys Burgers & Fries	±2,275
240	Otokos	±1,575
242	Mendocino Farms, LLC	±1,575
246	Restaurant Opportunity	±3,595
250A	Available	±4,800
254	Restaurant Opportunity	±2,350
256	Falafel Tazah	±800
258	Visionone Optometry	±920
260	Available	±960
262	Available	±1,020
264	Starbucks	±1,243
268	Select Cal Physical Therapy	±2,207
270	Nob Hill General Store, Inc	±55,230
272	Chase Bank	±3,208
274	Postal Annex	±1,360
278	Dr. Rocky Dhaliwal, D.D.S.	±1,725
280	New Life	±1,274
282	IV Nutrition	±1,476
290	UCSF health	±9,375

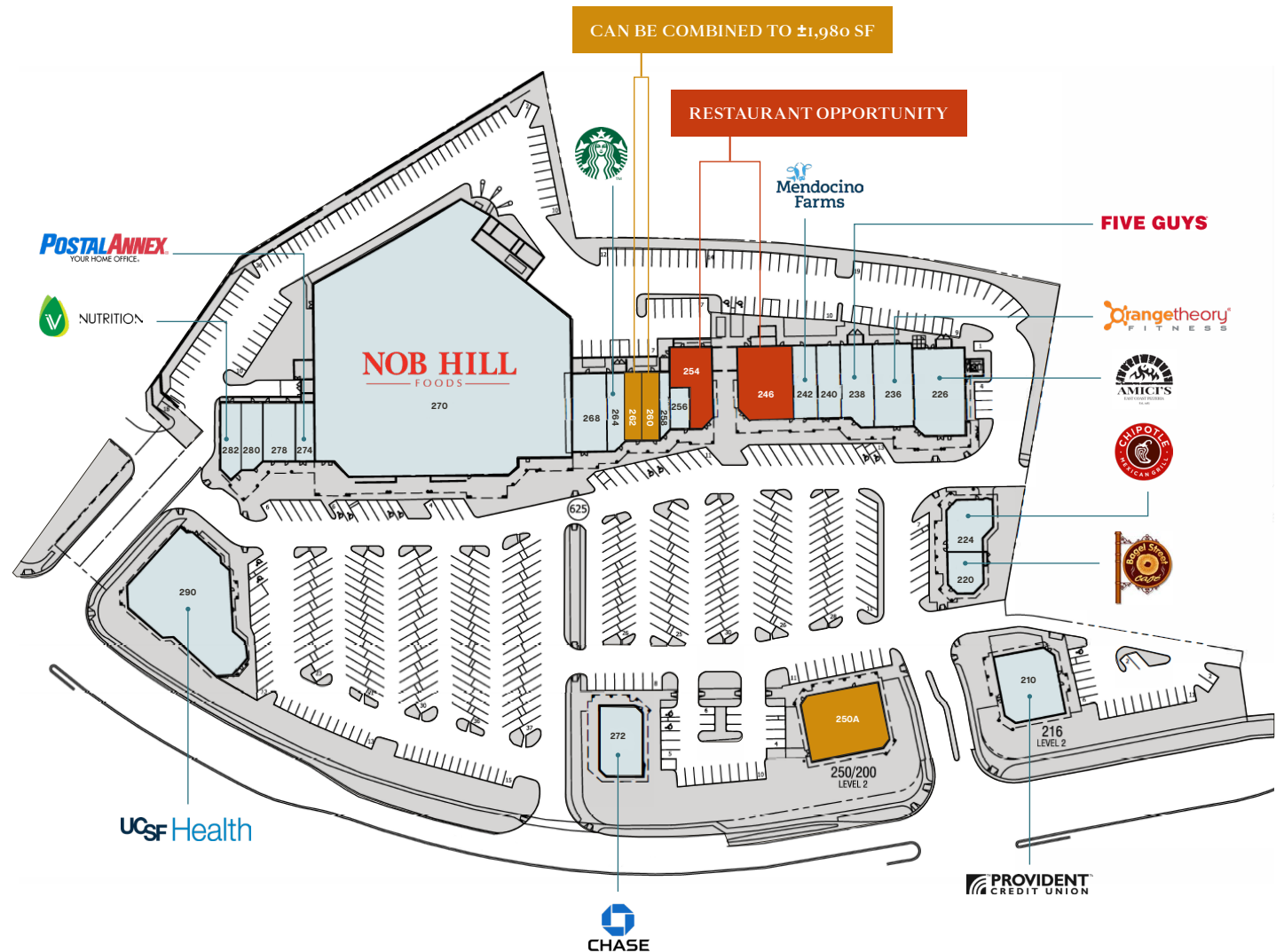

■ Available
 ■ Restaurant Opportunity

# BREEZEWAY PATIO RENDERINGS

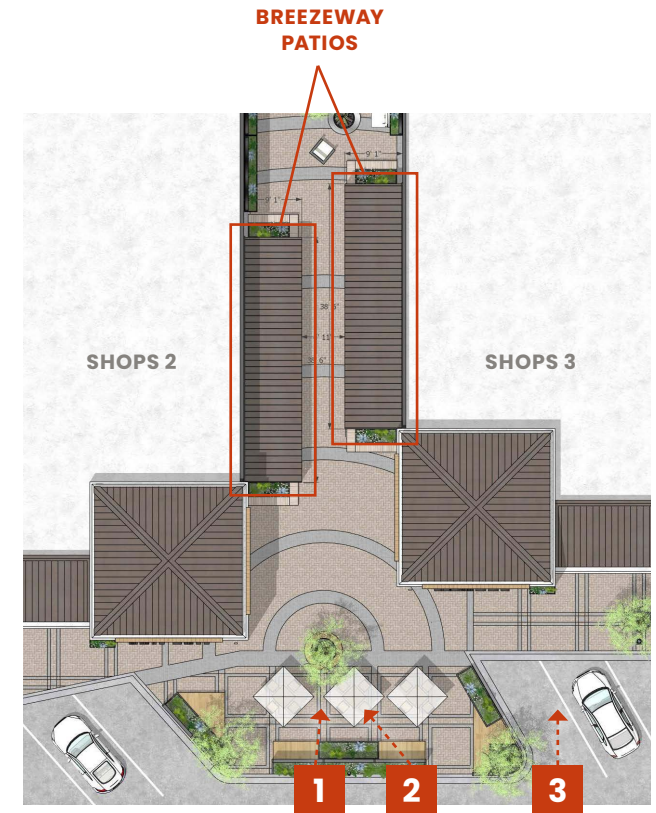

PROPOSED FLOOR PLAN

# SUITE 246

## 3,595 SF

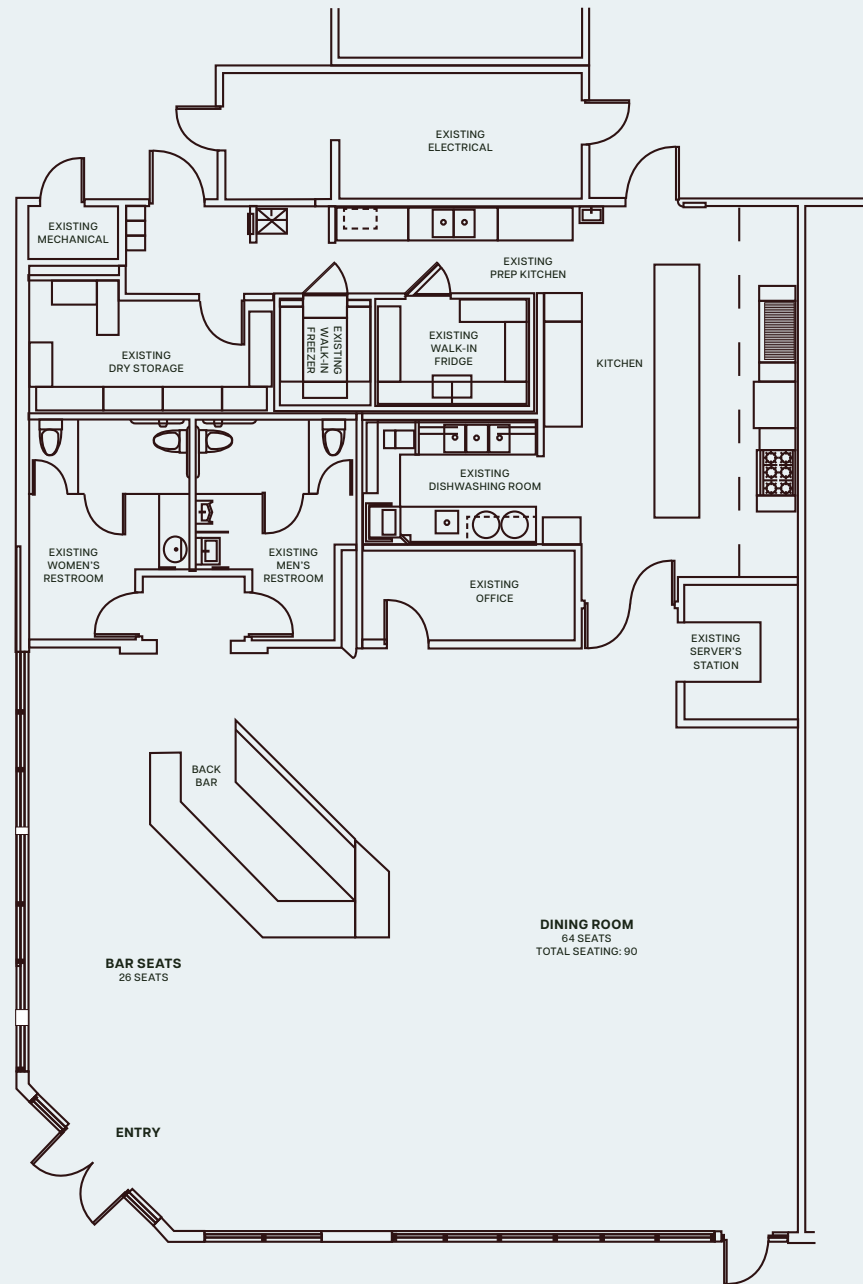

# HIGHLIGHTS



Located in the dense San Francisco Peninsula, with access to numerous transportation hubs and centrally located near Hwy 101 in between the San Mateo and Dumbarton Bridge.



Main neighborhood center serving the Redwood Shores housing area.



Surrounded by over 2 million square feet of Class A office and headquarter to numerous companies.



The shopping center has an electric mix of the best in class tenants within their respective categories.



Building façade improvement plan underway.



Elevated merchandising with a brand-new Chipotle and Mendocino Farms.



DEMOGRAPHICS	1 MILE	3 MILES	5 MILES
Population	6,488	138,464	291,166
Median HH Income	\$176,072	\$172,596	\$156,207
Daytime Employment	21,778	102,375	184,624

## TRAFFIC COUNTS

Source: 2025 Esri

Highway 101 & Holly St exit	214,520 ADT
Redwood Shores Pkwy & Cringle Dr NE	14,098 ADT
Redwood Shoes Pkwy & Bridge Pkwy SW	13,160 ADT

# MARKET AERIAL

BURLINGAME

EQUINOX

SAN MATEO

FOSTER CITY

BRIDGEPOINT SC

**TARGET** **PETCO**  
**BED BATH & BEYOND** **WORLD MARKET**  
**Toys R Us** **ULTA** **Marshalls**

PARKSIDE PLAZA

**Smart & Final** **PET CLUB** **Office DEPOT**

**COSTCO WHOLESALE**

**Dräger's MARKET**

**Walgreens**

**Chavez Supermarket**

**SAFeway**

**Kmart**

THE MARKETPLACE

**SAFeway** **CVS**

MARLIN COVE

**99 Ranch Market**

BOREL SQUARE

**24 FITNESS** **CVS**

SAN MATEO COMMONS

**TRADER JOE'S** **ROSS DRESS FOR LESS**  
**TJ-MAXX** **RITE AID**

BAY MEADOW

**WHOLE FOODS**

MARINA FOOD

EDGEWATER PLACE

**Lucky**

HILLSDALE REGIONAL MALL

**TRADER JOE'S** **NORDSTROM** **The Ossecake Factory**  
**macys** **BARNES & NOBLE** **FOREVER 21**

**PETSMART**

CRYSTAL SPRINGS

**PLAZZA'S** **RITE AID**

**Quitar Center**

**Walgreens**

ORACLE

CRYSTAL SPRINGS

**SAFeway** **CVS**

**OLD NAVY**

**CVS**

**MOLLIE STONE'S MARKETS**

THE MARKET AT REDWOOD SHORES

CARLMONT VILLAGE SHOPPING CENTER

**Lupard's** **Starbucks** **Jamba** **The Tavern**  
**ACE Hardware** **Chevron** **BR** **SUBWAY**

**NOB HILL** **Mendocino Farms** **RE/MAX** **POSTAL ANNEX** **Bank of America**  
**AMIC'S** **CHASE** **FIVE GUYS** **Starbucks** **QUICK COPY** **WALGREENS**

# THE MARKET AT REDWOOD SHORES

📍 210-290 REDWOOD SHORES PKWY, REDWOOD CITY, CA



**NICOLE LYON** nlyon@theeconomiccompany.com | (408) 400-7008 | LIC. 01975898

**STEPHEN RUSHER** srusher@theeconomiccompany.com | (925) 236-2660 | LIC. 01439740

