

1 BASEMENT FLOOR PLAN
SCALE: 1/4" = 1'-0"

LEASABLE AREA = 855 SQ.FT.

EQUIPMENT LISTS:

- | | |
|--|--|
| 1 3 COMPARTMENT SINK BY ADVANCE TABCO MODEL FE-3-1812-18RLX. | 11 REGISTER NO.2 - APPLE IPAD. |
| 2 REFRIGERATOR BY TRUE MODEL TS49 2 DOOR. | 12 STAINLESS STEEL SHELVINGS BY ADVANCE TABCO. |
| 3 BAKERY CASE BY MARTINEZ GLASS. | 13 MOP SINK BY ADVANCE TABCO MODEL 9-0P-20. |
| 4 U.C. REFRIGERATOR BY TRUE MODEL TUC-48 2 DOOR. | 14 HAND SINK BY ADVANCE TABCO MODEL 7PSS-23. |
| 5 EXPRESSO MACHINE BY LAMARZOCCO MODEL STRADA2MP. | 15 DUMP SINK BY ADVANCE TABCO MODEL D1-1-10. |
| 6 ICE MACHINE BY HOSHIZAKI MODEL KM2015-H. | 16 KEG DISPENSER - TBD BY TENANT. |
| 7 COFFEE GRINDER BY DITTING MODEL KR804. | 17 WALK-IN COOLER BOX - TBD BY TENANT. |
| 8 HOT WATER BOILER BY FETCO MODEL HWB2110. | 18 PITCHER RINSER - EXPRESSO PARTS. |
| 9 U.C. REFRIGERATOR BY TRUE MODEL TUC-48G. | 19 KNOCK CHUTE - EXPRESSO SUPPLIED. |
| 10 EXPRESSO GRINDER BY MAZAZER LUIII - KONI ELECTRIC. | |

NOTES:

- SEE ELECTRICAL DRAWINGS FOR LIGHTING LAYOUT.
- SEE MECHANICAL DRAWINGS FOR HVAC LAYOUT.
- ALL EXPOSED DUCT WORK SHALL BE RIGID TYPE AND PAINTED FINISH (COLOR TBD BY TENANT).
- ALL EXPOSED ELECTRICAL/UTILITY CONDUITS SHALL BE PAINTED FINISH (COLOR TBD BY TENANT).
- ALL LIGHTING/LAMPS AT FOOD PREP/SERVING AREAS SHALL HAVE NON-BREAKABLE LENS.

EXIT WIDTH ANALYSIS (SECT. 1005.3.2):
BASEMENT FLOOR AREA = 855 SQ.FT.
855 SQ.FT. / 300 = 3 OCCUPANTS
3 X 0.20 = 0.60'
ACTUAL EXIT WIDTH PROVIDED = 3'-6"

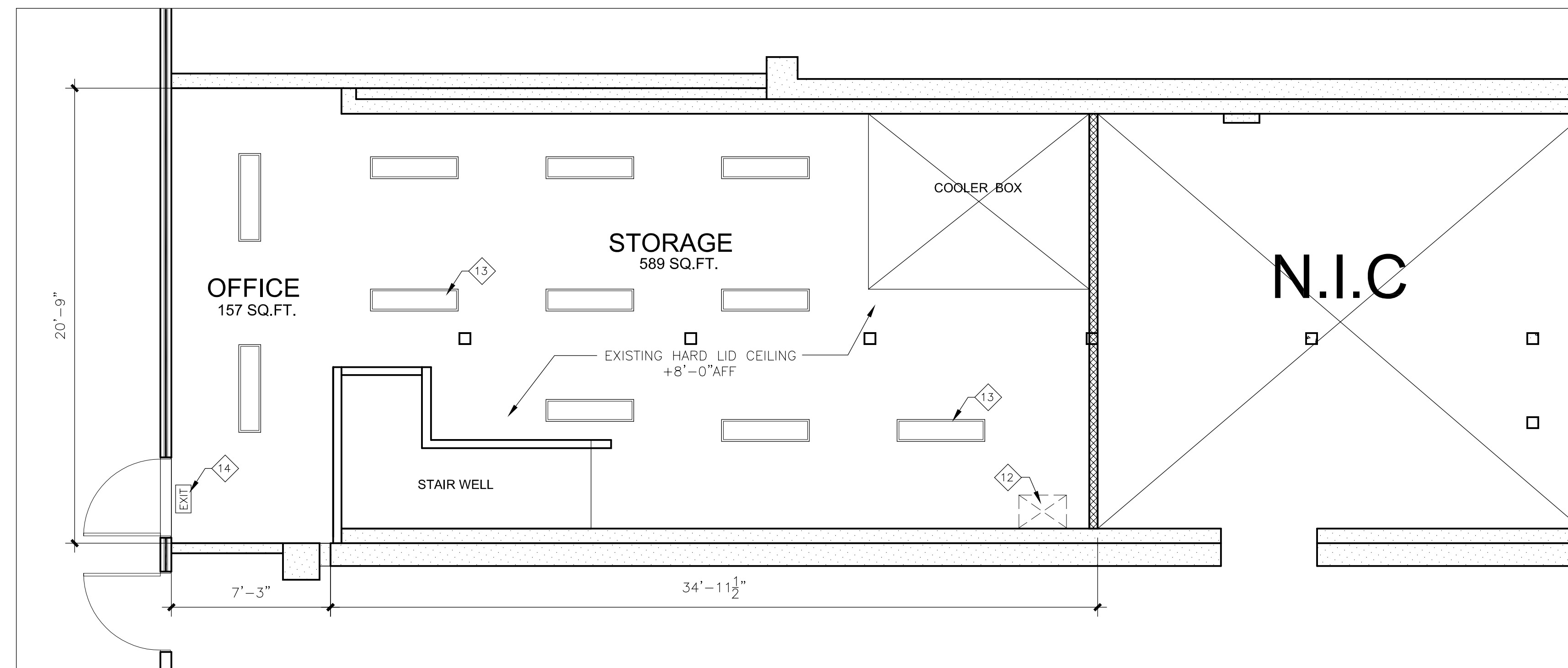

2 BASEMENT REFLECTED CEILING PLAN
SCALE: 1/4" = 1'-0"

KEY NOTES:

- EXISTING BRICK WALL TO REMAIN. CLEAN AND SEALED AS REQUIRED.
- EXISTING FULL HEIGHT DEMISING WALL
- EXISTING COLUMN.
- EXISTING CAST-IN-PLACE CONC. RAMP WITH 1:12 MAX. SLOPE. RAMP WITH 6" OR MORE RISE SHALL BE PROVIDED WITH HANDRAIL PER DETAIL 10/A1.1
- EXISTING RAISED CONCRETE FLOOR (+-4").
- PRE-FABRICATED COOLER BOX BY TENANT INSTALLED BY CONTRACTOR.
- FLOOR SINK.
- WATER HEATER ON RAISED PLATFORM SECURED TO WALL BY SEISMIC STRAPS.
- 3-5/8"x20 GA. MTL. STUDS @ 24" O.C. WITH 5/8" THK. GYP. BD. ON BOTH SIDES TO UNDERSIDE OF CEILING. SEE DET. 5/A4.0
- FURNITURES BY TENANT.
- EXISTING DOOR WITH PANIC DEVICE.
- EXISTING DUCT CHASE.
- FLUORESCENT LIGHT FIXTURES SURFACE MOUNT.
- ILLUMINATED EXIT SIGN. CONNECT TO POWER SOURCE WITH BATTERY BACKUP.
- EXIT SIGN WITH BRAILLE. SEE DETAIL - 1/A4.0.
- JANITORIAL SINK WITH HOT & COLD WATER LINE.

WALL LEGEND:

- EXISTING DEMISING WALL (BEARING WALL)
- EXISTING DEMISING WALL (NON-BEARING)
- EXISTING 2 HOUR RATED EXIT CORRIDOR WALL
- NEW WALL TO UNDERSIDE OF CEILING. SEE DETAIL 5/A4.0

