

Alliance★Florida®

at

# CECIL COMMERCE CENTER

5550 POW-MIA MEMORIAL PKWY, BLDG E  
JACKSONVILLE, FL

[www.hillwood5550powmia.com](http://www.hillwood5550powmia.com)

**603,529 SF**  
**Available**



**AllianceFlorida is a premier master-planned business park with state-of-the-art facilities available. The park's excellent multimodal location on Jacksonville's Westside offers superior access to the Southeastern U.S. market.**

OFFICE: 4,027 SF

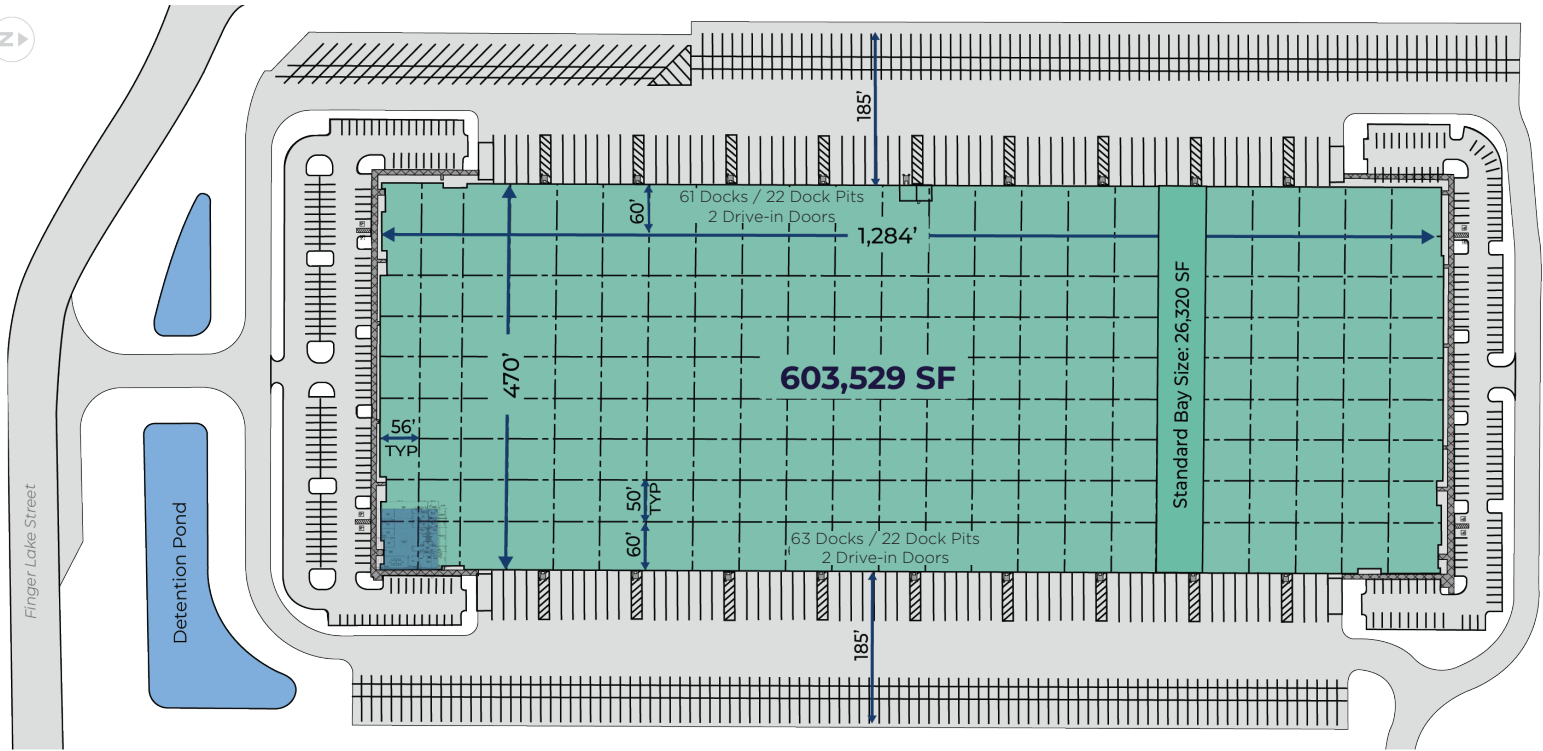
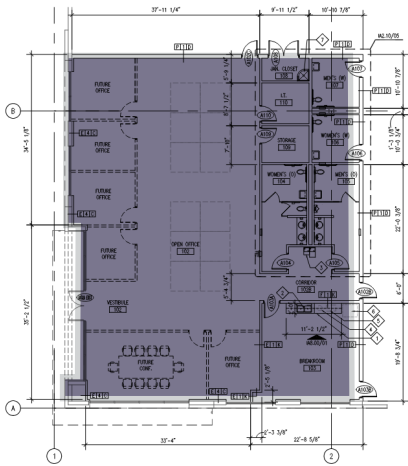

# PROPERTY HIGHLIGHTS

|                            |                                       |
|----------------------------|---------------------------------------|
| <b>AVAILABLE SF</b>        | 603,529 SF                            |
| <b>SITE AREA</b>           | 43.54 Acres                           |
| <b>CONFIGURATION</b>       | Cross Dock                            |
| <b>BUILDING DIMENSIONS</b> | 470' x 1,284'                         |
| <b>CLEAR HEIGHT</b>        | 40'                                   |
| <b>POWER</b>               | 277/480V, 3 phase service, 3,000-amps |

|                       |  |
|-----------------------|--|
| <b>OFFICE</b>         | 4,027 SF   |
| <b>COLUMN SPACING</b> | 56' w x 50' d (56' x 60' staging bay)                    |
| <b>DOCK DOORS</b>     | 124 (9' x 10' insulated)                                 |
| <b>DRIVE-IN RAMPS</b> | 4 (14' x 16')  |
| <b>DOCK PITS</b>      | 44   |
| <b>CONCRETE</b>       | 7" thick, 4,000 psi floor slab with 10-mil vapor barrier |

|                        |   |
|------------------------|---|
| <b>ROOF</b>            | 45 Mil TPO with 20-yr warranty                |
| <b>TRUCK COURT</b>     | 185' deep with 60' apron; all concrete paving |
| <b>AUTO PARKING</b>    | 322   |
| <b>TRAILER PARKING</b> | 210   |
| <b>LEVELERS</b>        | 10 (7' x 8') 40,000 lbs                       |
| <b>FIRE PROTECTION</b> | ESFR  |

# SITE AERIAL

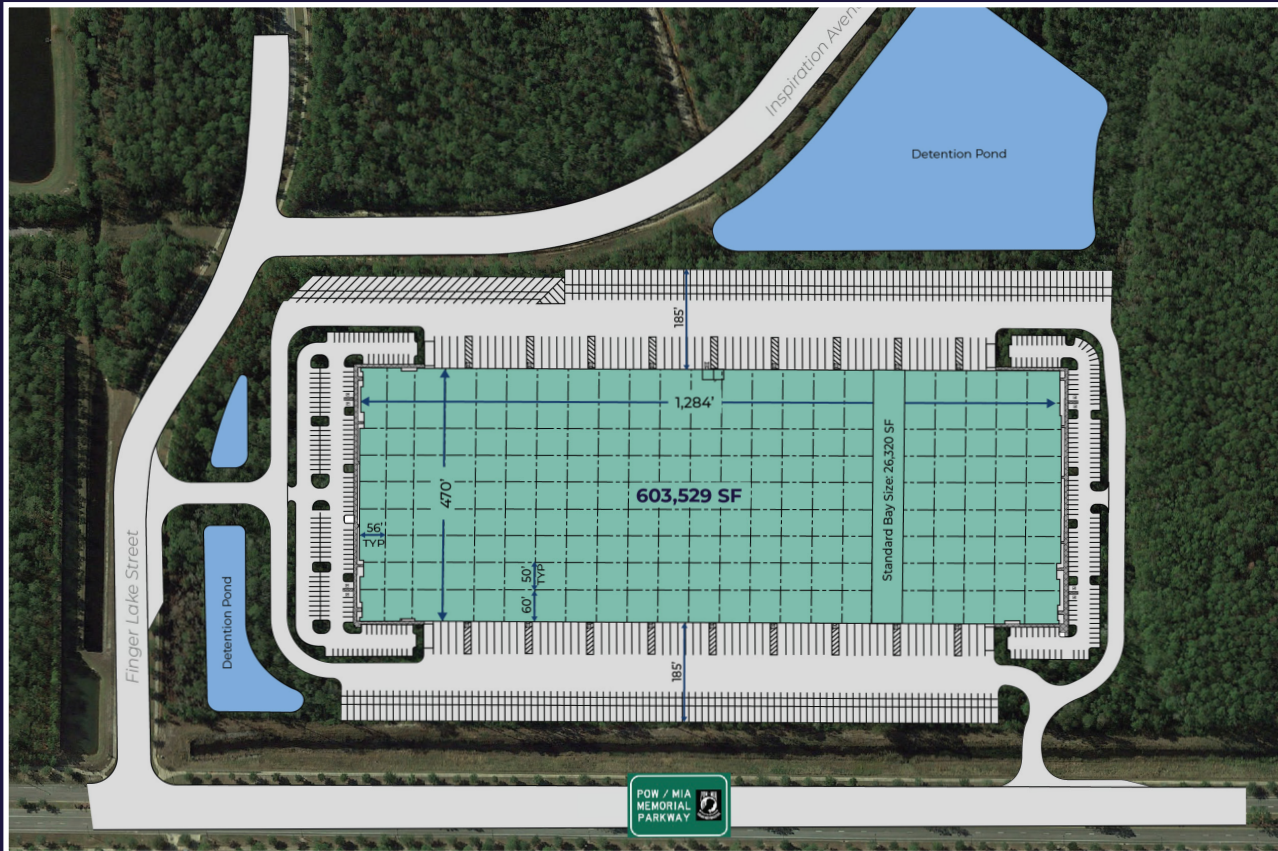

## Alliance★Florida®

- Immediate access via the newly completed high-speed I-10 interchange to I-75, I-295, and I-95
- Pro-growth local government
- No state or local personal income tax
- No inventory tax
- FTZ available (proposed FTZ magnet site under FTZ #64)
- Federal Empowerment Zone incentives available
- State Enterprise Zone incentives available
- On-site workforce training and education

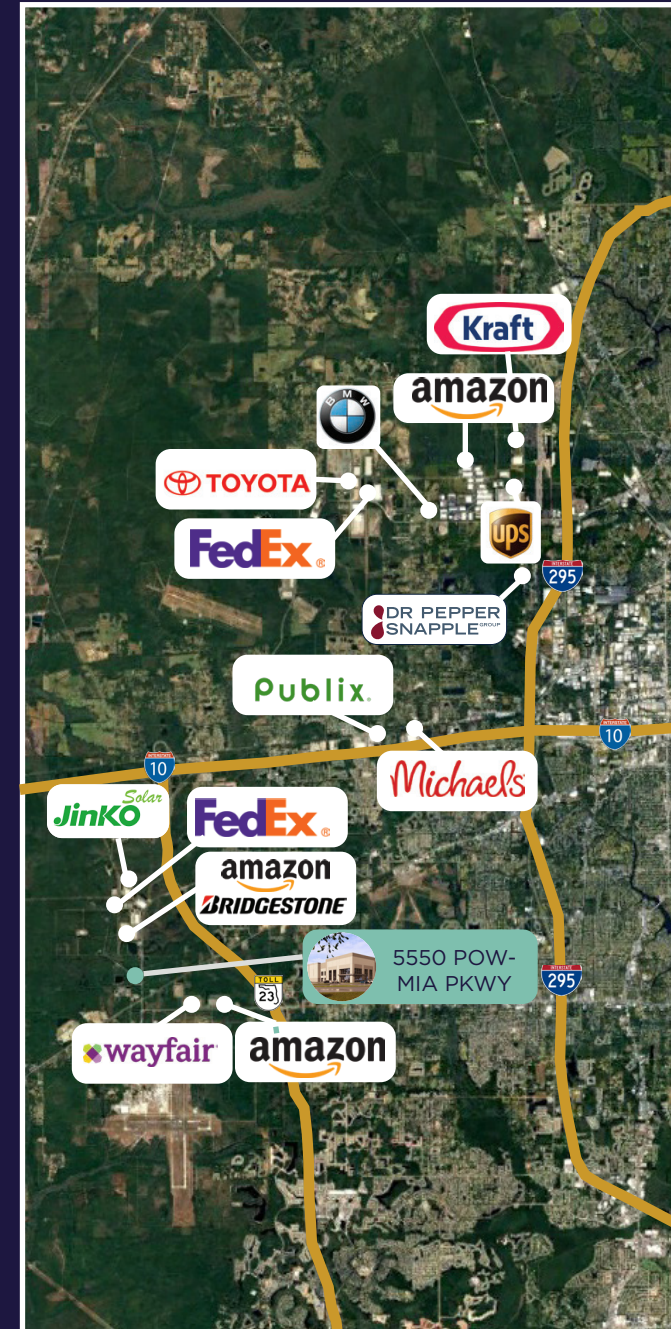

*Jacksonville  
is America's  
Logistics  
Center*

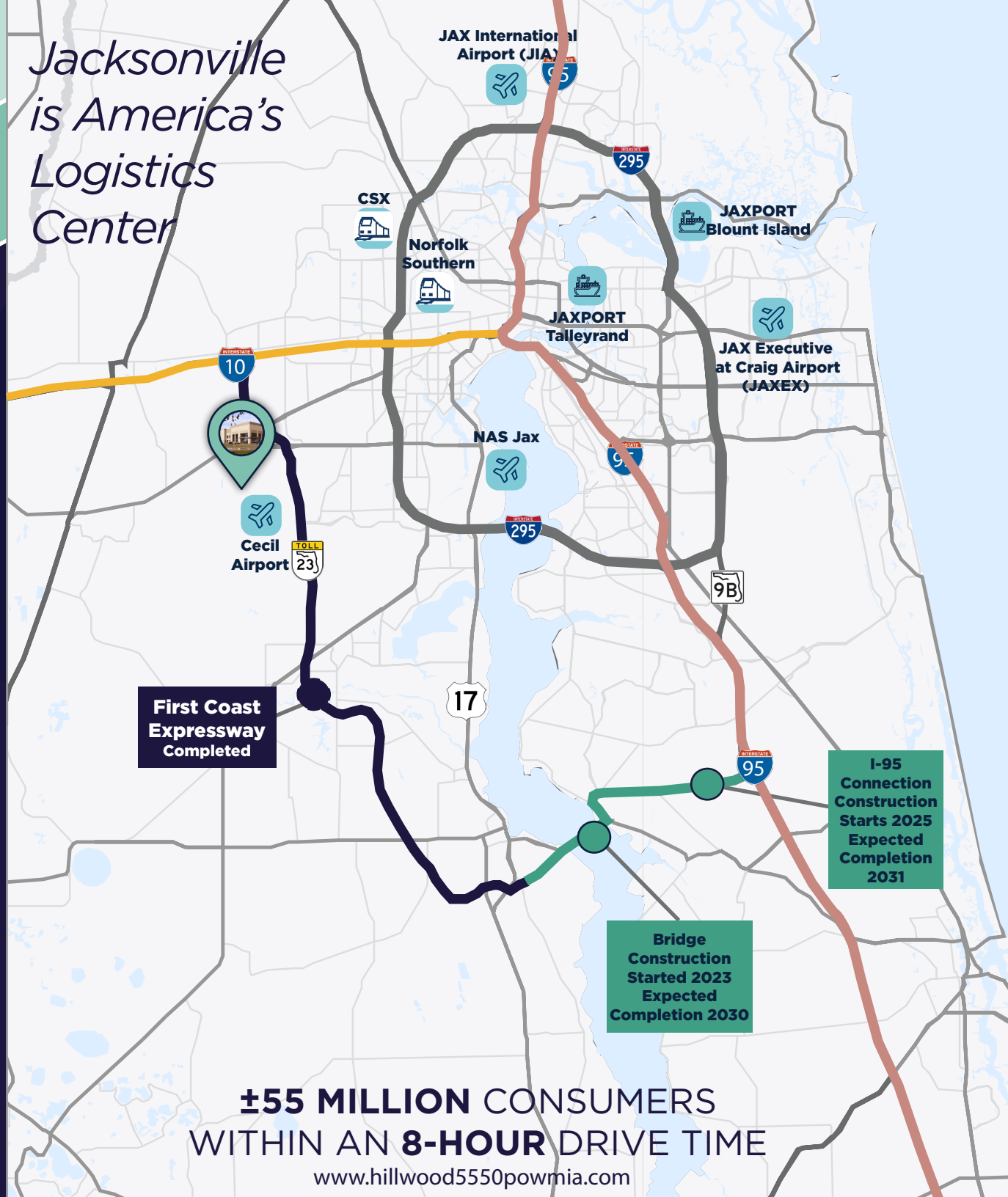

**First Coast  
Expressway  
Completed**

**I-95  
Connection  
Construction  
Starts 2025  
Expected  
Completion  
2031**

**Bridge  
Construction  
Started 2023  
Expected  
Completion 2030**

**±55 MILLION CONSUMERS  
WITHIN AN 8-HOUR DRIVE TIME**

[www.hillwood5550powmia.com](http://www.hillwood5550powmia.com)

## DRIVE TIMES

### FIRST COAST EXPRESSWAY

4.0 MILES  
6 MINUTES

.....

### I-10

6.3 MILES  
8 MINUTES

.....

### I-295

6.3 MILES  
8 MINUTES

.....

### I-95

6.3 MILES  
8 MINUTES

.....

### CSX INTERMODAL

16 MILES  
22 MINUTES

.....

### JAXPORT TALLEYRAND

22 MILES  
26 MINUTES

.....

### JAXPORT BLOUNT ISLAND

33 MILES  
33 MINUTES

.....

### JIA AIRPORT

27 MILES  
31 MINUTES

AREA INFORMATION

# MASTER SITE PLAN



Alliance★Florida®  
 at CECIL COMMERCE  
 CENTER  
 5550 POW-MIA PKWY

RETAIL SITES  
 AVILABLE

Alliance★Florida®

SITE DATA

- INDUSTRIAL USE**  
22,643,000 SF
- MEGA SITE**  
9,400,000 SF
- MIXED USE**  
1,475,000 SF
- CECIL COMMERCE CENTER - BLDG E**  
603,529 SF



**500 MILES**

**1-DAY TRANSIT**

**A CORNERSTONE FOR JACKSONVILLE'S SUPPORT OF THE WORLD'S SUPPLY CHAIN IS THE JACKSONVILLE PORT AUTHORITY (JAXPORT).**

**OFFERING CONNECTIVITY TO 140 PORTS IN MORE THAN 70 COUNTRIES WITH ITS 47-FOOT-DEEPWATER SHIPPING CHANNEL, TWO-WAY SHIP TRAFFIC AND SAME-DAY ACCESS TO 98 MILLION CONSUMERS IN THE UNITED STATES.**



Sources: ESRI, United States Census Bureau, Florida Office of Economic & Demographic Research (EDR), U.S. Bureau of Labor Statistics

# DEMOGRAPHICS

## POPULATION

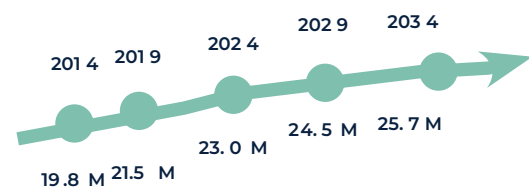

For a five year period beginning April 2024, the Florida population growth is expected to average 319,109 net new residents per year.

## JACKSONVILLE LABOR

|                                 |         |
|---------------------------------|---------|
| Civilian Labor Force            | 864,000 |
| Industrial Labor Force          | 4.5%    |
| Average Blue Collar Hourly Rate | \$17.41 |
| Unemployment Rate               | 3.6%    |

## FIRST COAST EXPRESSWAY (STATE ROAD 23)

4 Miles / 6 Minutes

from 5550 POW-MIA Memorial Parkway



State Road 23 helps reduce traffic congestion and enhances access to important employment centers, fostering economic development and strengthening local connectivity for business across the region. Completion anticipated for 2031.

## WHY JAX?

|   |  |  |  |
|---|--|--|--|
| <p><b>2</b></p> <p><b>DEEP WATER PORTS</b></p>        | <p><b>3</b></p> <p><b>INTERSTATE HIGHWAYS</b></p>    | <p><b>4</b></p> <p><b>MILITARY INSTALLATIONS</b></p> | <p><b>4</b></p> <p><b>RAILROADS (2 CLASS I)</b></p>        |
| <p><b>90</b></p> <p><b>DAILY NON STOP FLIGHTS</b></p> | <p><b>17</b></p> <p><b>GLOBAL SHIPPING LINES</b></p> | <p><b>39</b></p> <p><b>MEDIAN AGE</b></p>            | <p><b>26</b></p> <p><b>AVERAGE COMMUTE TIME (MINS)</b></p> |



Alliance★Florida®  
at

# CECIL COMMERCE CENTER

5550 POW-MIA MEMORIAL PKWY, BLDG E  
JACKSONVILLE, FL

## NOW AVAILABLE!

For **LEASING** information, please contact:

**TYLER NEWMAN**

Executive Managing Director  
+1 904 380 8336  
tyler.newman@cushwake.com

**JACOB HORSLEY**

Executive Managing Director  
+1 904 380 8335  
jacob.horsley@cushwake.com

For **DEVELOPMENT** information, please contact:

**DAN TATSCH**

972 201 2977 (O)  
dan.tatsch@hillwood.com

**BRENNEN CLIFFORD**

678 357 8886 (c)  
brennen.clifford@hillwood.com



121 W Forsyth Street | Suite 900  
Jacksonville, FL 32202  
cushmanwakefield.com



3414 Peachtree Road NE | Suite 1050  
Atlanta, GA 30326  
hillwood.com

[www.hillwood5550powmia.com](http://www.hillwood5550powmia.com)

©2025 Cushman & Wakefield. All rights reserved. The information contained in this communication is strictly confidential. This information has been obtained from sources believed to be reliable but has not been verified. NO WARRANTY OR REPRESENTATION, EXPRESS OR IMPLIED, IS MADE AS TO THE CONDITION OF THE PROPERTY (OR PROPERTIES) REFERENCED HEREIN OR AS TO THE ACCURACY OR COMPLETENESS OF THE INFORMATION CONTAINED HEREIN, AND SAME IS SUBMITTED SUBJECT TO ERRORS, OMISSIONS, CHANGE OF PRICE, RENTAL OR OTHER CONDITIONS, WITHDRAWAL WITHOUT NOTICE, AND TO ANY SPECIAL LISTING CONDITIONS IMPOSED BY THE PROPERTY OWNER(S). ANY PROJECTIONS, OPINIONS OR ESTIMATES ARE SUBJECT TO UNCERTAINTY AND DO NOT SIGNIFY CURRENT OR FUTURE PROPERTY PERFORMANCE.