

Bryan Dairy Business Center



Property Overview

- **Asset Type:** Flex Space
- **Size Breakdown:**
 - **Office:** 670 SF
 - **Warehouse:** 170 SF
- **Loading:** One (1) Grade Level Door
- **Clear Height:** 12'
- **Sprinklered:** Yes
- **Availability:** Now
- **Parking Ratio:** 4.2 / 1,000
- **Climate Controlled:** Yes

Property Improvements

- Brand New Exterior Paint
- All Units are Move-In Ready
 - New Paint
 - New Flooring in the Offices
 - Brand New LED Lighting
 - New bathroom fixtures

7201-7243 Bryan Dairy Rd

Suite 7209-B | 840 SF

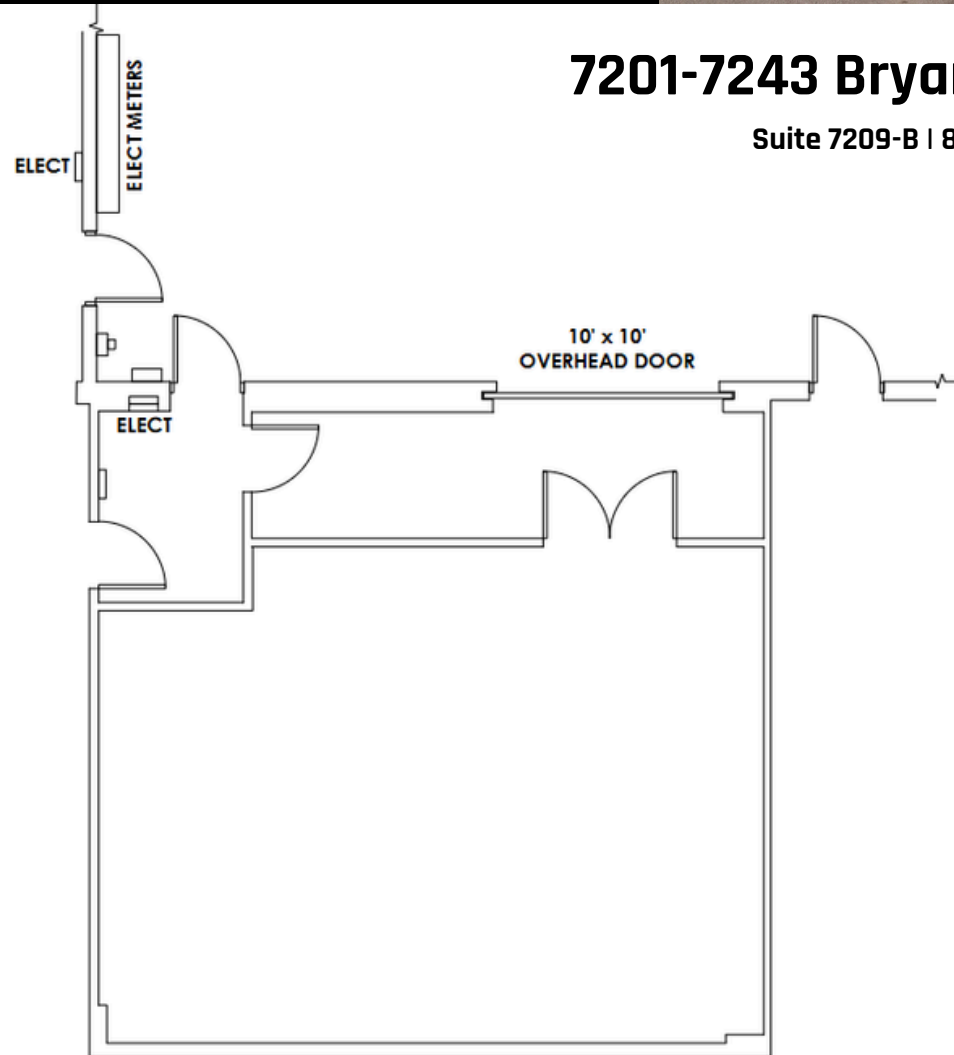

LOBER
REAL ESTATE

DEVIN BEELER
Senior Associate
727-709-2179
Devin@LoberRealEstate.com

ALEC SEOW
Associate
865-863-0399
Alec@LoberRealEstate.com

ROBBIE LOBER
Managing Member
727-999-1806
Robbie@LoberRealEstate.com

MARIA DISILVESTRO
Brokerage Coordinator
513-707-2263
Maria@LoberRealEstate.com