

FOR LEASE

8 HOLLAND, IRVINE

±7,836 SF INDUSTRIAL SPACE



PROPERTY FEATURES

- ±7,836 SF Industrial Space
- ±2,500 SF of Single-Story Office Space
- 400 Amps – 120/208v
- 17' Clear Height
- 1 GL Door (12' x 12')
- 20 Parking Spaces (2.55:1,000 SF)
- Excellent Irvine Spectrum Location
- Part of a Larger ±21,681 SF Building
- **Asking Rate: \$1.75/SF NNN + \$0.32/SF OPEX**

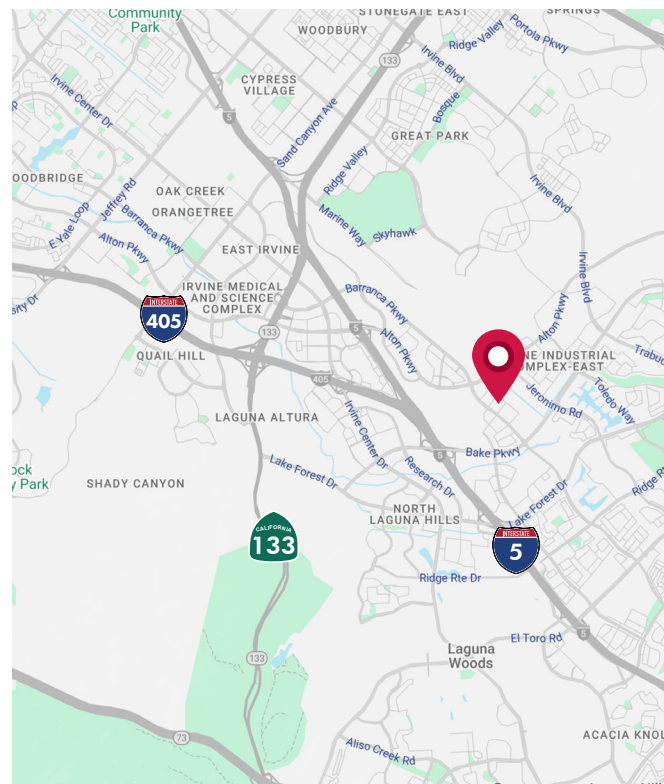

DALE CAMERA
Senior Vice President
License ID# 01313921
949.790.3132
dcamera@leeirvine.com

JASON HELMICK
Senior Vice President
License ID# 01786729
949.790.3119
jhelmick@leeirvine.com

ZACH SCHWANER
Senior Vice President
License ID# 02009623
949.790.3159
zschwanner@leeirvine.com

DYLAN DAVEY
Associate
License ID# 02219560
949.790.3162
ddavey@leeirvine.com

 **LEE & ASSOCIATES**
COMMERCIAL REAL ESTATE SERVICES

ORANGE COUNTY INDUSTRIAL

FOR LEASE

8 HOLLAND, IRVINE

±7,836 SF INDUSTRIAL SPACE

SITE PLAN

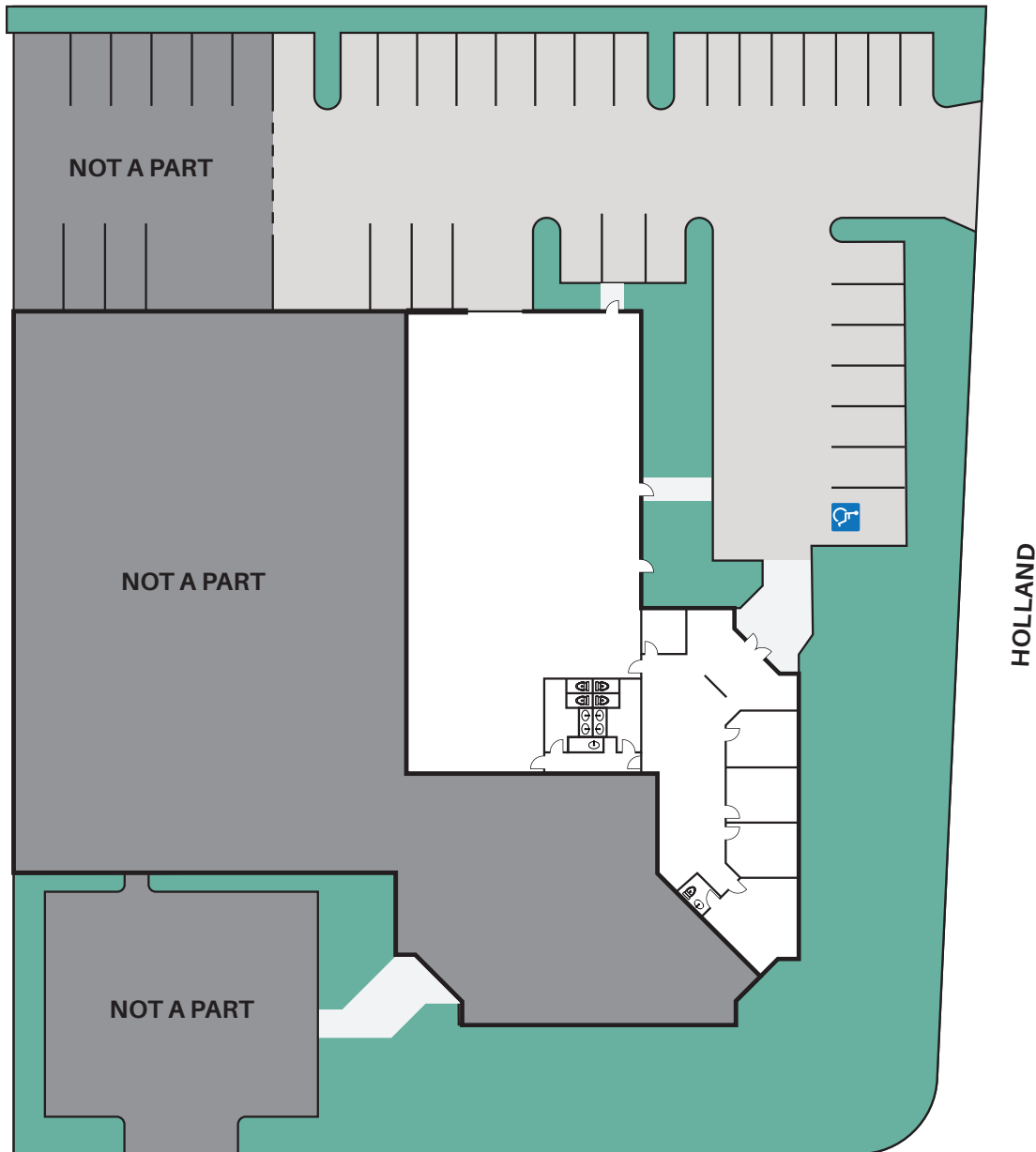

THOMAS

DALE CAMERA
Senior Vice President
License ID# 01313921
949.790.3132
dcamera@leeirvine.com

JASON HELMICK
Senior Vice President
License ID# 01786729
949.790.3119
jhelmick@leeirvine.com

ZACH SCHWANER
Senior Vice President
License ID# 02009623
949.790.3159
zschwanner@leeirvine.com

DYLAN DAVEY
Associate
License ID# 02219560
949.790.3162
ddavey@leeirvine.com



FOR LEASE

8 HOLLAND, IRVINE

±7,836 SF INDUSTRIAL SPACE



DALE CAMERA
Senior Vice President
License ID# 01313921
949.790.3132
dcamera@leeirvine.com

JASON HELMICK
Senior Vice President
License ID# 01786729
949.790.3119
jhelmick@leeirvine.com

ZACH SCHWANER
Senior Vice President
License ID# 02009623
949.790.3159
zschwanner@leeirvine.com

DYLAN DAVEY
Associate
License ID# 02219560
949.790.3162
ddavey@leeirvine.com

 **LEE & ASSOCIATES**
COMMERCIAL REAL ESTATE SERVICES

ORANGE COUNTY INDUSTRIAL