



1811
1811 Obstetrics
& Gynecology

2,300 SF SUBLEASE | MEDICAL OFFICE AVAILABLE

1811 LUCERNE TERRACE

ORLANDO, FL 32806



CUSHMAN &
WAKEFIELD

1811 LUCERNE TERRACE

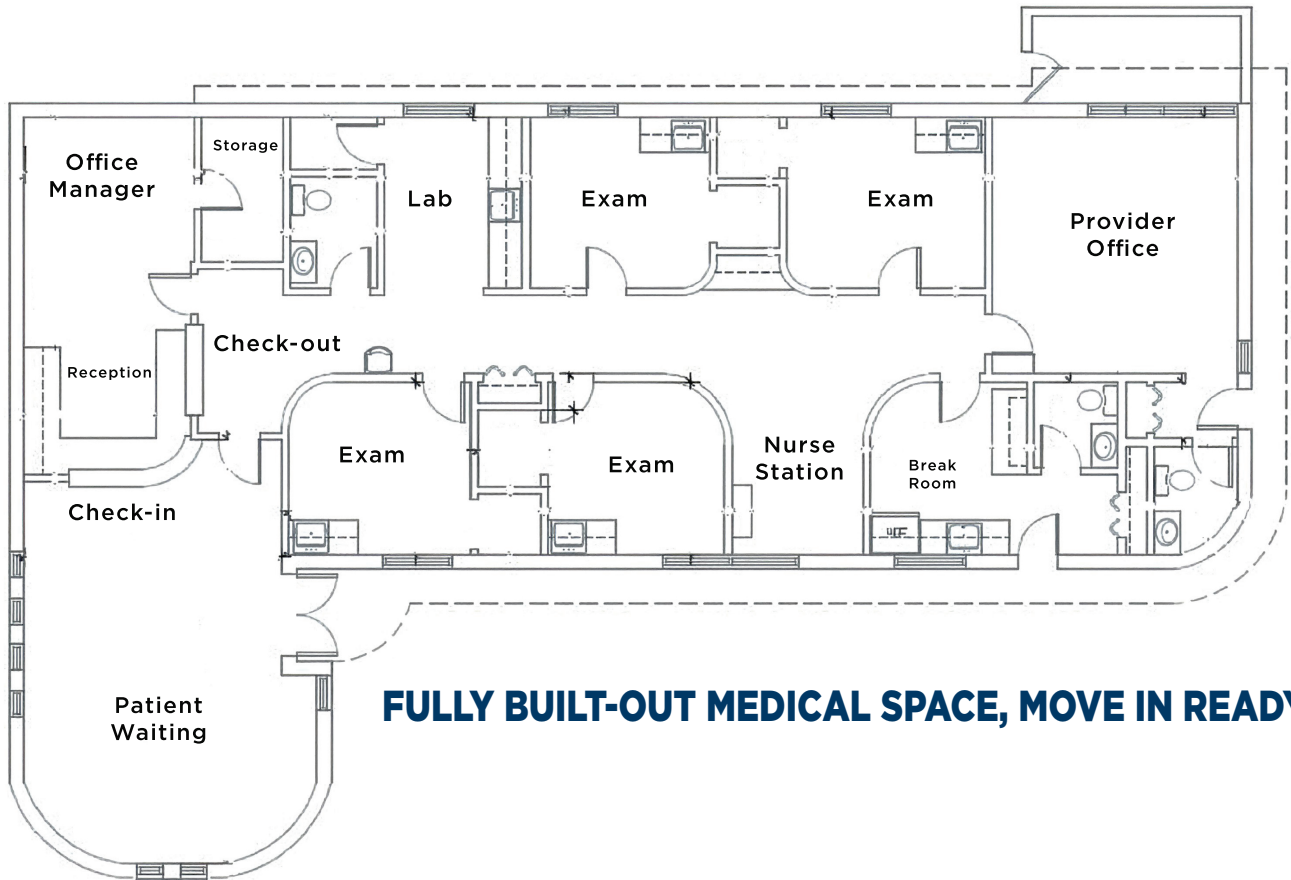

FULLY BUILT-OUT MEDICAL SPACE, MOVE IN READY!

PROPERTY HIGHLIGHTS

- Sublease Rate: \$25.00/Modified Gross
- Available: 2,300 SF
- Parking 6.77/1,000 SF
- Sublease Expiration: Jan 31, 2027

SPACE HIGHLIGHTS

- Large Waiting Room
- 4 Exam Rooms with Sinks
- Physician Office
- Break Room
- 3 Restrooms
- Lab

JUST STEPS AWAY FROM ORLANDO HEALTH'S ORMC



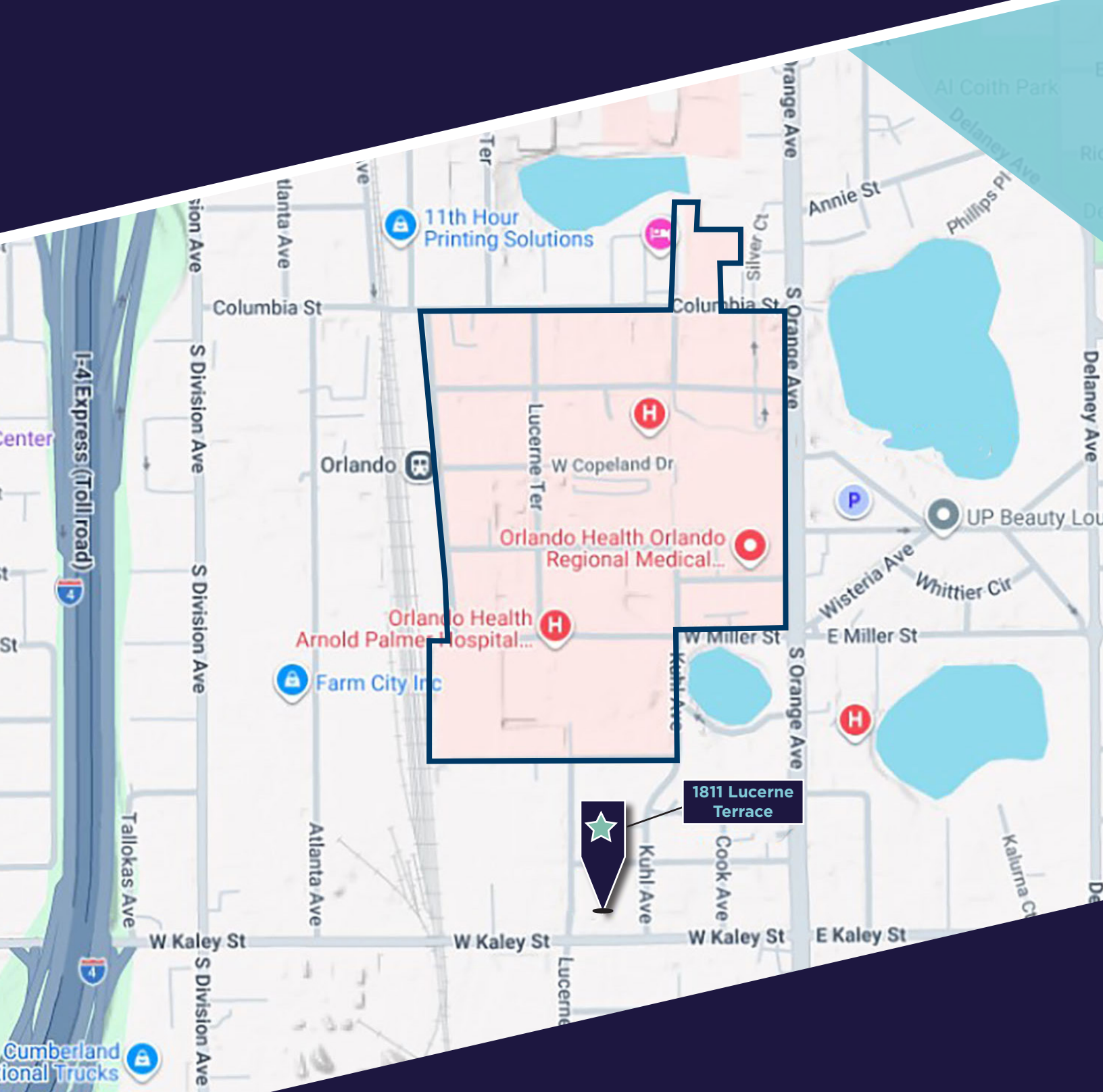

FOR MORE INFORMATION, CONTACT:

Anne Spencer, MCR
Healthcare Advisory Practice
+1 407 541 4434
anne.spencer@cushwake.com

20 N Orange Ave, Suite 300
Orlando, FL 32801
+1 407 841 8000
cushmanwakefield.com