

±1,756 SF INDUSTRIAL SUITE FOR LEASE



7739 OTHELLO AVENUE
SAN DIEGO, CA 92111

Greg Marx, SIOR
Senior Vice President | Lic.#01940696
858.458.3302 | gmarx@voitco.com

Carter Shannon
Associate | Lic.#02244724
858.458.3303 | cshannon@voitco.com

Voit
REAL ESTATE SERVICES

PROJECT FEATURES

- ±6,536 SF Building
- Bay Sizes from 1,199 SF to 1,728 SF
- Drive Around Truck Access
- 4 Grade Level Loading Doors
- 1.73/1,000 Parking Ratio
- Outstanding Freeway Access to I-805, Highway 163 and I-15



AVAILABILITY

ADDRESS	SIZE	RENT	AVAILABLE	TO SHOW	COMMENTS
7739 Othello Avenue	1,756 SF	\$2.15 Gross	April 1, 2026	Appointment. Call Broker.	25% Office/ 75% Warehouse with 1 Grade Level Door

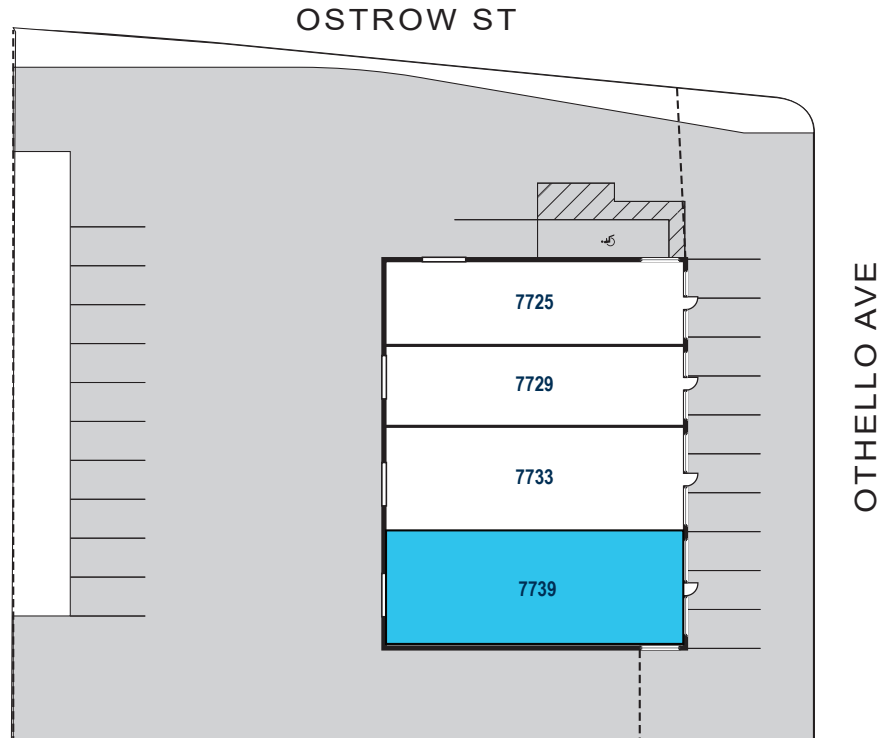

FLOOR PLAN

7739 OTHELLO AVENUE

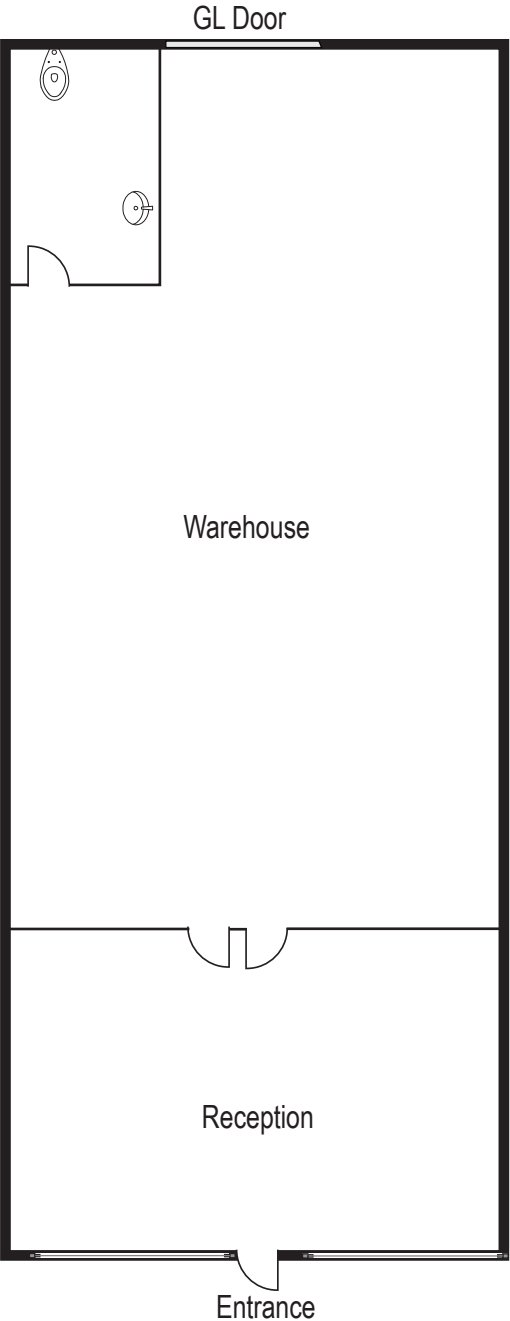

SIZE	1,756 SF
LEASE RATE	\$2.15 Gross
AVAILABLE	April 1, 2026
TO SHOW	Appointment. Call Broker.
COMMENTS	25% Office/75% Warehouse with 1 Grade Level Door.



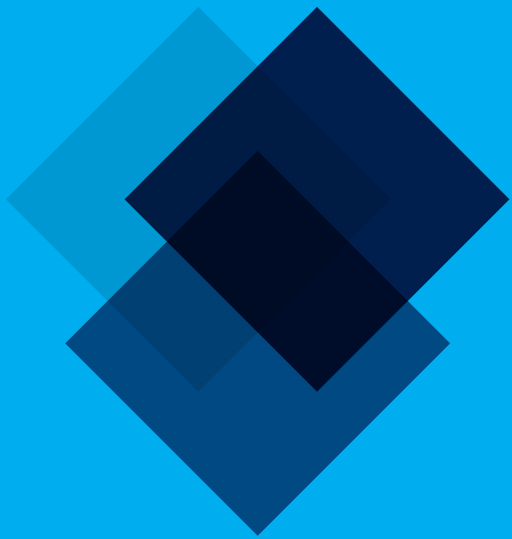

7739

OTHELLO AVENUE
SAN DIEGO, CA 92111

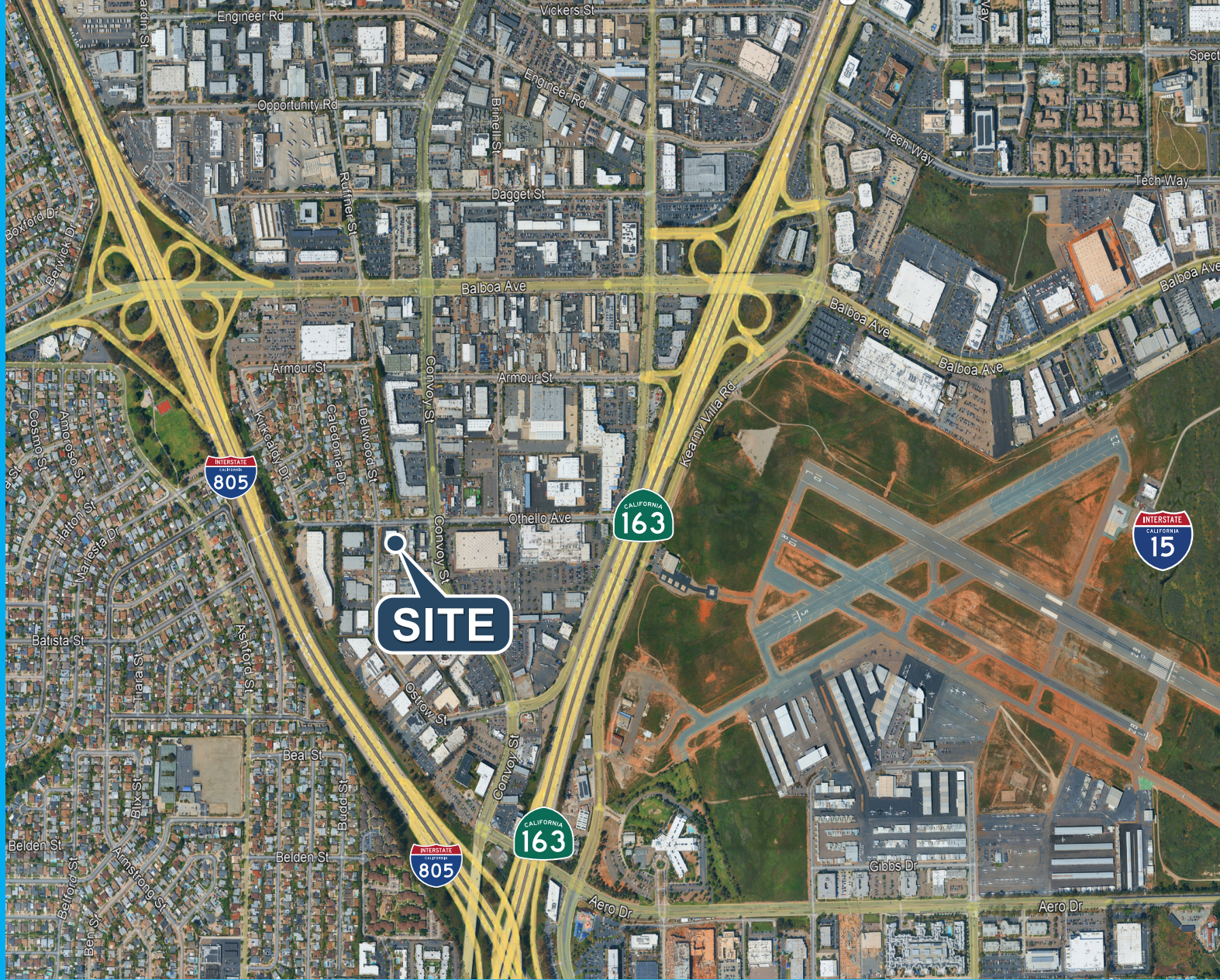

Voit

REAL ESTATE SERVICES

Greg Marx, SIOR
Senior Vice President | Lic.#01940696
858.458.3302 | gmarx@voitco.com

Carter Shannon
Associate | Lic.#02244724
858.458.3303 | cshannon@voitco.com

4180 La Jolla Village Drive, Suite 100, La Jolla, CA 92037 | Lic #01991785 | www.voitco.com

Licensed as Real Estate Salespersons by the DRE. ©2026 Voit Real Estate Services, Inc. All Rights Reserved. The information contained herein has been obtained from sources we deem reliable. While we have no reason to doubt its accuracy, we do not guarantee it.