

OFFICE/MEDICAL FOR LEASE

KISSIMMEE, FL 34741

907 Person St



### OFFERING SUMMARY

Lease Rate:	\$27.00 SF/yr (NNN)
Building Size:	4,041 SF
Available SF:	2,747 - 4,040 SF
Lot Size:	17,014 SF
Number of Units:	1-2
Year Built:	1972
Renovated:	2025
Zoning:	T5-U

### PROPERTY OVERVIEW

907 Person Street is a brand-new 4,040 SF medical office building delivered in vanilla shell condition, providing tenants the opportunity to design and build out a space that meets their exact needs. Strategically located just steps from Osceola Regional Medical Center, this property is an ideal location for physicians, specialists, and healthcare providers looking to serve the rapidly growing Kissimmee community.

### PROPERTY HIGHLIGHTS

- Available Space: 4,041± SF
- Condition: VANILLA SHELL- ready for tenant build-out - Tenant Improvement Allowance available
- Use: Medical office or professional office
- Parking: Ample surface parking for patients and staff
- Accessibility: Easy access to US-192, John Young Parkway, and Florida's Turnpike
- Visibility: Located within Kissimmee's established medical corridor
- Surrounding Amenities: Steps from hospital, pharmacies, urgent care, and other medical practices

PRESENTED BY  
**ASHLEY WALKER**  
407.430.3462  
awalker@millenia-partners.com

OFFICE BUILDING  
**For Lease**

ADDITIONAL PHOTOS

KISSIMMEE, FL 34741

907 Person St



PRESENTED BY  
**ASHLEY WALKER**  
407.430.3462  
awalker@millenia-partners.com

OFFICE BUILDING  
**For Lease**

# ADDITIONAL PHOTOS

KISSIMMEE, FL 34741

# 907 Person St

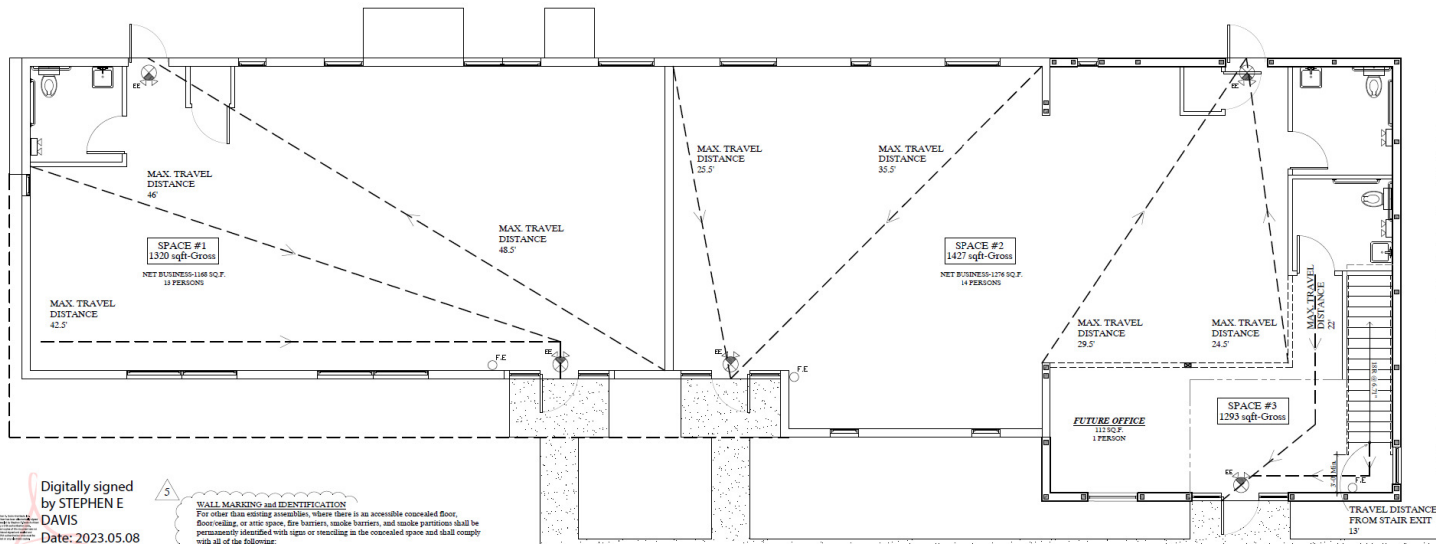

PRESENTED BY  
**ASHLEY WALKER**  
407.430.3462  
awalker@millenia-partners.com

OFFICE BUILDING  
**For Lease**

# RETAILER MAP

KISSIMMEE, FL 34741

# 907 Person St



Map data ©2026 Google Imagery ©2026 Airbus, Landsat / Copernicus, Maxar Technologies

PRESENTED BY  
**ASHLEY WALKER**  
407.430.3462  
awalker@millenia-partners.com

OFFICE BUILDING  
**For Lease**

ADDITIONAL PHOTOS

KISSIMMEE, FL 34741

907 Person St



PRESENTED BY  
**ASHLEY WALKER**  
407.430.3462  
awalker@millenia-partners.com

OFFICE BUILDING  
**For Lease**

# DEMOGRAPHICS MAP & REPORT

KISSIMMEE, FL 34741

# 907 Person St

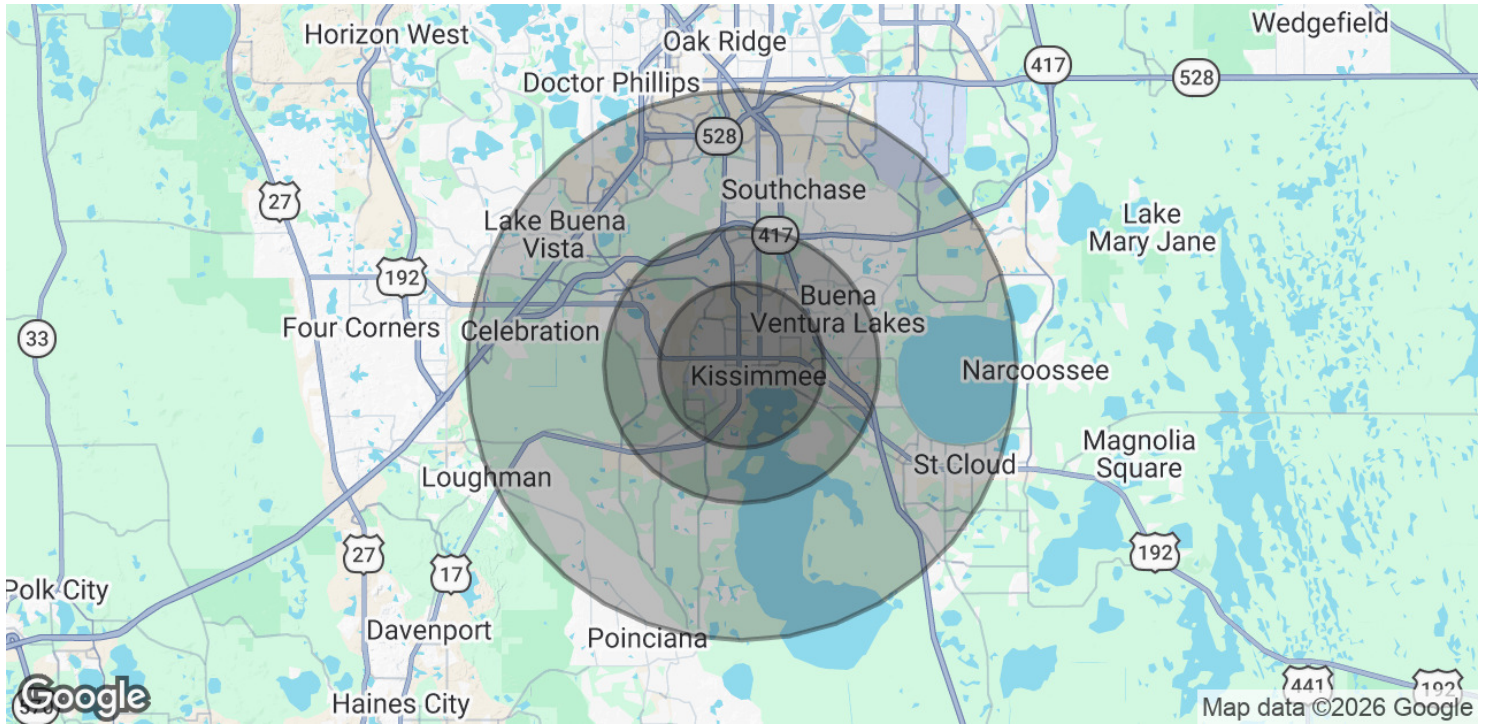

<b>POPULATION</b>	<b>3 MILES</b>	<b>5 MILES</b>	<b>10 MILES</b>
Total Population	86,503	218,797	521,818
Average Age	39	39	39
Average Age (Male)	37	38	38
Average Age (Female)	40	40	40

<b>HOUSEHOLDS &amp; INCOME</b>	<b>3 MILES</b>	<b>5 MILES</b>	<b>10 MILES</b>
Total Households	29,853	73,502	176,423
# of Persons per HH	2.9	3	3
Average HH Income	\$65,854	\$76,947	\$91,712
Average House Value	\$330,115	\$337,390	\$382,529

Demographics data derived from AlphaMap

PRESENTED BY  
**ASHLEY WALKER**  
 407.430.3462  
 awalker@millenia-partners.com

OFFICE BUILDING  
**For Lease**