



±1,304 SF Office Space For Lease in Almaden Area

**618 BLOSSOM HILL ROAD, SUITE 102
SAN JOSE, CA**

Project Highlights

- Ground Floor Unit
- Great Windowline
- Five (5) Private Offices
- Balance Open Area
- Corner Unit
- Name Slot Available on Building Monument Sign
- 3/1,000 Onsite Parking, Plus Street Parking

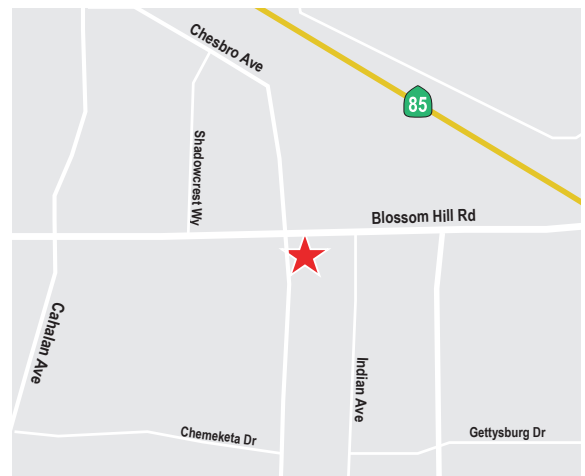

For information, please contact:

Ger Wong

Senior Managing Director

t 408-987-4134

geri.wong@nmrk.com

CA RE License #01142432

nmrk.com

NEWMARK

The distributor of this communication is performing acts for which a real estate license is required. The information contained herein has been obtained from sources deemed reliable but has not been verified and no guarantee, warranty or representation, either express or implied, is made with respect to such information. Terms of sale or lease and availability are subject to change or withdrawal without notice. 20-1282 • 02/23

Site Plan

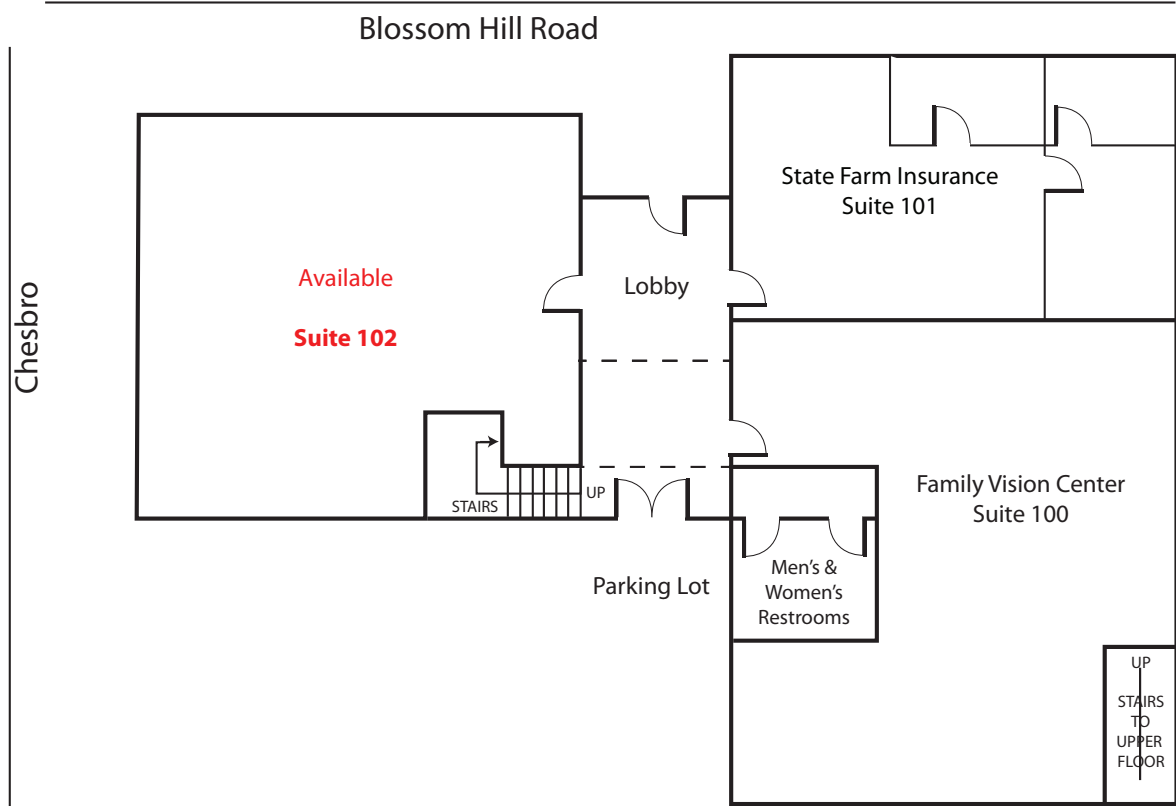

*This site plan is not drawn to scale.

For information, please contact:

Geri Wong

Senior Managing Director

t 408-987-4134

geri.wong@nmrk.com

CA RE License #01142432

nmrk.com

NEWMARK

The distributor of this communication is performing acts for which a real estate license is required. The information contained herein has been obtained from sources deemed reliable but has not been verified and no guarantee, warranty or representation, either express or implied, is made with respect to such information. Terms of sale or lease and availability are subject to change or withdrawal without notice. 20-1282 • 02/23

Site Plan



*This floor plan is not drawn to scale.

For information, please contact:

Ger Wong

Senior Managing Director

t 408-987-4134

geri.wong@nmrk.com

CA RE License #01142432

nmrk.com

NEWMARK

The distributor of this communication is performing acts for which a real estate license is required. The information contained herein has been obtained from sources deemed reliable but has not been verified and no guarantee, warranty or representation, either express or implied, is made with respect to such information. Terms of sale or lease and availability are subject to change or withdrawal without notice. 20-1282 • 02/23

Gallery



For information, please contact:

Geri Wong

Senior Managing Director

t 408-987-4134

geri.wong@nmrk.com

CA RE License #01142432

nmrk.com

NEWMARK

The distributor of this communication is performing acts for which a real estate license is required. The information contained herein has been obtained from sources deemed reliable but has not been verified and no guarantee, warranty or representation, either express or implied, is made with respect to such information. Terms of sale or lease and availability are subject to change or withdrawal without notice. 20-1282 • 02/23