

# ±1,932 SF INDUSTRIAL SPACE AVAILABLE FOR SUBLEASE

1465 30TH STREET, SUITE C, SAN DIEGO, CA 92154



DANNY ROGERS  
Lic. #02194441 | 858.458.3316  
drogers@voitco.com

**Voit**  
REAL ESTATE SERVICES



## AVAILABILITY OVERVIEW

- » Suite C: ±1,932 SF industrial suite available for sublease
- » Sublease Expiration: May 31, 2028
- » Sublease Rate: \$1.80/SF, IG
- » Available: 30-60 days notice

## DANNY ROGERS

Lic. #02194441 | 858.458.3316  
drogers@voitco.com

## PROPERTY OVERVIEW

- » 15% office with balance warehouse
- » 22' clear height
- » 1.7/1,000 SF parking ratio
- » Easy access to SR-905 and I-5
- » Located in an enterprise zone
- » Skylights and fire sprinklers
- » Adjacent to Iris Street trolley and bus station
- » 3-phase power
- » HVAC Office and Restroom

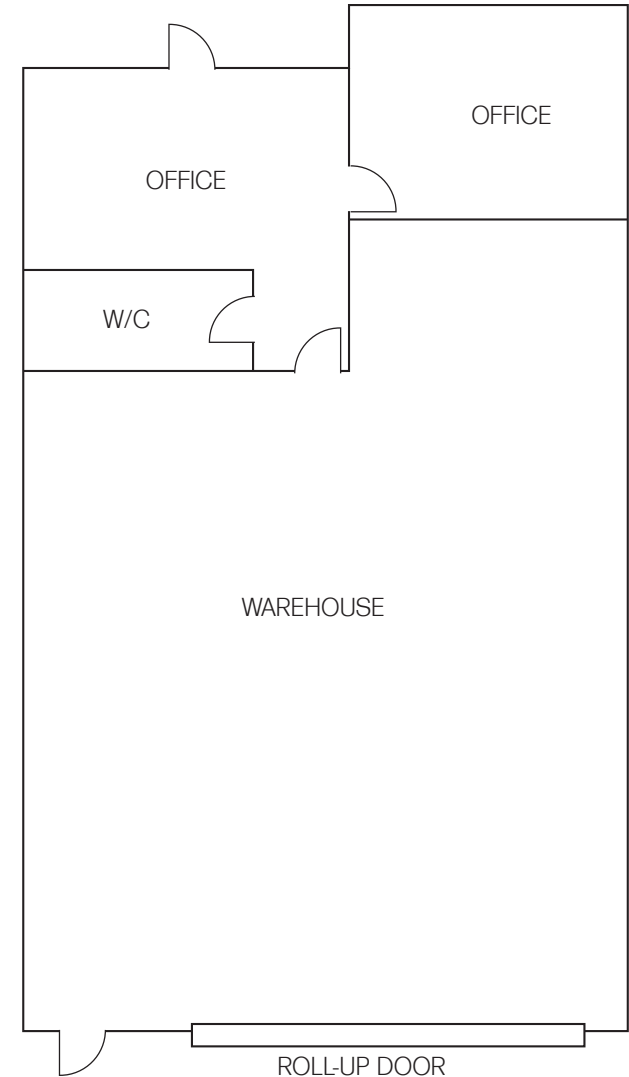

4180 La Jolla Village Drive, Suite 100, La Jolla, CA 92037 | 858.453.0505 858.408.3976 F | Lic #01991785 | www.voitco.com

Licensed as a Real Estate Salesperson by the DRE. The information contained herein has been obtained from sources we deem reliable. While we have no reason to doubt its accuracy, we do not guarantee it. ©2026 Voit Real Estate Services, Inc. All Rights Reserved.

**Voit**  
REAL ESTATE SERVICES