

17,083 SF

AVAILABLE NOW

3545 JOHN HOPKINS COURT, SUITE 250



A  BioMed Realty property |  JLL

Exclusive leasing agents:

Chad Urie
tel +1 858 410 1187
chad.urie@jll.com
RE license #01261962

Grant Schoneman
tel +1 858 410 1252
grant.schoneman@jll.com
RE license #01516695

Michelle Westoby
tel +1 858 410 1190
michelle.westoby@jll.com
RE license #01377091

3545 JOHN HOPKINS COURT

SECOND FLOOR | SUITE 250 | 17,083 SF | AVAILABLE NOW

50% Lab | 10% Vivarium | 40% Office

Office: 32 workstations, 3 private offices, phone room, 2 huddle rooms, conference room, wellness room, break room

Lab: 10 lab benches, 6 lab support rooms, 4 fume hoods, 2 cold rooms, small vivarium

VIRTUAL TOUR

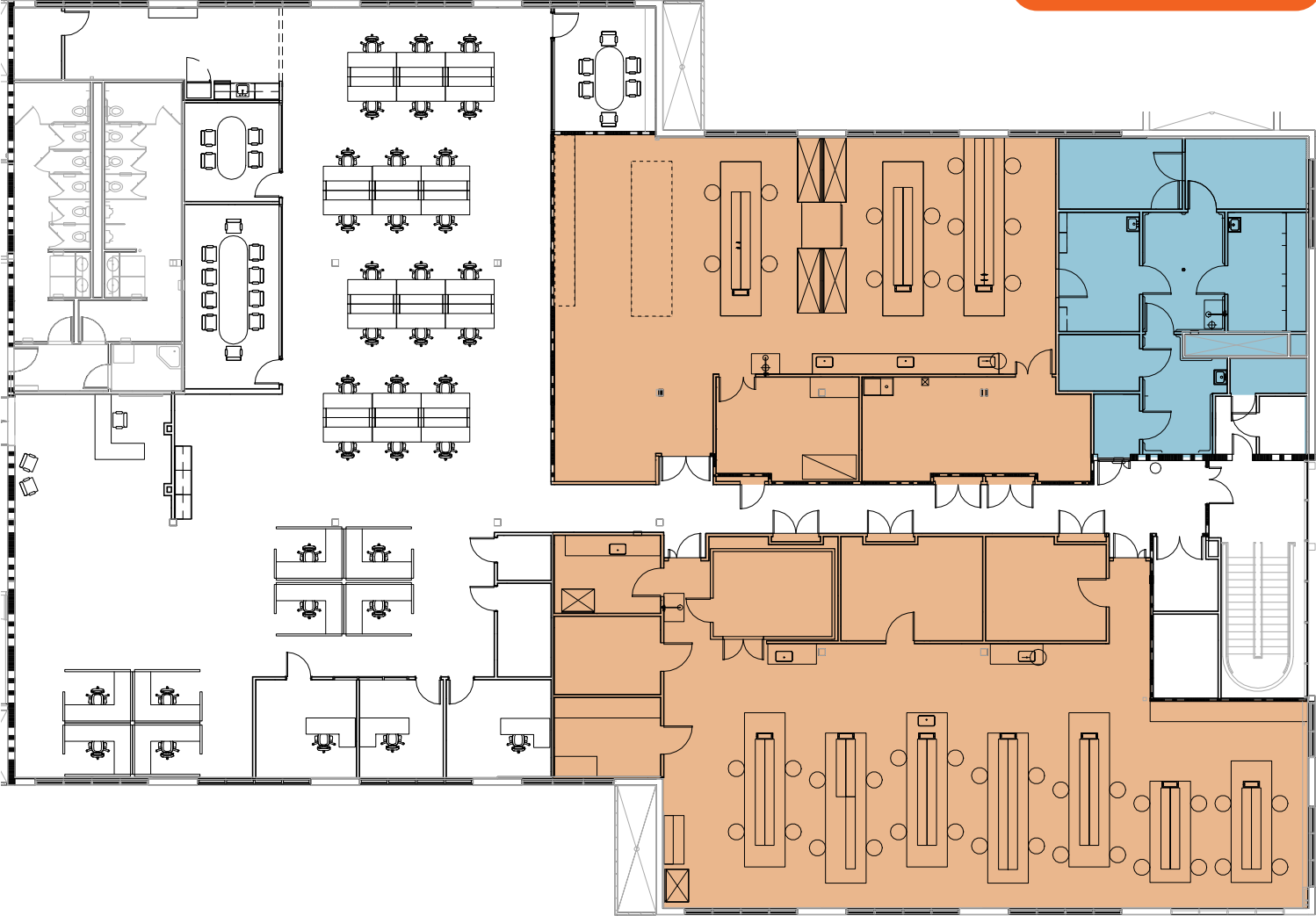



AMENITIES

- Indoor/Outdoor fitness center
- Showers and lockers
- Conference facilities
- Walkable amenities
- Easy access to freeway and public transportation

