

377 FIFTH AVENUE

5TH FLOOR SUBLEASE





BUILDING OVERVIEW

- Partial floor office opportunity
 - 5th Floor: 1,200 SF
- 24/7 Access and Private keyed elevator access
- Elevator Building
- Located in a prime Midtown location
- Close proximity to Penn Station & Grand Central Station

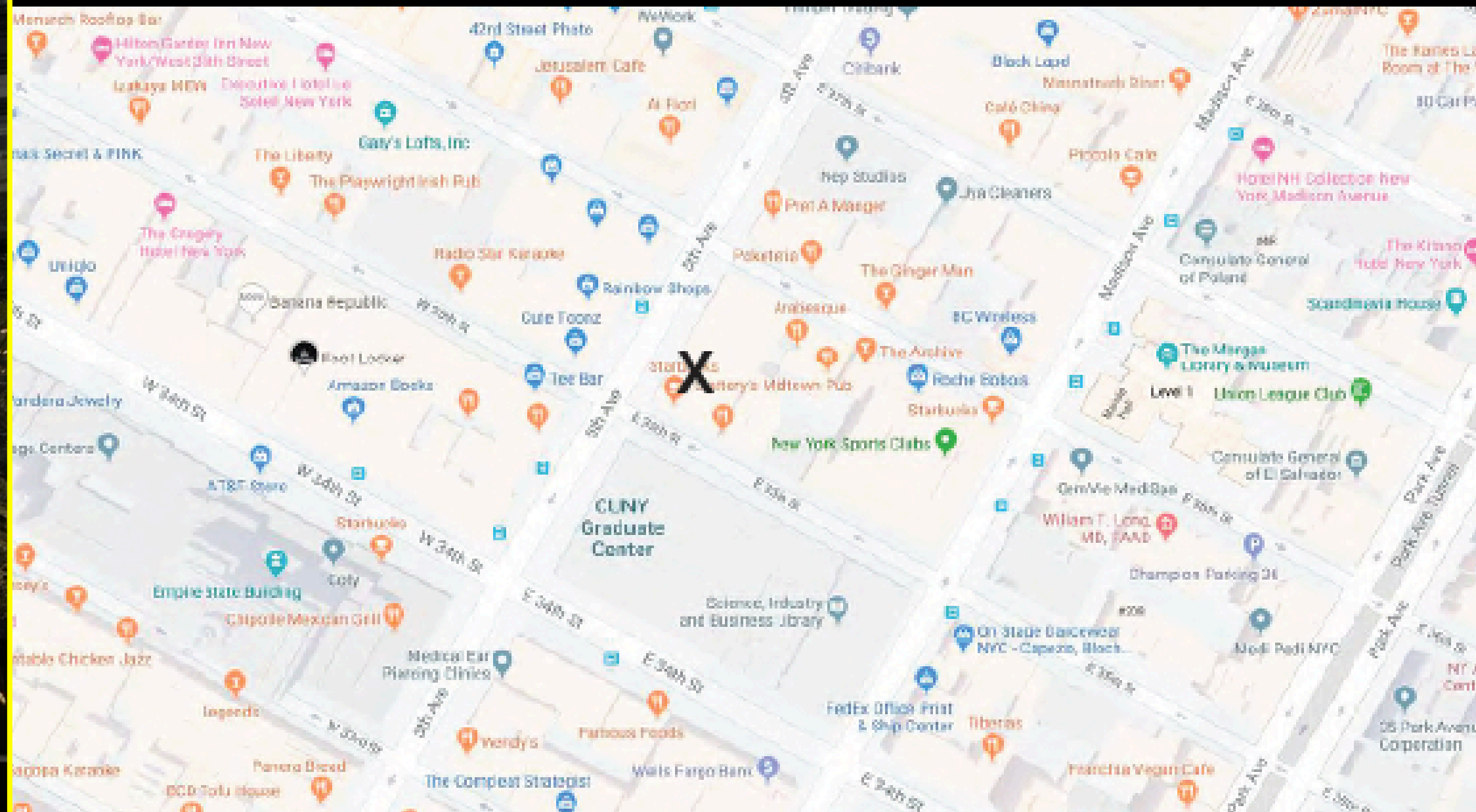

377 FIFTH AVENUE

FIFTH FLOOR

SIZE

1,200 SF

POSSESSION

Immediate

TERM

Negotiable

PRICE

Per Square Foot: \$33

Per Month: \$3,300

HIGHLIGHTS

- Shared kitchen
- Bathroom
- Two private offices
- Can come furnished or unfurnished

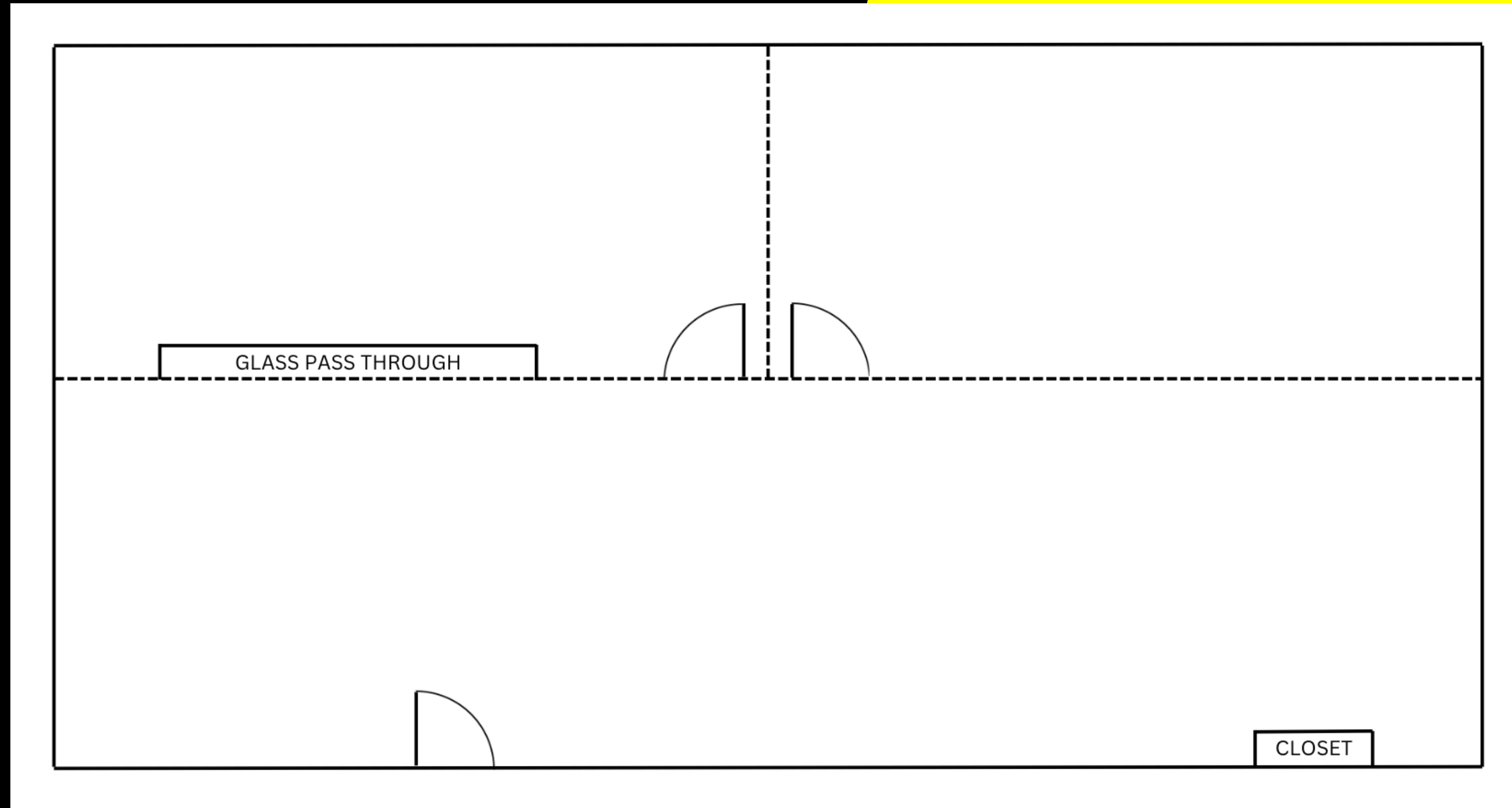

377 FIFTH AVENUE

FIFTH FLOOR



377 FIFTH AVENUE

FIFTH FLOOR





CONTACT

MICHAEL SEGERMAN

msegerman@currentadvisors.com

516.297.3337

CURRENT[®]
Real Estate Advisors