

# INDUSTRIAL SPACE FOR LEASE

2370 Eastman Ave, Unit 103, Oxnard, CA



## INDUSTRIAL SPACE AVAILABLE FOR LEASE

For More Information  
Please Contact:

### GRANT HARRIS

805.626.1212  
gharris@lee-re.com  
Lic # 01029619

### JOHN OCHOA, SIOR

805.626.1208  
jochoa@lee-re.com  
www.johnchoa-re.com  
Lic # 00986604



COMMERCIAL REAL ESTATE SERVICES

Lee & Associates - LA North/Ventura, Inc.  
Corporate ID #01191898  
A Member of the Lee & Associates  
Group of Companies  
2775 N Ventura Road, Suite 201  
Oxnard, CA 93036  
www.lee-associates.com

No warranty or representation is made to the accuracy of the foregoing information. Terms of sale or lease and availability are subject to change or withdrawal without notice.

### PROPERTY HIGHLIGHTS

- Well Maintained Multi-Tenant Industrial Building
- M-1 Zoned | Multiple Uses
- 1 Block Off Rice Avenue
- 2 Ground Level Doors

### PROPERTY FEATURES

AVAILABLE SF .....	2,000 SF
TOTAL SF .....	2,000 SF
OFFICE SF .....	TBD
LOADING .....	(2) GL (12'w x 12'h)
CLEAR HEIGHT .....	15.5 Feet
POWER .....	200 Amps 120/208
PARKING .....	4 Spaces
YEAR BUILT .....	2004
ZONING .....	M1
LEASE RATE* .....	\$1.45/SF MG

\*\$0.14 per square foot monthly Common Area Maintenance (CAM) fee in addition to lease rate.

Tenant to verify all information.

# INDUSTRIAL SPACE FOR LEASE

2370 Eastman Ave, Unit 103, Oxnard, CA

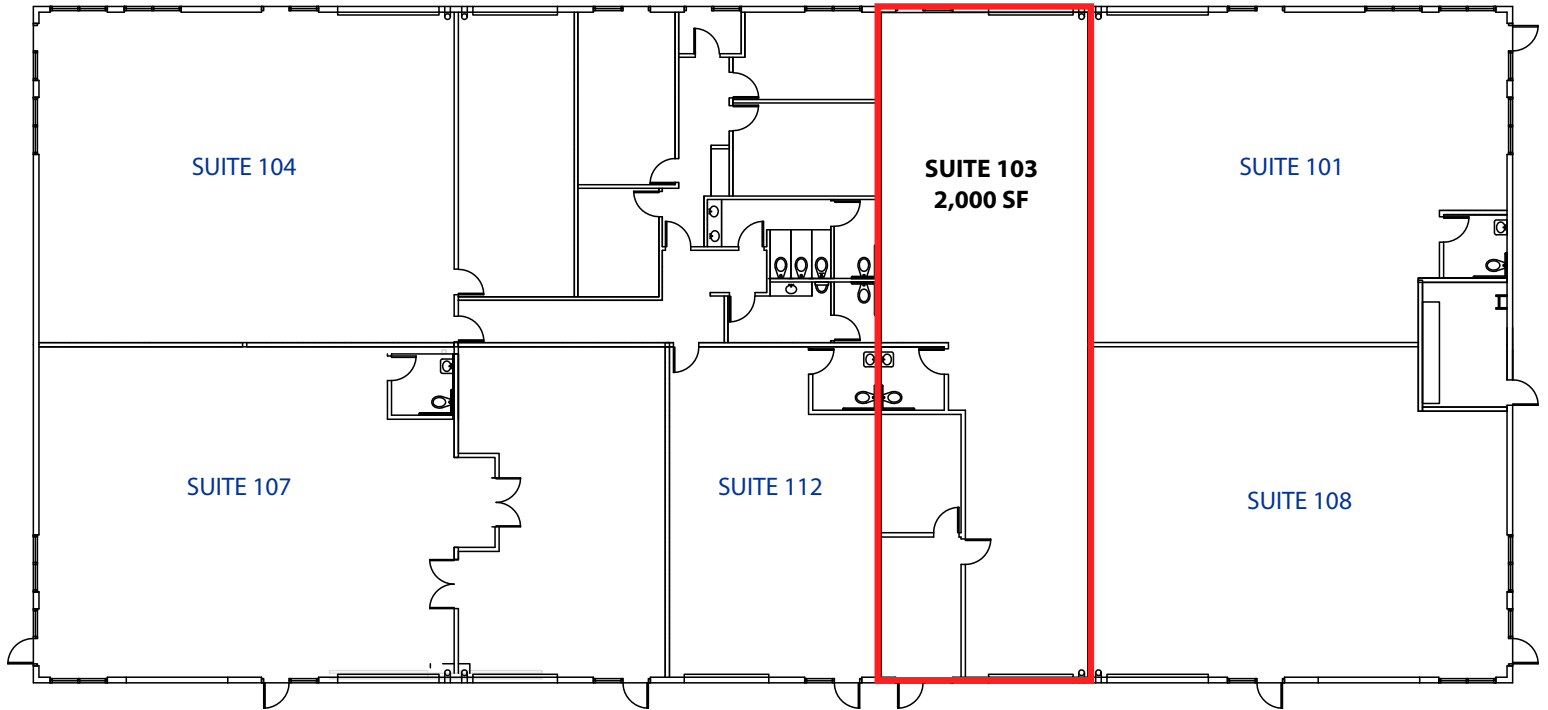

**GRANT HARRIS**  
805.626.1212  
gharris@lee-re.com  
www.gharris-re.com  
Lic # 01029619

**JOHN OCHOA, SIOR**  
805.626.1208  
jochoa@lee-re.com  
www.johnchoa-re.com  
Lic # 00986604

**LEE & ASSOCIATES**  
COMMERCIAL REAL ESTATE SERVICES