



Medical Office Space

Kevin Fenenbock

Senior Executive Vice President
Lic. 01165115
818.325.4118
kevin.fenenbock@colliers.com

Jacob Mumper

Senior Vice President
Lic. 01908862
818.325.4119
jacob.mumper@colliers.com



Colliers

6324 Canoga Ave., Suite 100
Woodland Hills, CA 91367
www.colliers.com

For Lease

Building Highlights

- Address: 6840-6850 Sepulveda Blvd.
- On-Campus Medical Office Space For Lease
- Parking: Secured Surface & Structure
- Conveniently Located Near the 101 and 405 Freeways
- Additional Retail Amenities Within Walking Distance
- Tenant Improvement Allowance Available

Availabilities



Suite	Size	Notes
220	227	Negotiable
*216	972	Negotiable
*214	1,220	Negotiable
*200	1,819	Negotiable
*210	1,984	Negotiable
211	2,789	Negotiable

*Suites 200, 210, 214 & 216 are contiguous totaling 5,995 SF

Floor Plan

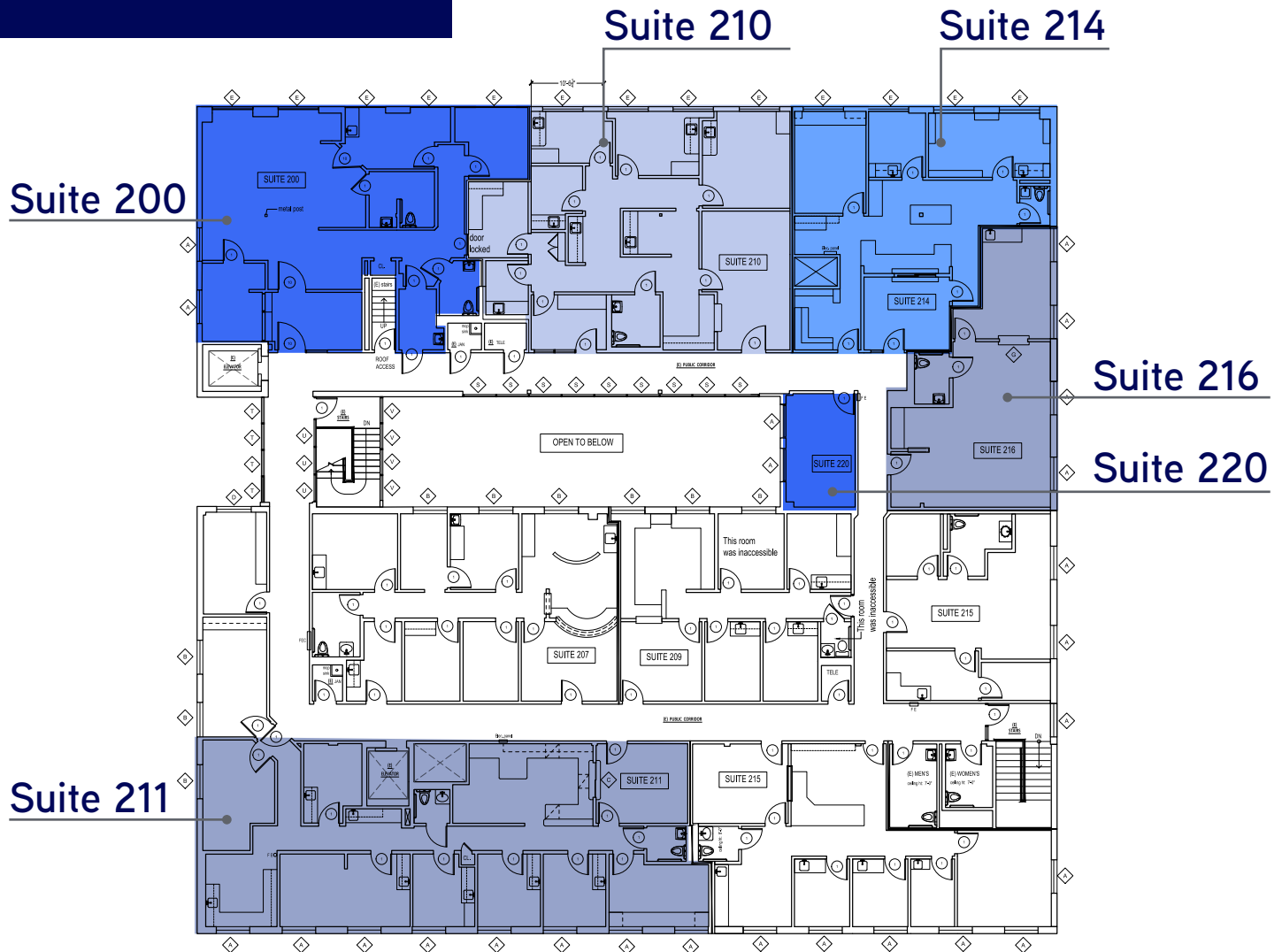

Suites 200, 210, 214 & 216 are contiguous totaling 5,995 SF

This document/email has been prepared by Colliers for advertising and general information only. Colliers makes no guarantees, representations or warranties of any kind, expressed or implied, regarding the information including, but not limited to, warranties of content, accuracy and reliability. Any interested party should undertake their own inquiries as to the accuracy of the information. Colliers excludes unequivocally all inferred or implied terms, conditions and warranties arising out of this document and excludes all liability for loss and damages arising there from. This publication is the copyrighted property of Colliers and/or its licensor(s). © 2025. All rights reserved. This communication is not intended to cause or induce breach of an existing listing agreement. Colliers International Greater Los Angeles, Inc.

Contact us:

Kevin Fenenbock
Senior Executive Vice President
Lic. 01165115
818.325.4118
kevin.fenenbock@colliers.com

Jacob Mumper
Senior Vice President
Lic. 01908862
818.325.4119
jacob.mumper@colliers.com



Colliers
6324 Canoga Ave., Suite 100
Woodland Hills, CA 91367
www.colliers.com