



# TOWER PLACE

1 & 2 Tower Place  
South San Francisco



[towerplace-ssf.com](http://towerplace-ssf.com)

**CBRE**

 **VENTAS**



# An Evolved Standard

Everything in the Tower Place experience is designed to enable you to do what you do best, without distraction or delay.

We equip you with all you need to support your science, from high quality lab space to complimentary research design and an on-site vivarium partner.

Our intelligently designed floorplates maximize the lab in your lab space, and a committed life-science focus cultivates easy cross-collaboration in our ample community spaces. We support you at your foundation, so that you can **make your science superior.**

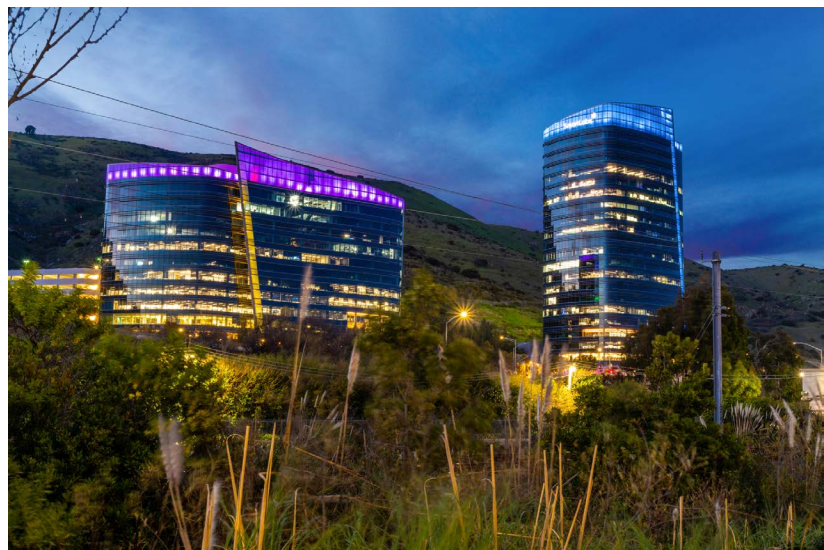
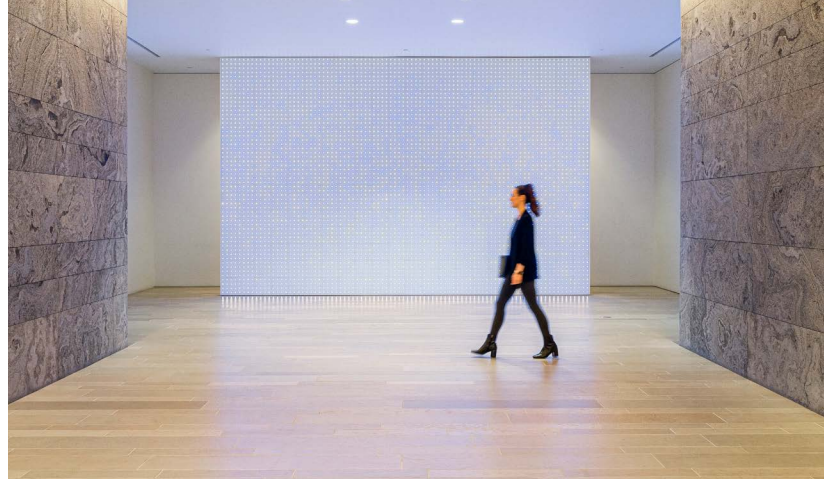

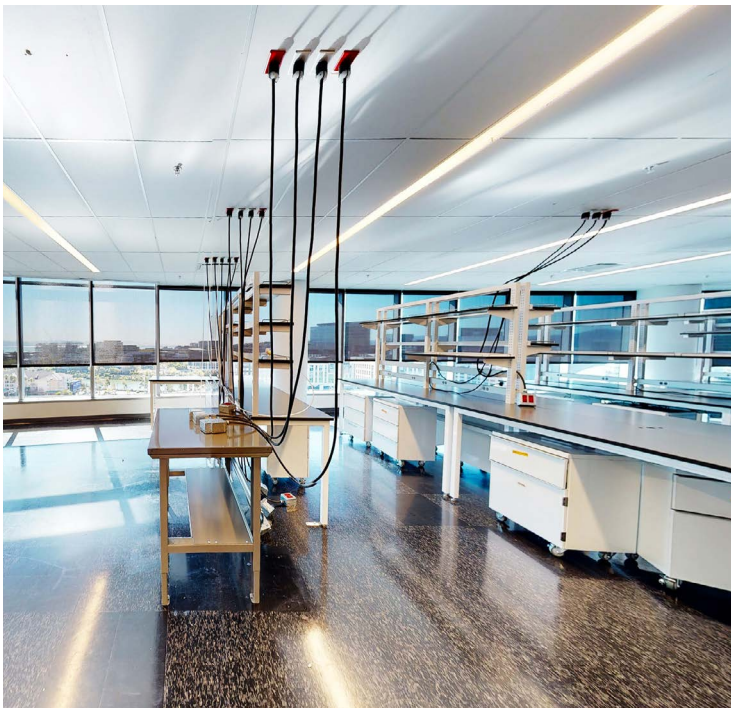



# Make Your Science Superior

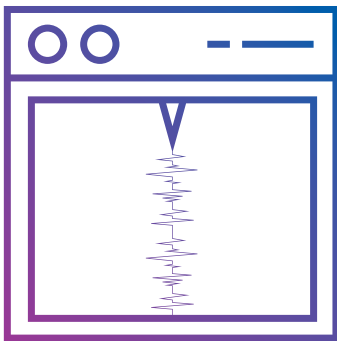

## Structural

- 100 psf live load capacity
- 8,000+ MIPS vibration criteria

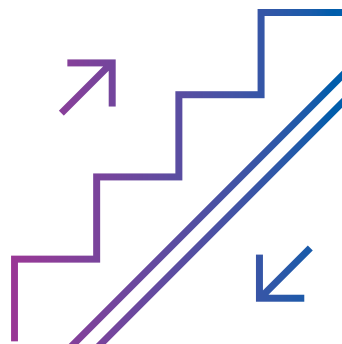

## Architectural

- Class-A office with conference rooms and furniture
- Internal stairways connecting floors 9 - 12

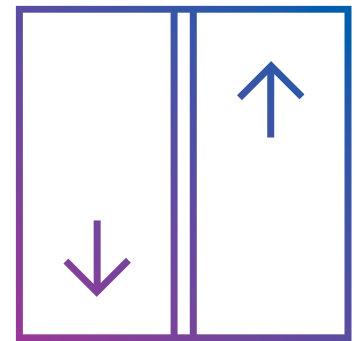

## Vertical Transportation

- (5) passenger elevators
- (1) 5,000 lbs rated freight elevator

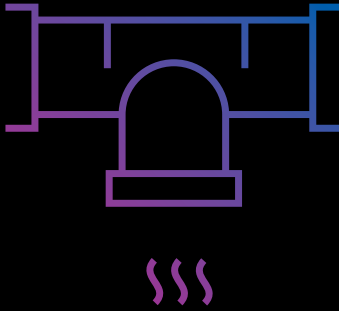

### Plumbing

- Lab waste and vent risers installed with cap connections at each floor

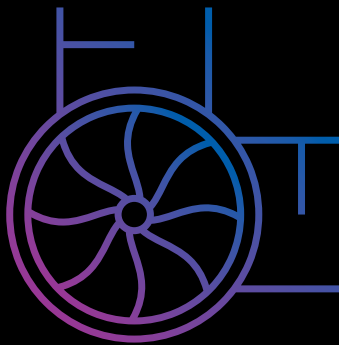

### Mechanical

- 100% outside air AHUs for labs on each floor
- Up to 57% of floor plates for wet lab use
- Laboratory Exhaust Fans (LEFs) with partial redundancy and on standby power
- Supplemental 24/7 cooling
- BMS system (designed to integrate w/ tenant-provided BMS)

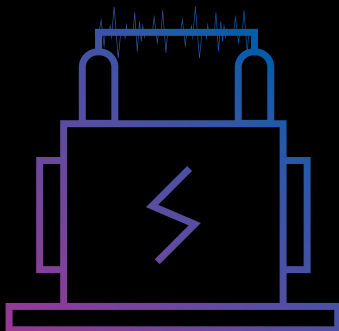

### Electrical

- Four (4) existing generators
- Each building has 2 generators providing 600kW for tenant optional standby plug loads
- 10VA/sf normal power & 10VA/sf available on standby power for lab spaces



# Science Meets Style

We've upended the typical industrial sprawl of life-science spaces and created a cutting-edge, high-rise luxury experience.



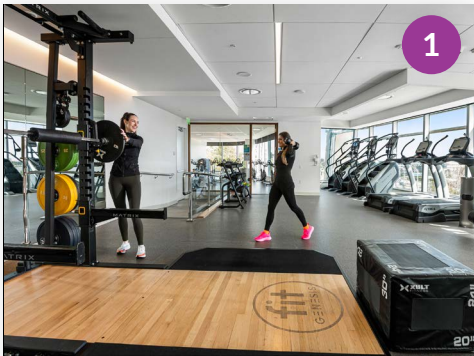

1

**Full-service Fitness Center**  
24-hour access for tenants



2

**Chico-Marx**  
Sophisticated dining with  
Spain & Latin America flavors



3

**Focaccia**  
On-site breakfast, lunch, and  
catering options



4

**Conferecing Center**  
Small/large conference  
rooms and a training room



5

**Performing Arts Center**  
~230 seat auditorium

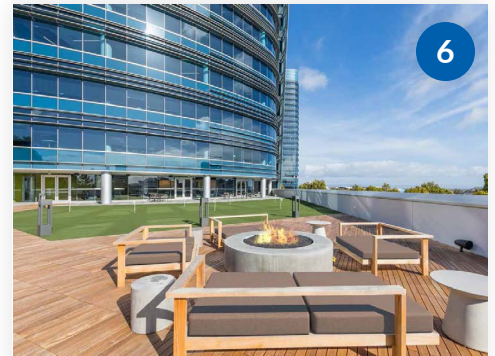

6

**Tenant Lounge & Patio**  
Private outdoor terrace &  
lounge with amazing views



7

**Stunning Art Installations**  
Including 24' sculpture by  
artist Marco Cochrane



8

**Butterfly Kiosk**  
Celebrating SSF's "official"  
butterfly, the Mission Blue

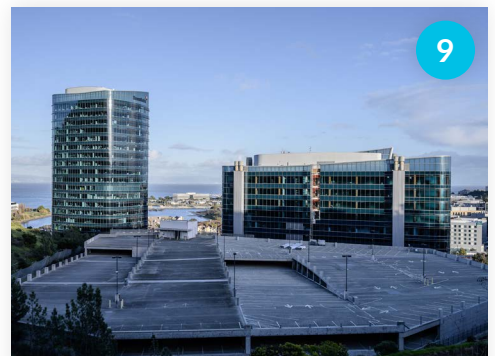

9

**7-Story Parking Garage**  
2,050 spaces (2.9/1,000 RSF)  
and EV chargers



# Get More Lab in Your Lab Space

Tower Place is 100% dedicated to life science research so that you can reap the benefits of a completely focused environment.

 Available Space

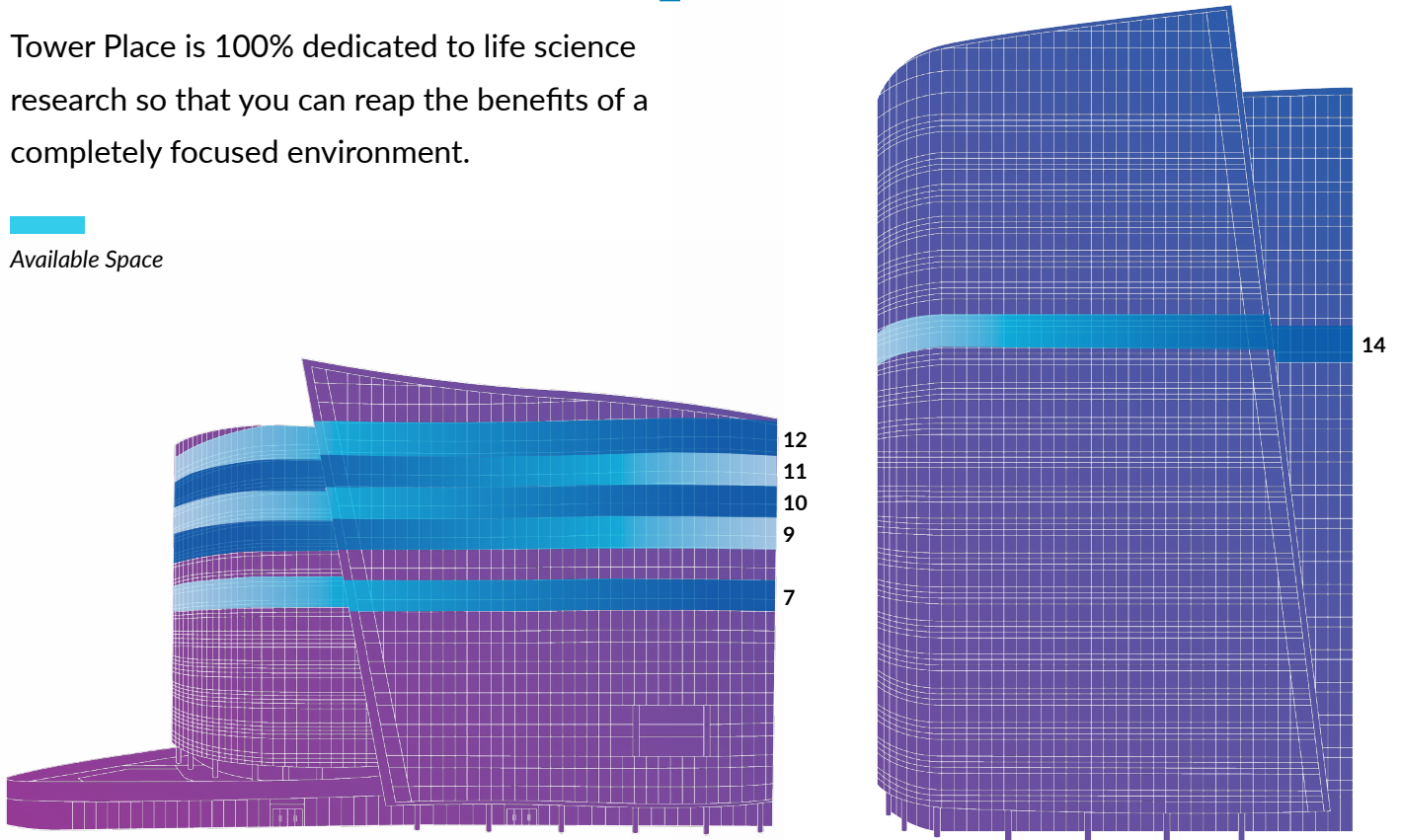

One Tower Place

Two Tower Place



New & purpose-built infrastructure — providing accelerated occupancy and research efficiency.



Fully qualified and balanced mechanical, electrical, and plumbing for laboratory use.

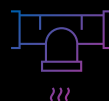

New lab build-out and on-site vivarium provider.



Shipping/receiving concierge with dedicated 1st floor hazmat storeroom & dry storage

# It Only Happens Here

Elite availability that includes SmartLabs services

**SmartLabs** 

## Premium Support Includes:



Fast-Track your Science with Shared Facility Resources.



Scalable Growth and Flexibility Integrated With Your Process Development Workflow.



Operational Support Meticulously Designed to Facilitate all Technology Transfers Between Scientific Teams.







# ±14,997 SF

## 7th Floor

One Tower Place

As-Built

- Biology lab
- Tissue culture suite
- (1) 6FT fume hood
- House gases: Vac, Co2, O2
- Break Room
- (2) Conference rooms
- (3) Private offices
- Open office area

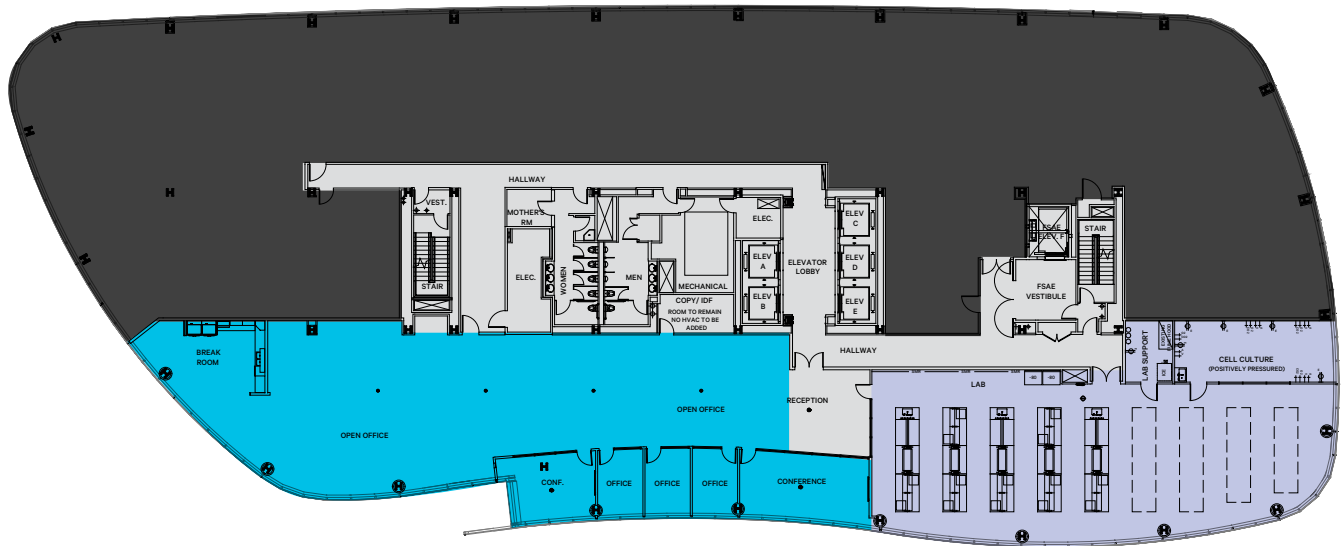

■ OFFICE  
■ LAB & LAB SUPPORT



As-Built Lab Space in Suite

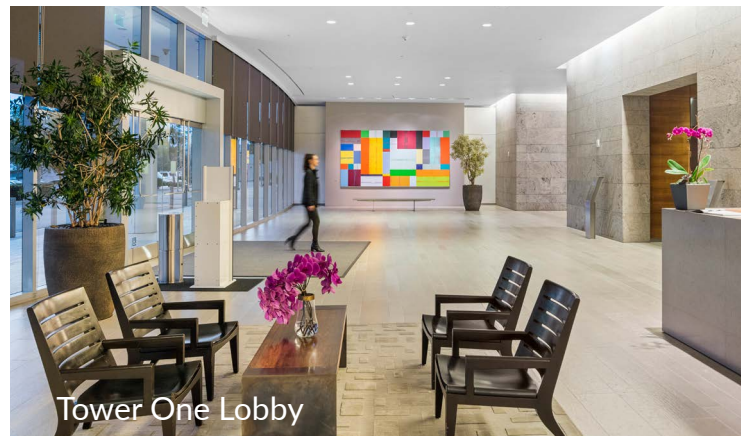

Tower One Lobby

# ±12,735 SF

## 14th Floor

Two Tower Place

As-Built

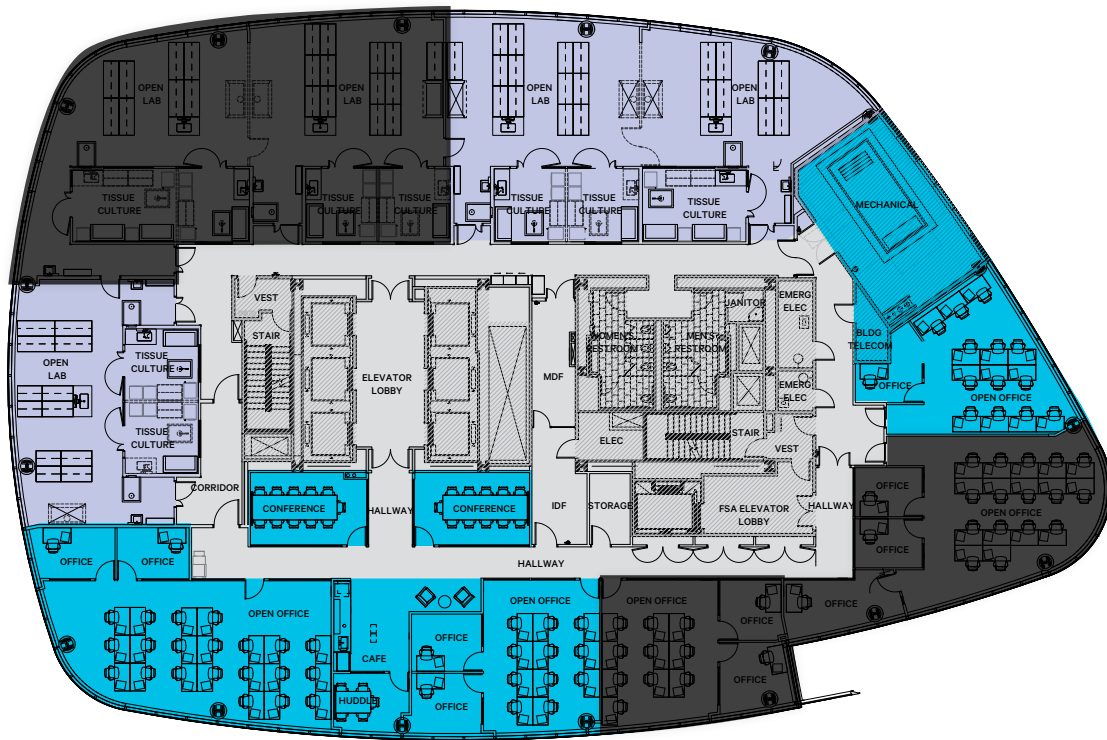

- Biology lab
- Tissue culture suites
- (4) 6FT fume hoods
- House gases: Vac and CDA
- Cafe/Break room
- (2) Conference rooms
- (6) Private office/huddle rooms
- Flexible office areas - can be demised or open design



Chico Marx



Tower Two Conferencing Center

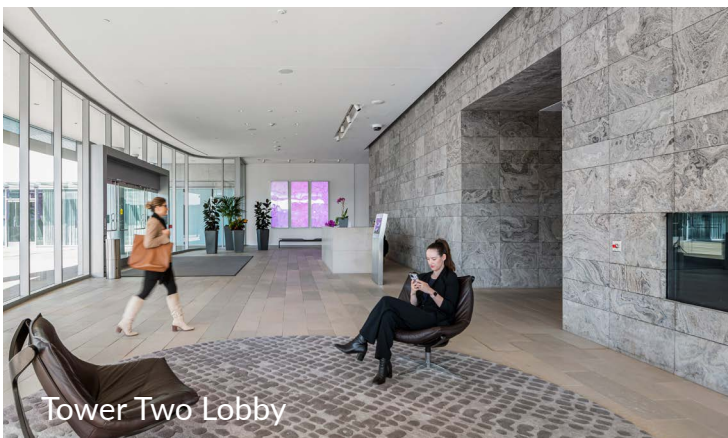

Tower Two Lobby



Tower Two Full-service Fitness Center

LOCATION



- ±5 min to SFO
- ±13 min to Downtown San Francisco
- ±15 min to San Mateo Bridge
- ±25 min to Silicon Valley/East Bay
- ±30 min to Oakland International Airport
- ±40 min to San Jose International Airport



BART Shuttle



CalTrain Shuttle



Ferry Shuttle



# Unmatched Access for Seamless Collaboration



### Ownership

Ventas is an established partner in the life sciences, with investments in forty-three properties from Cambridge to San Francisco.

Featuring 17 partnerships with top-tier research universities and a 10M SF portfolio, we're ready to draw from our breadth of experience to support your next endeavor, whether you need a ready-made lab or a specialized space, and again when your needs change.



TRANSWESTERN®

### Property Management

Transwestern does business differently by empowering our team members with the resources and independence to deliver extraordinary results.

# Unlocking the Power of Research and Universities

**ASU** Arizona State University

**Berkeley**  
UNIVERSITY OF CALIFORNIA



**Duke**  
UNIVERSITY



ILLINOIS INSTITUTE OF TECHNOLOGY



**Stanford**

**UCSF**

UNIVERSITY of MARYLAND BALTIMORE

**U** UNIVERSITY OF MIAMI



**WAKE FOREST**  
UNIVERSITY

**Washington**  
University in St. Louis

**Yale**

Ventas properties are strategically located around top research universities across the country.



© 2026 CBRE, Inc. This information has been obtained from sources believed reliable. We have not verified it and make no guarantee, warranty or representation about it. Any projections, opinions, assumptions or estimates used are for example only and do not represent the current or future performance of the property. You and your advisors should conduct a careful, independent investigation of the property to determine to your satisfaction the suitability of the property for your needs. Photos herein are the property of their respective owners and use of these images without the express written content of the owner is prohibited.



**TOWER  
PLACE**

**1 & 2 Tower Place  
South San Francisco**

The life sciences constantly redefine the frontiers of possibility and set ever higher standards.

**We believe life science spaces should evolve to meet them.**

# Schedule your tour today.

**Dino Perazzo**

Vice Chairman

Lic. 01220613

C +1 415 310 2652

[dino.perazzo@cbre.com](mailto:dino.perazzo@cbre.com)

**Lauren Cicisly**

Associate

Lic. 02166803

+1 408 310 9243

[lauren.cicisly@cbre.com](mailto:lauren.cicisly@cbre.com)

