

PARKING SUMMARY / LEGEND	
TOTAL PARKING:	160 SPACES
TOTAL FRONT FIELD PARKING:	108 SPACES
CORE FRONT FIELD PARKING:	90 SPACES

PARKING SUMMARY / LEGEND	
TOTAL PARKING:	160 SPACES
TOTAL FRONT FIELD PARKING:	108 SPACES
CORE FRONT FIELD PARKING:	90 SPACES

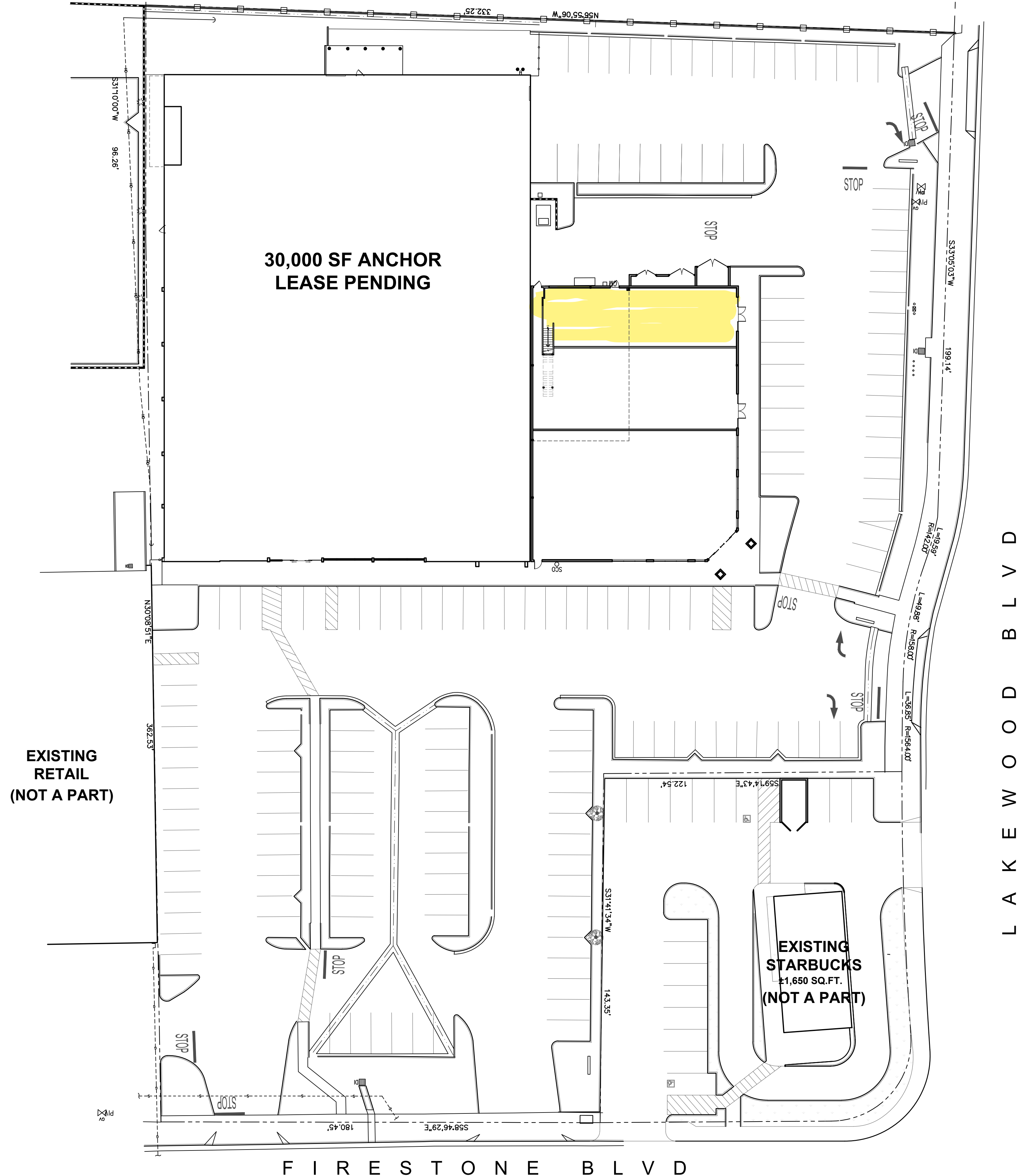

## SITE PLAN

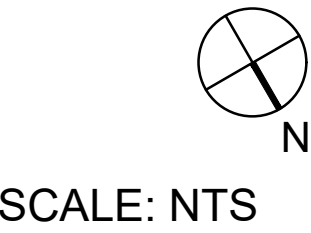

SCALE: NTS

**FIRESTONE CENTER  
PROPERTIES, LLC**  
714 S PLYMOUTH BLVD.  
LOS ANGELES, CA 90005

This plan and concept drawings are property of AMOR ARCHITECTURAL CORPORATION. This drawing is loaned without other consideration than the agreement and condition that it is not to be reproduced, copied, or otherwise disposed of, directly or indirectly, and is not to be used in whole or in part to assist in making or to furnish any information for the making of drawings, prints, apparatus or parts thereof. The acceptance of this drawing will be construed as an acceptance of the foregoing conditions and as an admission of the exclusive ownership of the plan and concept drawings of AMOR ARCHITECTURAL CORPORATION. This is a conceptual plan only and is not for construction. AMOR ARCHITECTURAL CORPORATION makes no suggestion or representation to be used.

## EXISTING PARKING LAYOUT

9018 FIRESTONE BLVD,  
DOWNEY, CA 90241

A2429

2025.04.17

9431 HAVEN AVE, SUITE 212  
RANCHO CUCAMONGA, CA 91730

909.259.9971 TEL.  
909.944.8409 FAX.

www.AmorArch.com

Corporation

# AS1.0

© 2025 AMOR ARCHITECTURAL CORPORATION - All Rights Reserved