

# TAYLOR CREEK HOLDINGS

511-545 NE 32ND STREET, OAKLAND PARK, FL 33334

535A NE 32ND STREET



## SPACE HIGHLIGHTS

- 1,843 SF
- 100% air conditioned space
- Newly renovated
- LED lighting
- 247 SF office
- 10' x 10' grade level overhead door
- 3 phase power
- Private restroom
- 11' clear ceiling in warehouse



### ANGIE WEAVER

Lauderdale Lakes and Lauderdale Manager  
Direct: 954.485.9200 | Cell: 917.645.2339  
angie@levyrai.com

### HALEY PRESSER

Property Manager / Sales Associate  
Direct: 954.485.9200 | Cell: 954.254.5396  
Haley@levyrai.com



# TAYLOR CREEK HOLDINGS

511-545 NE 32ND STREET, OAKLAND PARK, FL 33334

## 535A NE 32ND STREET FLOOR PLAN

### TAYLOR CREEK HOLDINGS

535-A NE 32nd Street | Oakland Park, FL 33334

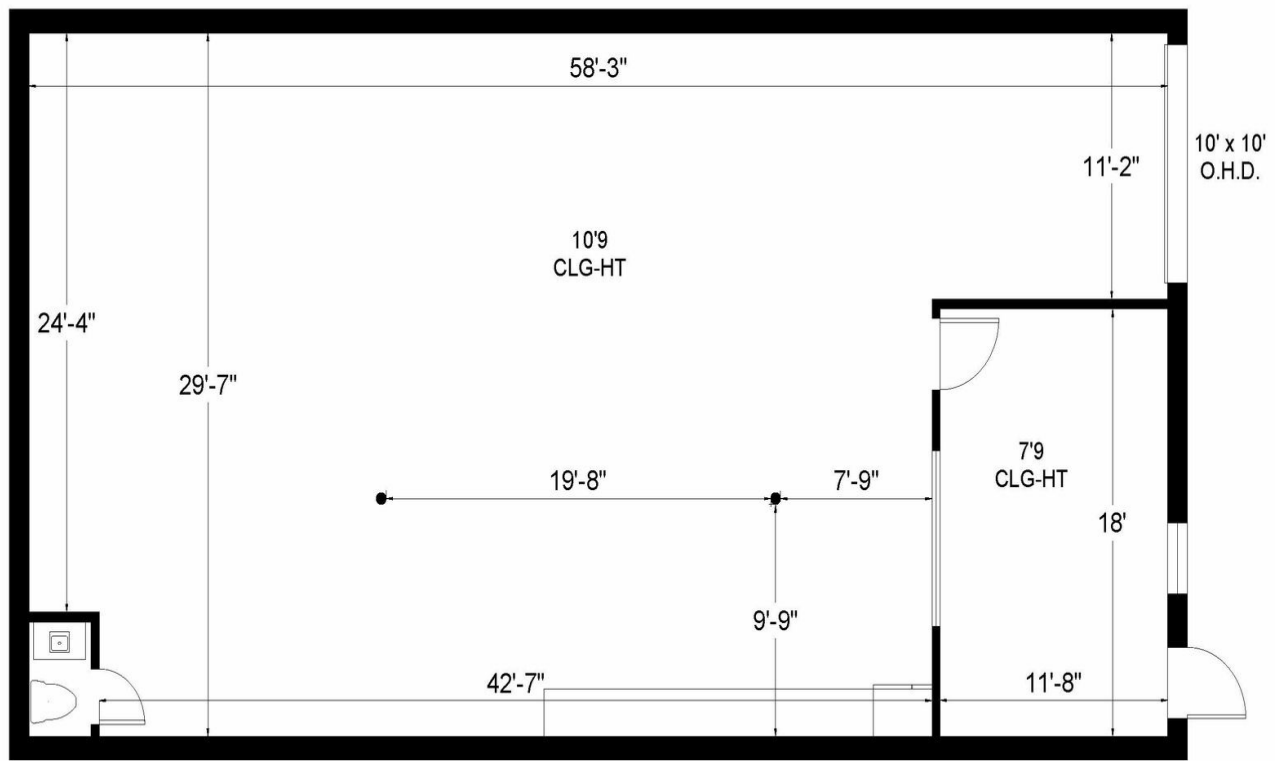

Office - 247 Sq. Ft.  
Warehouse - 1,596 Sq. Ft.

1,843 Rentable Sq. Ft.  
[www.LevyRealtyAdvisors.com](http://www.LevyRealtyAdvisors.com)

**ANGIE WEAVER**  
Lauderdale Lakes and Lauderhill Manager  
Direct: 954.485.9200 | Cell: 917.645.2339  
angie@levyrai.com

**HALEY PRESSER**  
Property Manager / Sales Associate  
Direct: 954.485.9200 | Cell: 954.254.5396  
Haley@levyrai.com

