

The existing conditions information included here is for planning purposes only. It is not intended to be used for construction or construction quantity take-offs. Prior to any demolition, redesign, or construction modifications of this space, additional on-site inspections should be completed to verify the information included here, as well as to locate, identify and evaluate all existing utilities and structural components.

# Units 11, 12, & 13 Existing Floor Plans

## 2390 NORTH FOREST ROAD GETZVILLE, NY 14068

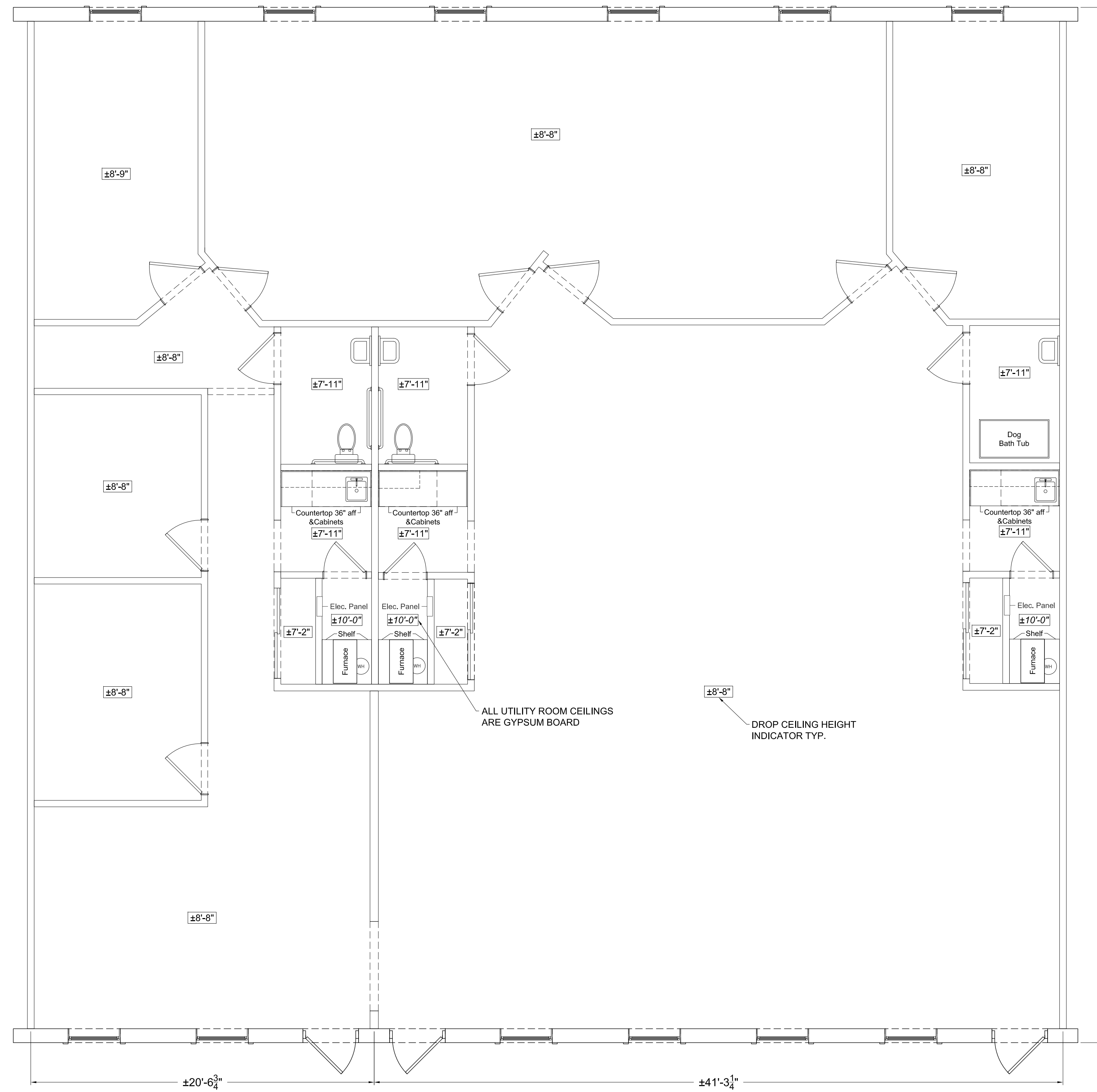

**Floor Plan**  
Scale: 1/4" = 1'-0"