

255 Norman

Lachine, (Québec) H8R 1A3

À LOUER / FOR LEASE

Immeuble Industriel / Industrial Building



Détails du bâtiment / Building details

Espace Bureaux & Industriel disponible Office & industrial sf available minimum	65,000 pi ² /sf
Distance à l'aéroport Trudeau Distance to Trudeau airport	8 Minutes
Hauteur libre Ceiling height	9' - 22'
Quai de chargement Loading dock	4
Rampe d'accès Drive-in ramp	2
Stationnement intérieur Indoor parking	
Accès directs aux autoroutes 40, 20, 13 et Côte-de-Liesse Direct access to highways 40, 20, 13 and Côte-de-Liesse	



Steven Glazer

C: 514.983.9002

T: 514.933.5112 #262

sglazer@groupereshapiro.com

Gabrielle Gervais

C: 514.549.1153

T: 514.933.5112 #230

ggervais@groupereshapiro.com

Jeff Rosenberg

C: 514.947.5117

T: 514.731.7547

jrosenberg@groupereshapiro.com

GROUPE SHAPIRO

800 Place Victoria, #440, Montréal, Qc, H4Z 1E8

www.groupereshapiro.com



255 Norman

Lachine, (Québec) H8R 1A3

À LOUER / FOR LEASE

Immeuble Industriel / Industrial Building

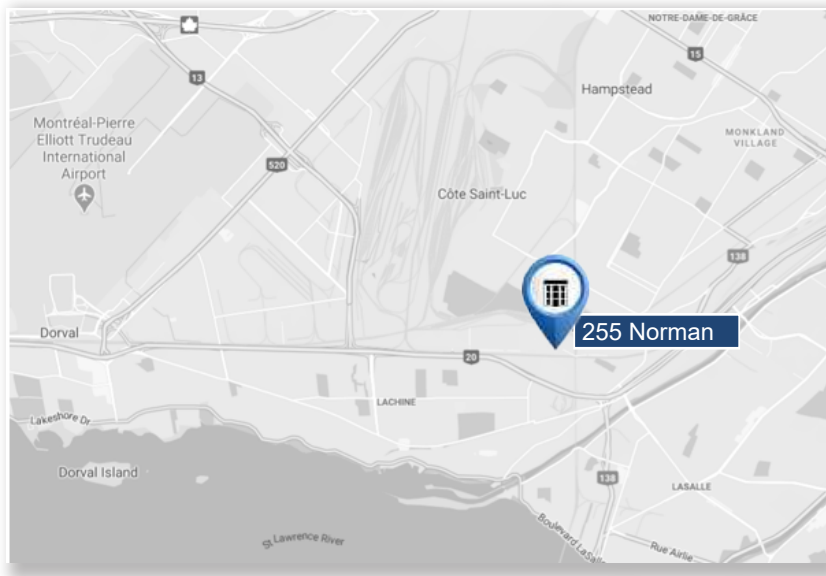
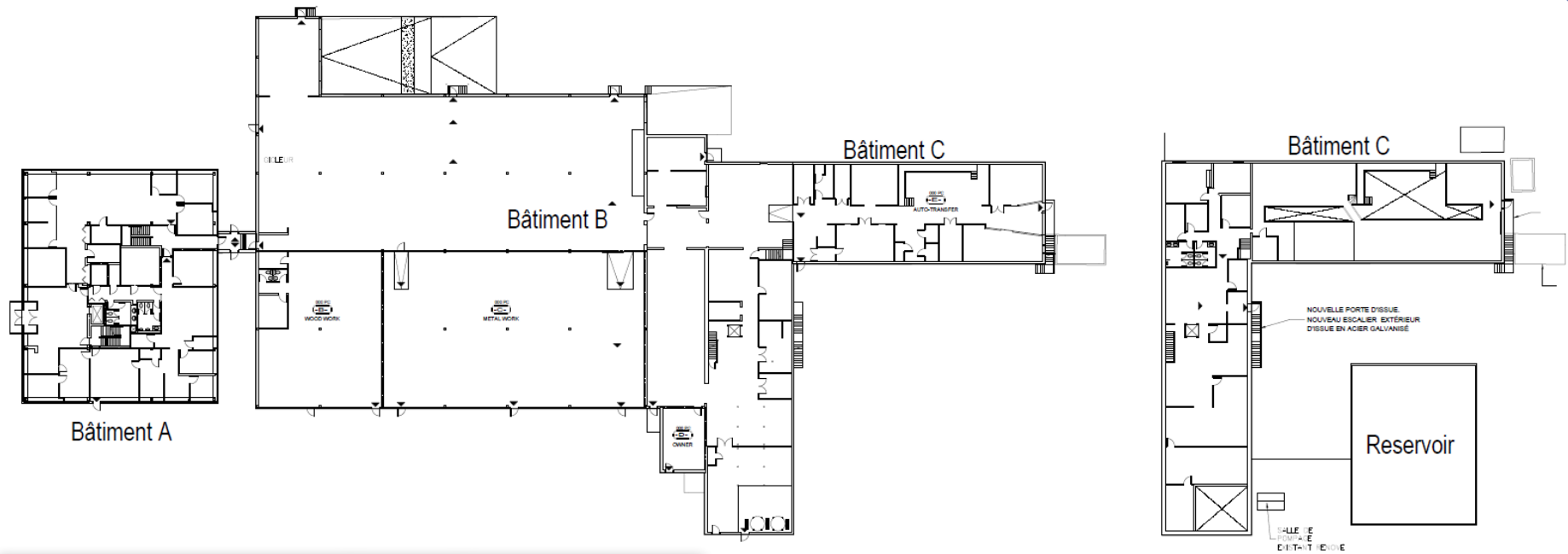

Steven Glazer

C: 514.983.9002

T: 514.933.5112 #262

sglazer@groupereshapiro.com

Gabrielle Gervais

C: 514.549.1153

T: 514.933.5112 #230

ggervais@groupereshapiro.com

Jeff Rosenberg

C: 514.947.5117

T: 514.731.7547

jrosenberg@groupereshapiro.com

GRUPE SHAPIRO

800 Place Victoria, #440, Montréal, Qc, H4Z 1E8

www.groupereshapiro.com

