

QUIET WATERS BUSINESS PARK

SOUTH FLORIDA
NORTHEAST BROWARD

750 S Powerline Road
Deerfield Beach, FL 33442



FOR LEASE

SUITE G

12,475 SF



LEASED BY



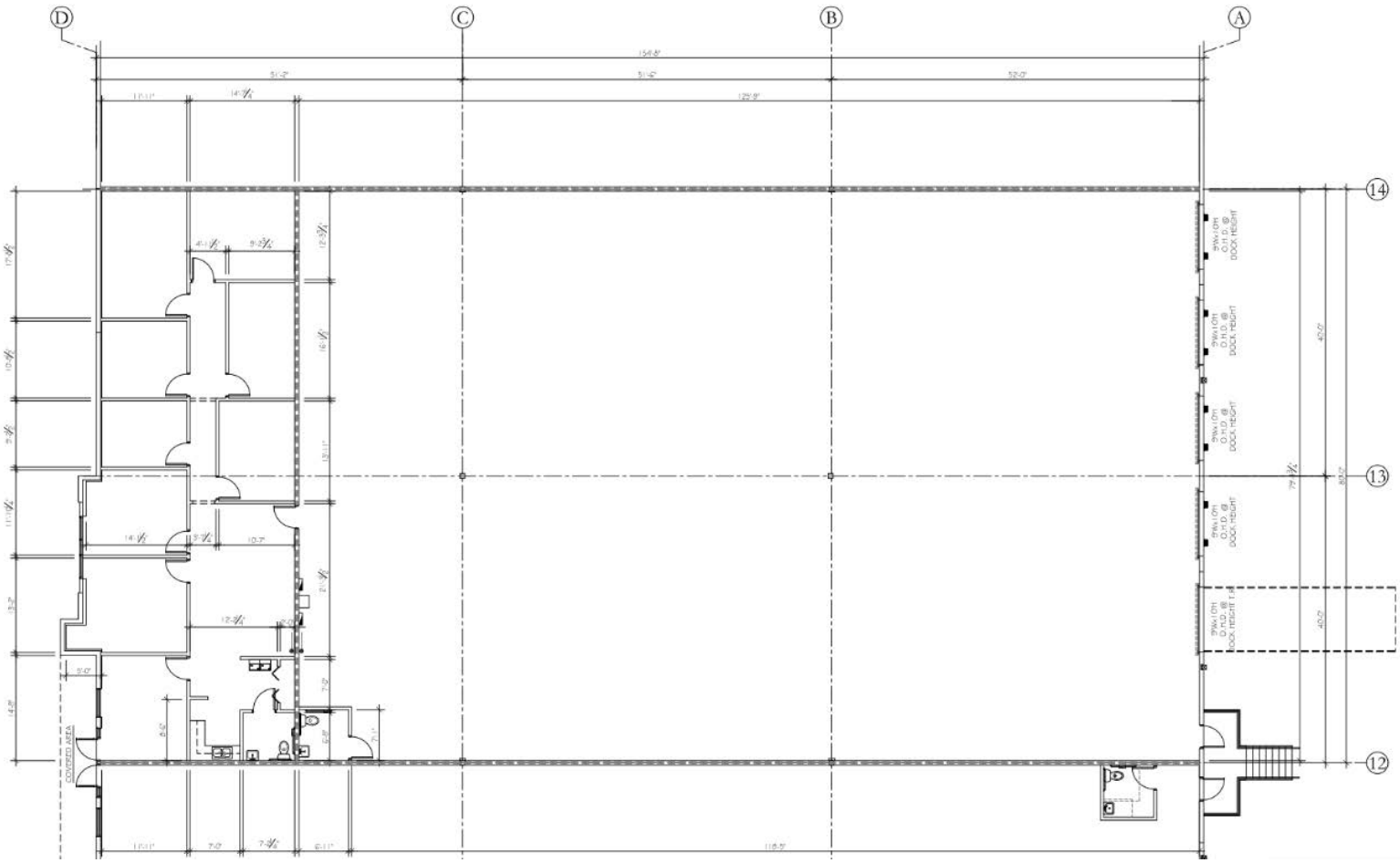

PROPERTY HIGHLIGHTS

Total Square Feet:	12,475 SF
Office Area:	2,000 SF
Ceiling Height:	24' Clear
Doors:	5 Dock High Doors
Bathrooms	2
Power:	400 Amps / 480 Volt
Availability:	July 1, 2026

CONTACT INFORMATION

750 S Powerline Road
Deerfield Beach, FL 33442

Matthew G. McAllister

Matthew.mcallister@cushwake.com
(561) 901-5216

Eric Cantor

Eric.cantor@cushwake.com
(561) 227-2068

Christopher Thomson

Christopher.thomson@cushwake.com
(561) 301-2390

This document is for informational purposes only and does not constitute an offer or acceptance of a lease. Any lease agreement must be in writing and signed by the landlord. No representations or warranties are made except as expressly stated in a signed lease. Information is provided "as is" and may be subject to errors or change without notice.



LEASED BY

