

Jefferson Plaza

Ground Floor Retail/Medical

300 Arthur Godfrey Rd Miami Beach, FL



Ground Floor Retail and Medical Space

2,700 - 10,000 SF available. Great for retail and medical use.

Ground Floor Retail or
Medical Space
2,300-10,000 SF Available

Join Bank of America,
HearUSA, 3T Radiology,
Advanced Pet Imaging and more

Less than one Mile from Mt Sinai
Medical Center

Parking available
on premises

41,000+ average annual daily
traffic on Arthur Godfrey Rd

Strong Medical Co-Tenancy

Alex Fryd
Fryd Properties
523 Michigan Avenue Miami Beach, FL 33139
305.673.2948 | alex@frydproperties.com



Jefferson Plaza

Retail/Medical Space

300 Arthur Godfrey Rd Miami Beach, FL

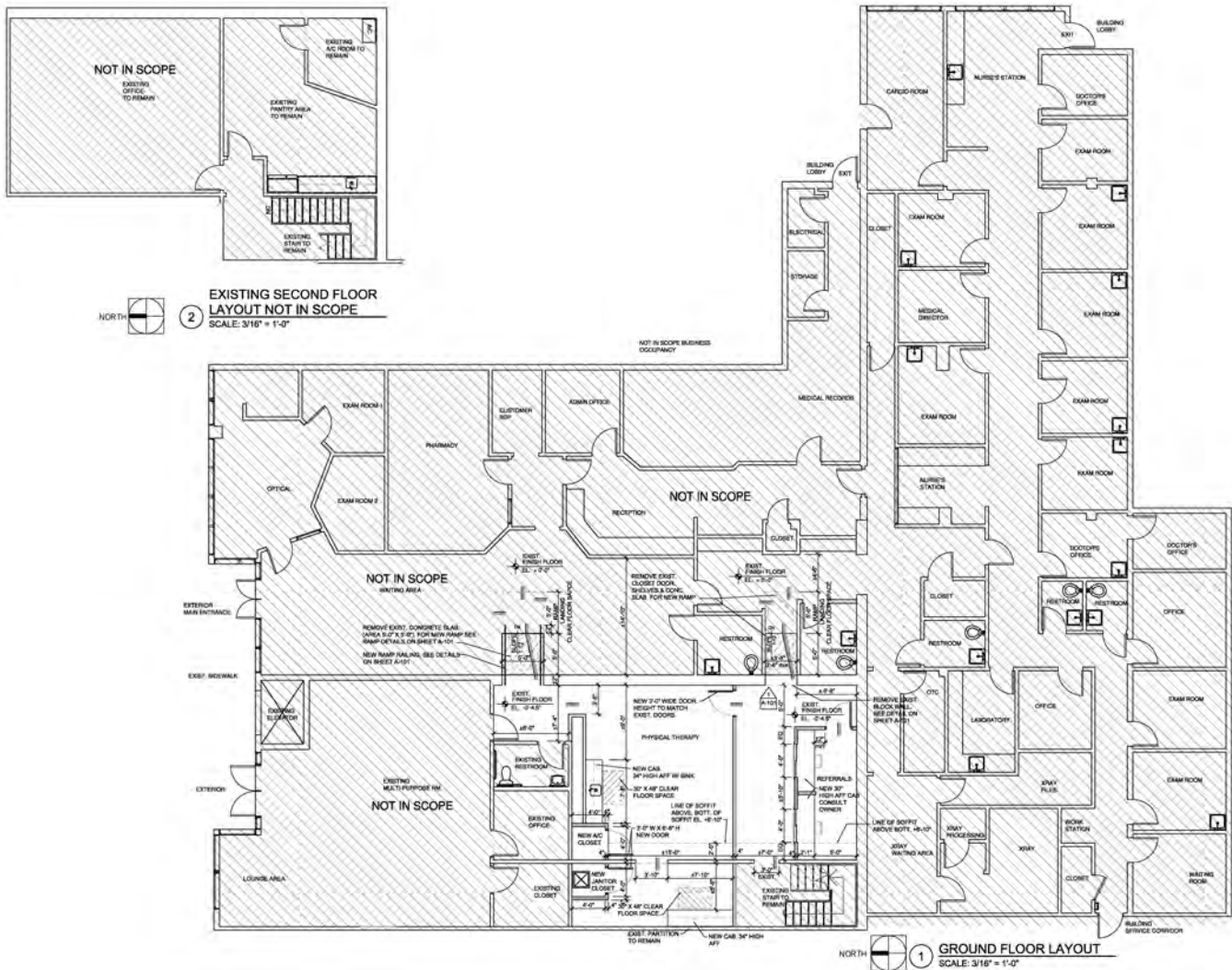

This floor plan is not to scale and should not be relied upon. Image shown is for illustrative purposes only.

Alex Fryd
Fryd Properties
523 Michigan Avenue Miami Beach, FL 33139
305.673.2948 | alex@frydproperties.com

