

OFFICE FOR LEASE

5375 Henneman Drive,
Norfolk, VA



NORFOLK COMMERCE PARK

ABOUT PROPERTY

- 2,840 SF Office
- 19 Parking Spaces
- Zoned BC-0 (Business and Commerce Park-Office)
- Easy access to I-64
- LEASE RATE: \$14.00/SF, NNN (\$2.50/SF)**

DEMOGRAPHICS (2025)

	3 MI.	5 MI.
Population:	104,659	307,586
Households:	43,408	129,803
Avg. Household Income:	\$87,338	\$94,661

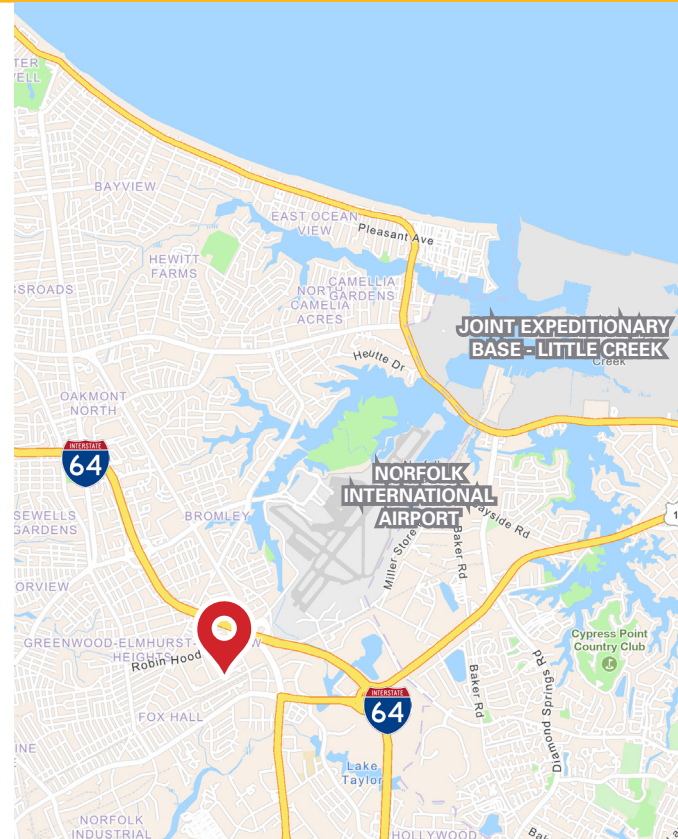

For more information:
JONATHAN LEVIN
757.647.8530
jonathanlevin@harveylindsay.com

BOBBY BEASLEY, III, SIOR
757.640.8241
bobbybeasley3@harveylindsay.com

HARVEY LINDSAY
COMMERCIAL REAL ESTATE

www.harveylindsay.com

INTERIOR PHOTOS | 5375 Henneman Dr., Norfolk, VA



AVAILABLE FLOOR PLAN | 5375 Henneman Dr, Norfolk, VA

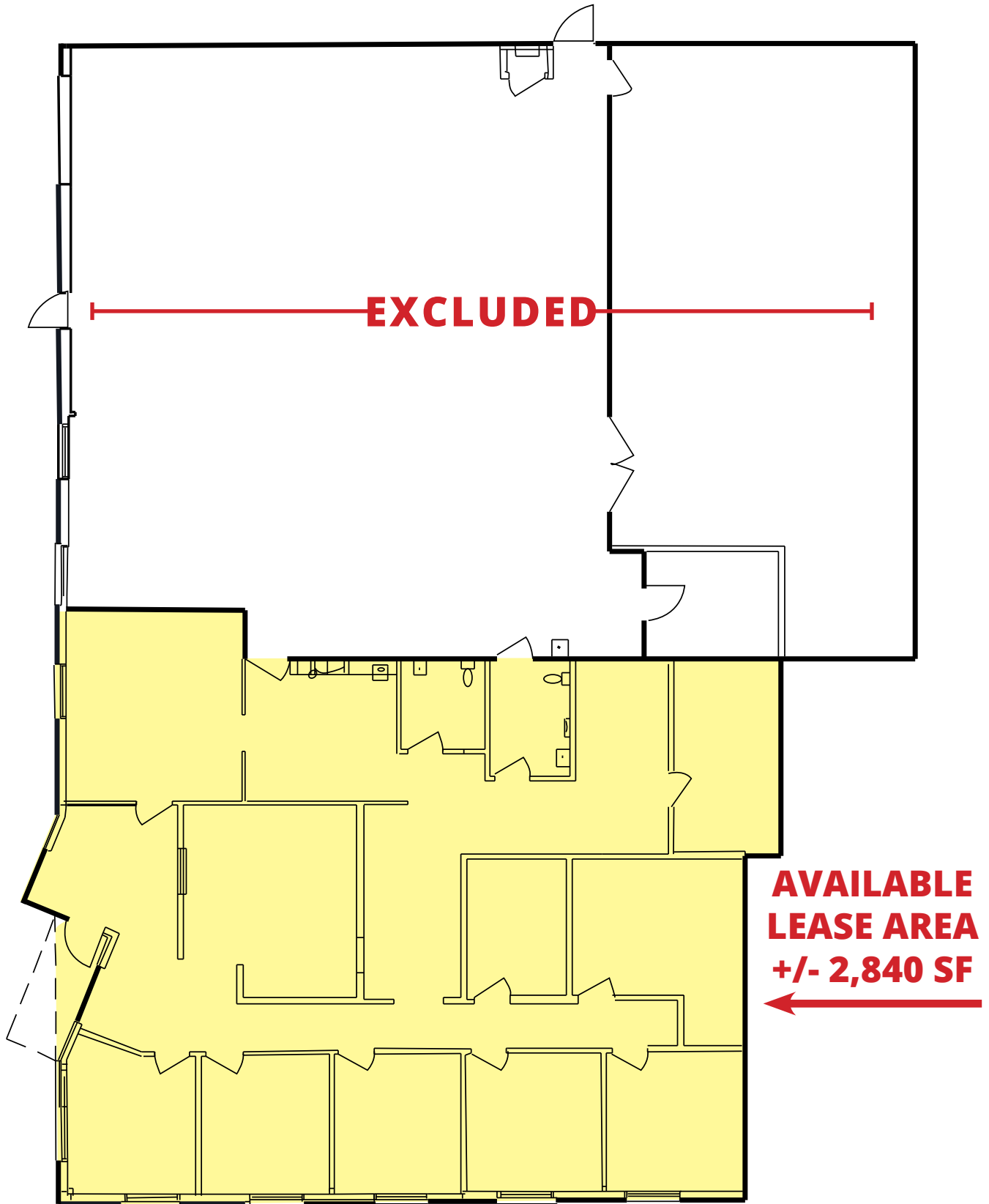

The information contained herein has been obtained from sources believed to be reliable but is not warranted. We cannot be responsible for errors, omissions, withdrawal, or prior lease or sale.

AERIAL VIEW | 5375 Henneman Dr., Norfolk, VA



HARVEY LINDSAY
COMMERCIAL REAL ESTATE

Jonathan Levin | 757.647.8530 | JonathanLevin@HarveyLindsay.com
Bobby Beasley, III, SIOR | 757.640.8241 | BobbyBeasley3@HarveyLindsay.com