

FIFTH FLOOR SUITE 500



Available Now | SPEC SUITE | ±22,451 RSF

Elevate Your Work Environment: Premier Lab and Office Suites



FLEXIBLE LABS

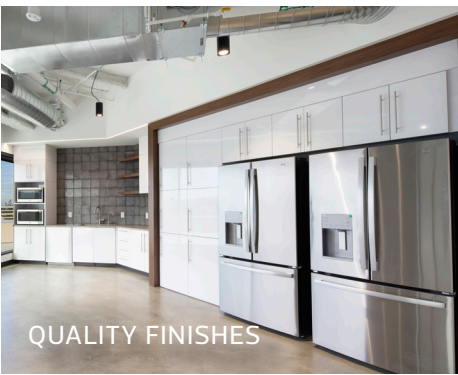

QUALITY FINISHES



GREAT VIEWS

Virtual Tour

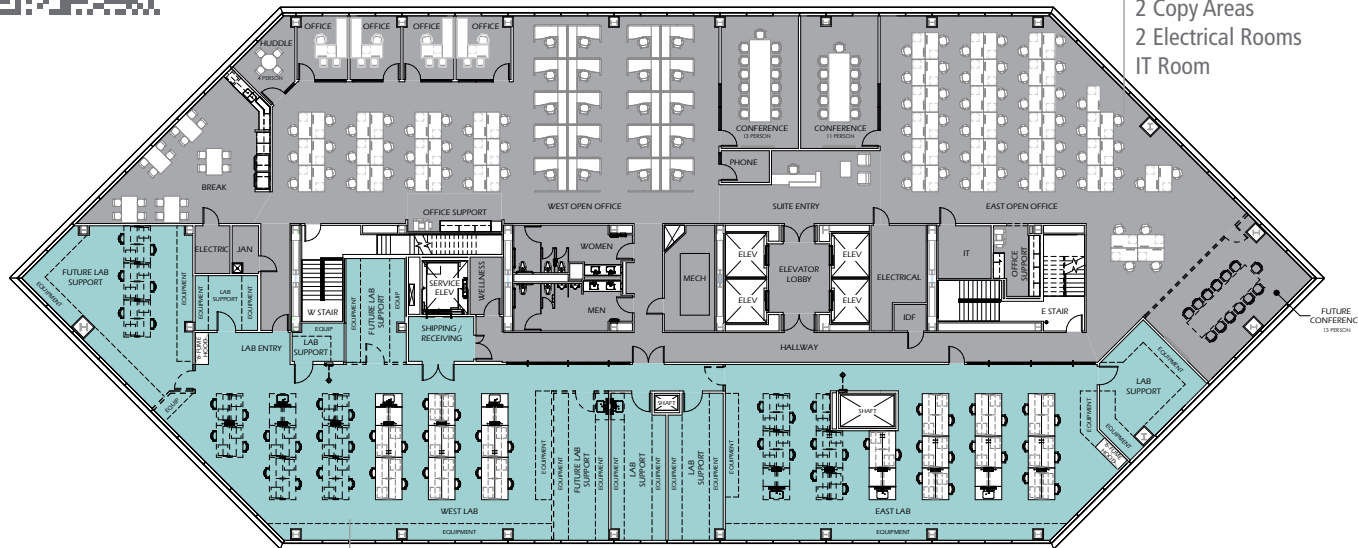
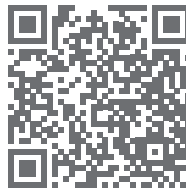

- OFFICE
- 93 Workstations*
- 4 Private Offices
- 3 Conference Rooms
- Huddle Room
- Wellness Room
- Phone Room
- Break Area
- 2 Copy Areas
- 2 Electrical Rooms
- IT Room

*Office furniture shown not included.

- LAB
- 61 Bench Knee-hole Spaces
- 8 Lab Support Rooms
- 8 Lab Sinks
- 2 6Ft Fume Hoods
- BSL2 - Single Pass Air
- House Air & Vac Distribution
- Direct Shipping & Receiving

— SPEC - - - FUTURE ■ OFFICE ■ LAB □ COMMON

1400FASHIONISLAND.COM | 1400 FASHION ISLAND BLVD, SAN MATEO, CA



BUILDING HIGHLIGHTS

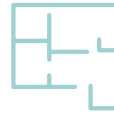

Suite Range
±10,000 - 23,500 RSF



GENESIS
Spec Lab Program



Robust MEP,
Infrastructure Upgrades



Scalable
Growth



Immediate Freeway Access
and Visibility on Hwy 92



Parking Ratio
3.0/1,000



New 1,500kW
Emergency Generator



New Service Elevator
5,000lbs Max



Tenant Experience
Application

SIMON CLARK
650.577.2938
simon.clark@cbre.com
RE license #01318652

JAMES BENNETT
650.494.5192
james.bennett@cbre.com
RE license #00869074

EVAN CHANG
650.577.2962
evan.chang@cbre.com
RE license #02010044

BECKA STUDER
951.663.2997
studer@p3re.com
RE license #02004534



© 2025 CBRE, Inc. All rights reserved. This information has been obtained from sources believed reliable, but has not been verified for accuracy or completeness. You should conduct a careful, independent investigation of the property and verify all information. Any reliance on this information is solely at your own risk. CBRE and the CBRE logo are service marks of CBRE, Inc. All other marks displayed on this document are the property of their respective owners, and the use of such logos does not imply any affiliation with or endorsement of CBRE. Photos herein are the property of their respective owners. Use of these images without the express written consent of the owner is prohibited.