

2135

BUTANO DRIVE
SACRAMENTO, CA

PLUG & PLAY OFFICE SPACE FOR LEASE

Full Building (±52,398 SF) Available | Divisible to ±7,000 SF



NEWMARK

MATTHEW ALEMANIA
Associate Director
916.569.2363
matthew.alemania@nrmk.com
CA RE License #01958591

RACHEL JONES
Associate
916.569.2326
rachel.r.jones@nrmk.com
CA RE License #02200316

PROPERTY HIGHLIGHTS



Plug and play with brand new sit-stand furniture



±7,000 SF - ±12,285 SF available on the Ground Floor
±12,285 SF - ±26,199 SF available on the Second Floor



New HVAC



New electrical



Covered parking



Sonitrol key card security access



Highly improved/ Class A common areas



Improved lobby and restroom core



Monument signage



EV Charging Station



Outdoor collaborative work area



FLOOR PLAN - GROUND FLOOR

- ±7,000 - ±26,199 RSF Available
- **\$1.45 PSF, Full Service**
- New Carpet
- New Flooring
- New LED Lights

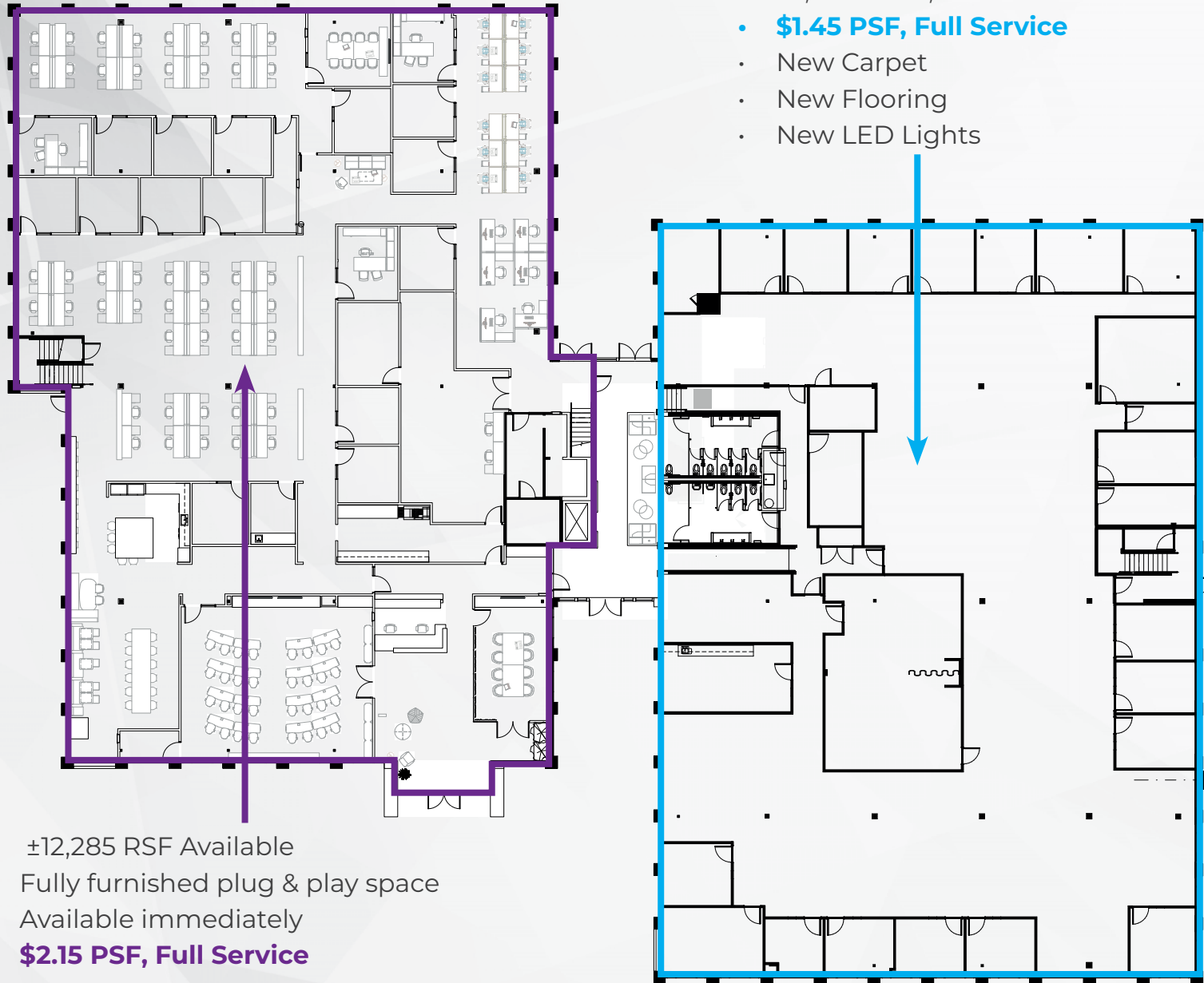

- ±12,285 RSF Available
- Fully furnished plug & play space
- Available immediately
- **\$2.15 PSF, Full Service**

FLOOR PLAN - SECOND FLOOR



- ±12,285 - ±26,199 RSF available
- Fully furnished plug & play space
- Available immediately
- **\$2.15 PSF, Full Service**

PROPERTY PHOTOS

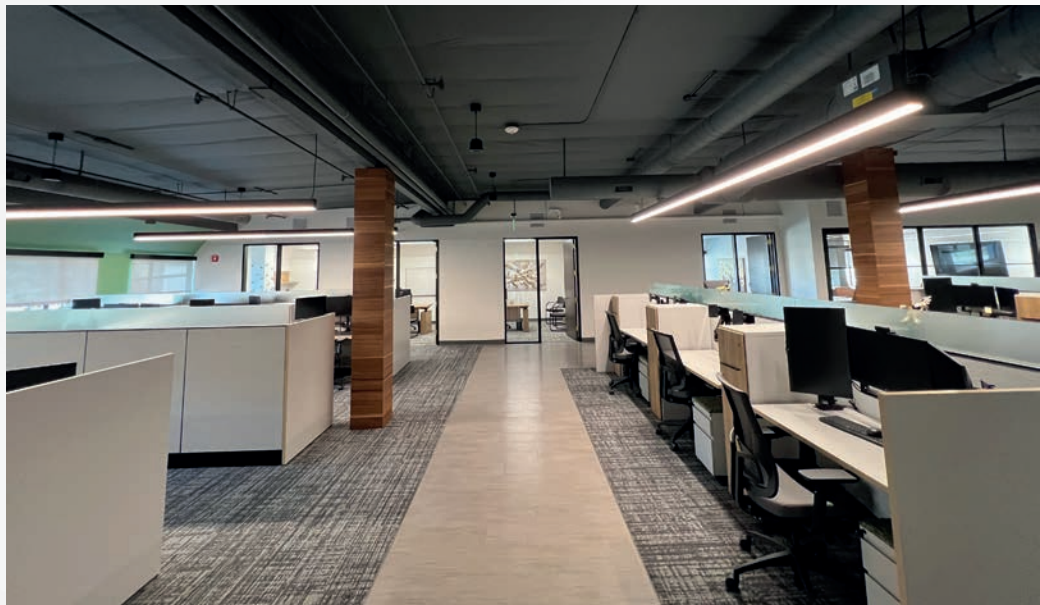

PROPERTY PHOTOS



LOCATION MAP

2135
BUTANO
DRIVE



The distributor of this communication is performing acts for which a real estate license is required. The information contained herein has been obtained from sources deemed reliable but has not been verified and no guarantee, warranty or representation, either express or implied, is made with respect to such information. Terms of sale or lease and availability are subject to change or withdrawal without notice. 23-0321 04/26

MATTHEW ALEMANIA
Associate Director
916.569.2363
matthew.alemania@nmrk.com
CA RE License #01958591

RACHEL JONES
Associate
916.569.2326
rachel.r.jones@nmrk.com
CA RE License #02200316