

**FLOOR PLAN- 6TH FLOOR**

SCALE: 3/32" = 1'-0"

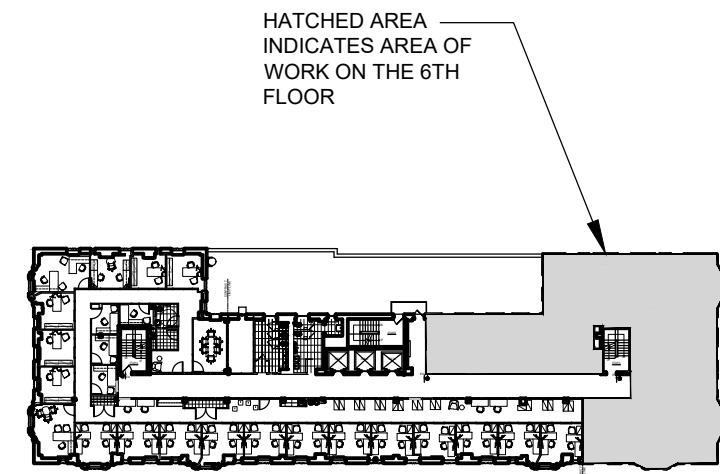

HATCHED AREA INDICATES AREA OF WORK ON THE 6TH FLOOR



**KEY PLAN**

N.T.S.

**BLDG Management Co., Inc.**  
 417 FIFTH AVENUE  
 4TH FLOOR  
 NEW YORK, NY  
 10016 USA  
 TEL: 212.624.4300  
 FAX: 212.624.7259

BUILDING  
 2090 7th AVENUE  
 THERESA TOWERS  
 NEW YORK , NY

SCALE	AS NOTED
DRAWN BY	RL
REVIEWED BY	ZZ
DATE	04.17.2025

DISCLAIMER:  
 THIS DOCUMENT HAS BEEN PREPARED AND MAINTAINED BY BLDG MANAGEMENT CO., INC. AND ITS AFFILIATE MANAGERS AND OWNERS FOR INTERNAL PURPOSES ONLY. BLDG HAS GIVEN YOU THIS DOCUMENT FOR INFORMATIONAL PURPOSES ONLY AT NO COST TO YOU. BLDG MAKES NO REPRESENTATIONS AS TO THE ACCURACY OF ANY OF THE INFORMATION CONTAINED IN THE WITHIN SKETCH, NOTES, AND DESCRIPTIONS, AND DISCLAIMS ALL RESPONSIBILITY FOR ANY DISCREPANCIES BASED UPON A PHYSICAL EXAMINATION OF THE PREMISES OR OTHERWISE.

FLOOR  
**6**