



The best value in Morris County

Building Size 139,750 rsf

Available Space 2nd Floor: 34,462 rsf
2nd Floor: 48,758 rsf
Total: 83,220 rsf

Rate Call for quote

Availability Immediate

Property Features

- Financially stable ownership
- Zoned C-1, with multiple permitted uses (including lab and medical)
- Ample parking ratio ($\pm 5/1000$)
- The building contains a full service cafeteria, loading docks (3) and a back-up generator
- Walkable to Lifetime Fitness
- Building facade and monument signage
- On-site NJ Transit bus stop

For further information

Drew Persson
Principal
+1 973 753 1107
drew.persson@avisonyoung.com

Jeffrey L Heller, SIOR
Principal and Executive Director
+1 973 753 1100
jeff.heller@avisonyoung.com

For Lease

12 Vreeland Rd, Florham Park NJ

Gallery



**For further
information**

Drew Persson
Principal
+1 973 753 1107
drew.persson@avisonyoung.com

Jeffrey L Heller, SIOR
Principal and Executive Director
+1 973 753 1100
jeff.heller@avisonyoung.com

**AVISON
YOUNG**

For Lease

12 Vreeland Rd, Florham Park NJ

Floor plan – Second floor

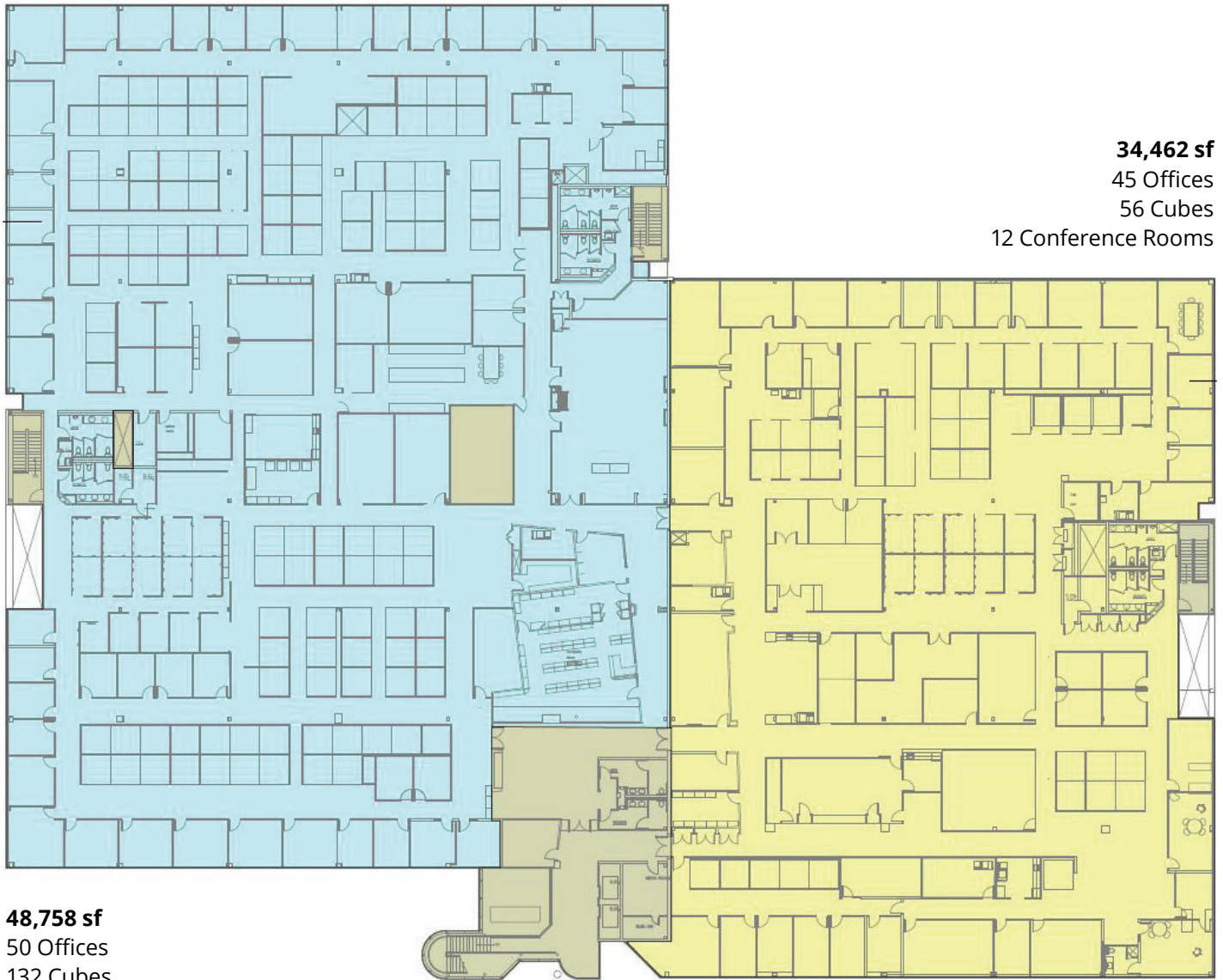

48,758 sf
50 Offices
132 Cubes
11 Conference Rooms

34,462 sf
45 Offices
56 Cubes
12 Conference Rooms

For further information

Drew Persson
Principal
+1 973 753 1107
drew.persson@avisonyoung.com

Jeffrey L Heller, SIOR
Principal and Executive Director
+1 973 753 1100
jeff.heller@avisonyoung.com



For Lease

12 Vreeland Rd, Florham Park NJ

Area map



Proximity and access	
Route 10	1 mi
Route 24	2 mi
I-287	5 mi
I-280	5 mi
I-78	9 mi
Garden State Parkway	10 mi



12 VREELAND RD

Area amenities

- 1. Livingston Mall
- 2. Short Hills Mall
- 3. Downtown Restaurants
- 4. Lifetime Fitness
- 5. Daycare - Primrose School
- 6. New Jersey Transit to NYC

For further information

Drew Persson
Principal
+1 973 753 1107
drew.persson@avisonyoung.com

Jeffrey L Heller, SIOR
Principal and Executive Director
+1 973 753 1100
jeff.heller@avisonyoung.com

