

Unit 100

3676 Bainbridge Avenue

Burnaby, BC

33,833 SF Industrial Space with Dock Loading
Located in the Winston Industrial Area



Professionally Owned & Managed By

Beedie/



Opportunity

Unit 100 at 3676 Bainbridge Avenue presents 33,833 SF of industrial space located in the heart of Burnaby within the Winston industrial area. This unit features front-loading configuration with a covered loading platform, and a combination of office, showroom, and warehouse space. The property is professionally owned and managed by Beedie, Western Canada's largest industrial developer and property manager.

The subject property's strategic location provides excellent connectivity throughout Metro Vancouver. Benefit from being just 2 minutes from Lougheed Highway and 8 minutes from the Trans-Canada Highway. Expo SkyTrain Line's Sperling-Burnaby Lake Station is within a 15-minute walk to and from the property, offering convenient commuter access for employees.

Available Area

33,833 SF

Available

Immediately

Asking Lease Rate

Contact Listing Agents

Additional Rent

\$5.51 PSF (2025 est.)
plus 5% Management Fee

Zoning

CD (M-5)



Unit Features



2 dock loading doors



Fluorescent lighting



Ample truck maneuvering room



Covered loading platform



91' open clear span warehouse area



Designated men's, womens' & universal washrooms



20' clear height



Alarm security system



Combination of showroom, storage, boardroom, private office spaces, lunchroom, & first aid room



600 amps, 480 volts, electrical service



Ample parking



Floor Plan

Unit Area

Loading Dock	2,603 SF
Office	9,475 SF
Warehouse	21,755 SF
Total	33,833 SF

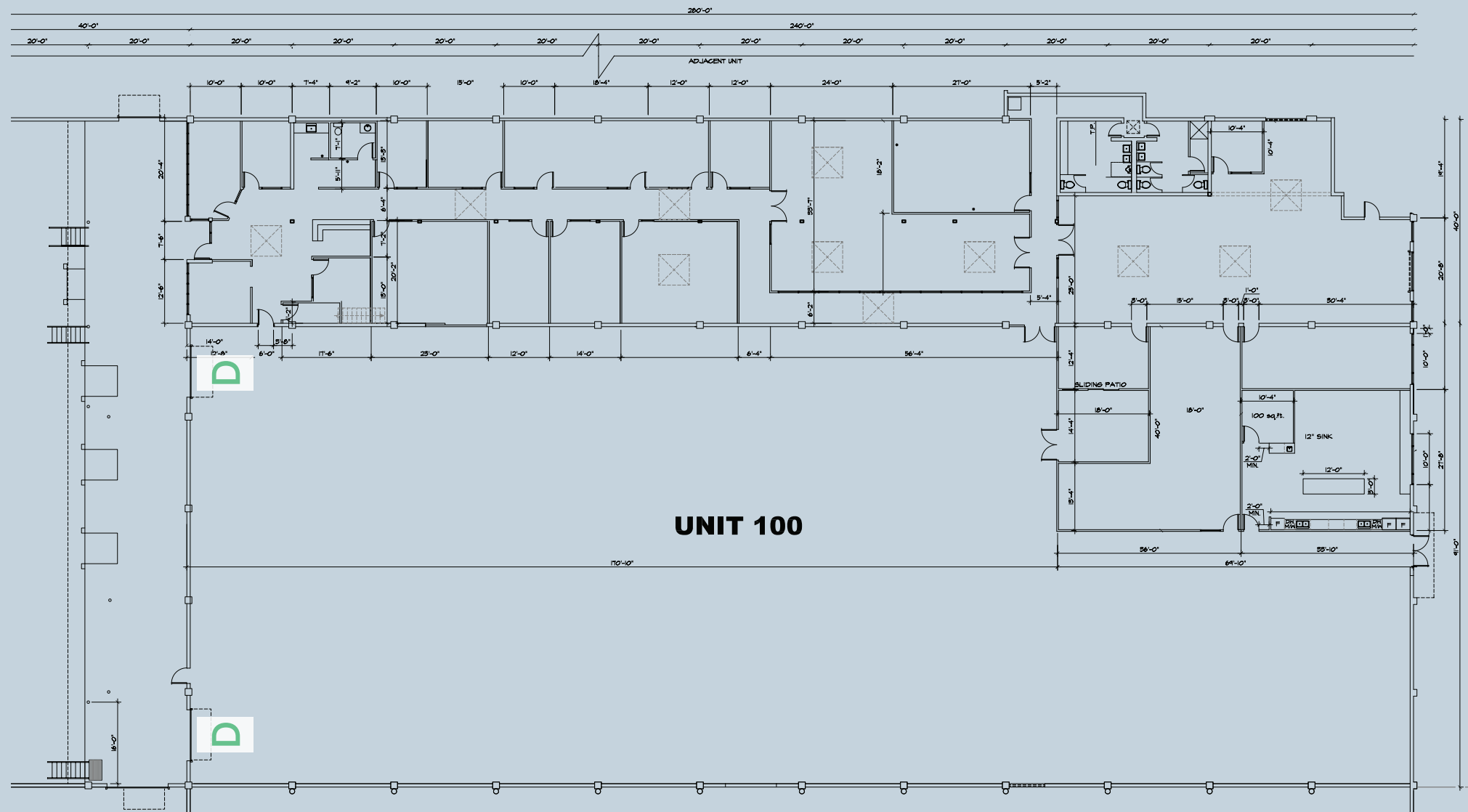

D = Dock Loading

*Areas are approximate. Floor plan is not to scale.



Unit 100
3676 Bainbridge Avenue
Burnaby, BC

Industrial | For Lease

Tenants In The Area

- 1 Dryco
- 2 Whistler Water
- 3 William F. White Lakewood Studios
- 4 Microserve
- 5 Digital Sound Magic Recording Studios
- 6 Eagle Creek Studios
- 7 L. B. Fosters
- 8 Sulzer
- 9 MBS Studios

Drive Times	2 Min Lougheed Highway (Hwy 7)	5 Min Trans-Canada Highway (Hwy 1)	7 Min The Amazing Brentwood	12 Min Metrotown	29 Min Downtown Vancouver
	22 Min GCT Vanterm & Centerm Terminals	26 Min Fraser Surrey Docks	45 Min Deltaport	45 Min Canada-US Border	40 Min Vancouver International Airport

Contact

Joe Inkster

Personal Real Estate Corporation
Executive Vice President
Industrial Properties
604 662 5134
joe.inkster@cbre.com

Hayden Ferrill

Vice President
Industrial Properties
778 372 1934
hayden.ferrill@cbre.com

CBRE Limited | 1021 West Hastings Street #2500, Vancouver, BC

This disclaimer shall apply to CBRE Limited, Real Estate Brokerage, and to all other divisions of the Corporation; to include all employees and independent contractors ("CBRE"). The information set out herein, including, without limitation, any projections, images, opinions, assumptions and estimates obtained from third parties (the "Information") has not been verified by CBRE, and CBRE does not represent, warrant or guarantee the accuracy, correctness and completeness of the Information. CBRE does not accept or assume any responsibility or liability, direct or consequential, for the Information or the recipient's reliance upon the Information. The recipient of the Information should take such steps as the recipient may deem necessary to verify the Information prior to placing any reliance upon the Information. The Information may change and any property described in the Information may be withdrawn from the market at any time without notice or obligation to the recipient from CBRE. CBRE and the CBRE logo are the service marks of CBRE Limited and/or its affiliated or related companies in other countries. All other marks displayed on this document are the property of their respective owners. All Rights Reserved.
Mapping Sources: Canadian Mapping Services canadamapping@cbre.com; DMTI Spatial, Environics Analytics, Microsoft Bing, Google Earth.

