



ARES  
INDUSTRIAL  
MANAGEMENT

# 2100 EAST 49<sup>TH</sup> STREET

VERNON, CA 90058

FOR LEASE | 54,000 SF | Distribution/Warehouse Space Available



**JON RENO, SIOR, CCIM**  
+1 213 271 1508  
jon.reno@jll.com  
Lic #01277642

**MARK VANIS**  
+1 213 239 5908  
mark.vanis@jll.com  
Lic #01305617

**TREVOR GALE, SIOR**  
+1 213 239 6256  
trevor.gale@jll.com  
Lic #01452957

# Property FEATURES

- Lease rate TBD NNN
- OPEX \$0.47 psf
- Deliverable by July 2026
- 1,934 SF of brand new offices
- 22' - 24' clear height
- 6 DH / 1 GL positions
- Calculated fire sprinkler system .33/4,000 GPM
- Column spacing 20' x 65'
- Skylights
- Just minutes south of DTLA
- Excellent Vernon location at S Alameda St

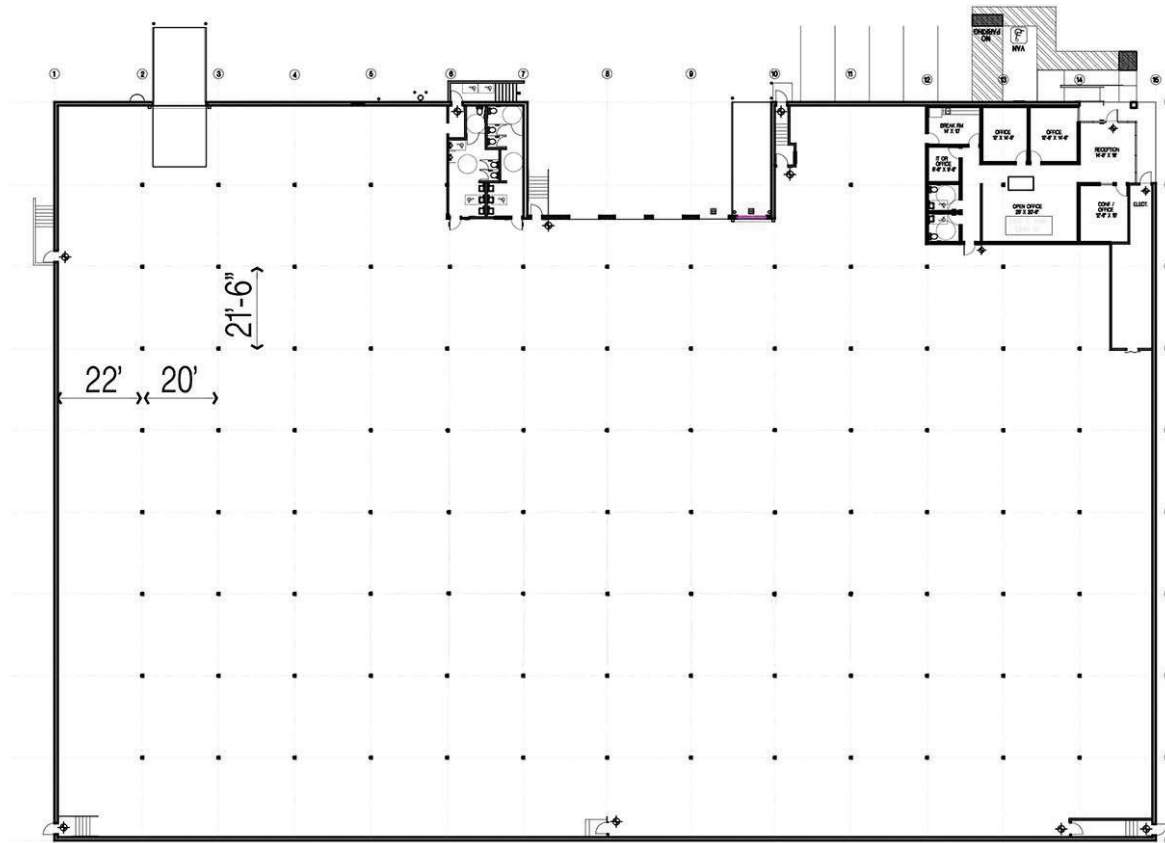

ARES  
INDUSTRIAL  
MANAGEMENT

For Lease



ARES  
INDUSTRIAL  
MANAGEMENT

## ABOUT ARES MANAGEMENT CORPORATION

Ares Management Corporation (NYSE: ARES) is a leading global alternative investment manager offering clients complementary primary and secondary investment solutions across the credit, private equity, real estate and infrastructure asset classes. We seek to provide flexible capital to support businesses and create value for our stakeholders and within our communities. By collaborating across our investment groups, we aim to generate consistent and attractive investment returns throughout market cycles. For more information, please visit [www.aresmgmt.com](http://www.aresmgmt.com).



**JON RENO, SIOR, CCIM**  
+1 213 271 1508  
[jon.reno@jll.com](mailto:jon.reno@jll.com)  
LIC #01277642

**MARK VANIS**  
+1 213 239 5908  
[mark.vanis@jll.com](mailto:mark.vanis@jll.com)  
LIC #01305617

**TREVOR GALE, SIOR**  
+1 213 239 6256  
[trevor.gale@jll.com](mailto:trevor.gale@jll.com)  
LIC #01452957



**ARES  
INDUSTRIAL  
MANAGEMENT**