

+/- 3,500 sf Office Floorplan – 2nd Floor 20701 Bruce B Downs Blvd Tampa, FL EXECUTIVE OFFICE SUITES LAYOUT

LIFE SAFETY LEGEND

- EXIT
- EMERGENCY LIGHT
- TYPE "A" AND "B" STAIRWAYS IN CONFORM
- ONE DOT SIGN (UNABLATED) SERVICE ENTRANCE
- ONE DOT SIGN (UNABLATED) SERVICE ENTRANCE

DEMOLITION LEGEND

- GENERAL DEMOLITION
- EXISTING TO REMAIN

DEMOLITION NOTES

1. GENERAL DEMOLITION SHALL BE LIMITED TO THE EXISTING BUILDING AND SHALL NOT BE CONSIDERED AS A DEMOLITION PROJECT.
2. ALL DEMOLITION SHALL BE IN ACCORDANCE WITH THE CITY OF TAMPA DEMOLITION ORDINANCE.
3. CONSTRUCTION TO REMOVE EXISTING PARTS OF EXISTING BUILDING SHALL BE IN ACCORDANCE WITH THE CITY OF TAMPA DEMOLITION ORDINANCE.
4. DEMOLITION SHALL BE IN ACCORDANCE WITH THE CITY OF TAMPA DEMOLITION ORDINANCE.
5. CONTRACTOR SHALL VERIFY ALL EXISTING CONDITIONS AND SHALL BE RESPONSIBLE FOR OBTAINING ALL NECESSARY PERMITS AND APPROVALS FROM THE CITY OF TAMPA AND THE FLORIDA DEPARTMENT OF ENVIRONMENTAL PROTECTION (FDEP).
6. CONTRACTOR SHALL VERIFY ALL EXISTING CONDITIONS AND SHALL BE RESPONSIBLE FOR OBTAINING ALL NECESSARY PERMITS AND APPROVALS FROM THE CITY OF TAMPA AND THE FLORIDA DEPARTMENT OF ENVIRONMENTAL PROTECTION (FDEP).
7. CONTRACTOR SHALL VERIFY ALL EXISTING CONDITIONS AND SHALL BE RESPONSIBLE FOR OBTAINING ALL NECESSARY PERMITS AND APPROVALS FROM THE CITY OF TAMPA AND THE FLORIDA DEPARTMENT OF ENVIRONMENTAL PROTECTION (FDEP).
8. CONTRACTOR SHALL VERIFY ALL EXISTING CONDITIONS AND SHALL BE RESPONSIBLE FOR OBTAINING ALL NECESSARY PERMITS AND APPROVALS FROM THE CITY OF TAMPA AND THE FLORIDA DEPARTMENT OF ENVIRONMENTAL PROTECTION (FDEP).
9. CONTRACTOR SHALL VERIFY ALL EXISTING CONDITIONS AND SHALL BE RESPONSIBLE FOR OBTAINING ALL NECESSARY PERMITS AND APPROVALS FROM THE CITY OF TAMPA AND THE FLORIDA DEPARTMENT OF ENVIRONMENTAL PROTECTION (FDEP).
10. CONTRACTOR SHALL VERIFY ALL EXISTING CONDITIONS AND SHALL BE RESPONSIBLE FOR OBTAINING ALL NECESSARY PERMITS AND APPROVALS FROM THE CITY OF TAMPA AND THE FLORIDA DEPARTMENT OF ENVIRONMENTAL PROTECTION (FDEP).

(Not Included)

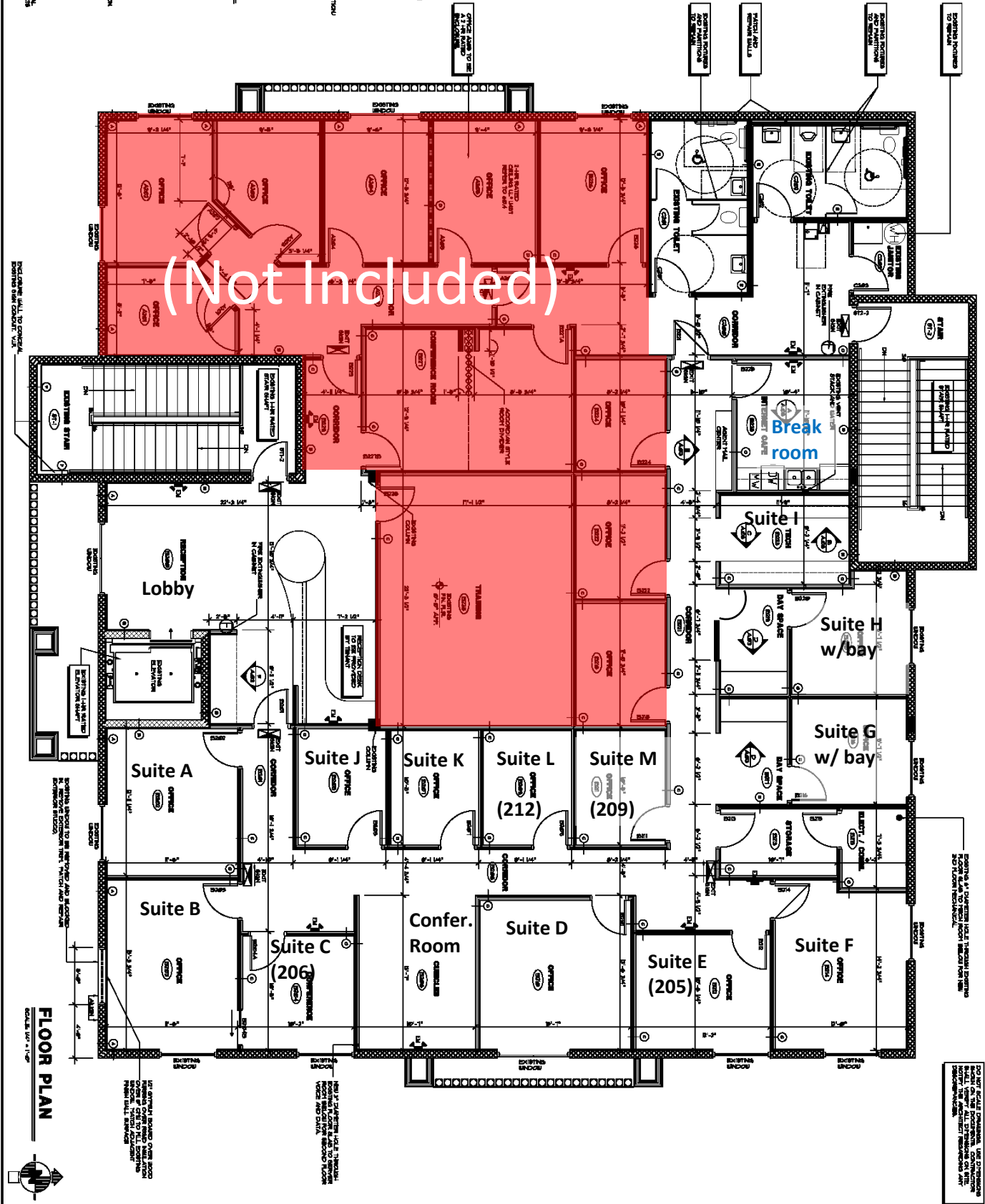

FLOOR PLAN



THIS FLOOR PLAN IS A REPRESENTATION OF THE EXISTING CONDITIONS AND SHALL NOT BE CONSIDERED AS A DEMOLITION PROJECT. THE CONTRACTOR SHALL VERIFY ALL EXISTING CONDITIONS AND SHALL BE RESPONSIBLE FOR OBTAINING ALL NECESSARY PERMITS AND APPROVALS FROM THE CITY OF TAMPA AND THE FLORIDA DEPARTMENT OF ENVIRONMENTAL PROTECTION (FDEP).