

4776 RENTABLE SR. FT.

HARDWARE SET LIST:
 F15. PASSAGE LOCK
 F16. PASSAGE LOCK
 F20. ENTRANCE LOCK
 F21. ENTRANCE LOCK
 F22. CLASSROOM LOCK
 F23. CLASSROOM LOCK
 F24. CLASSROOM LOCK
 F25. CLASSROOM SECURITY LOCK
 F26. CLASSROOM SECURITY LOCK
 F27. CLASSROOM SECURITY LOCK
 F28. CLASSROOM SECURITY LOCK
 F29. CLASSROOM SECURITY LOCK
 F30. CLASSROOM SECURITY LOCK
 F31. METAL WELDED FRAME
 F32. METAL WELDED FRAME
 F33. METAL WELDED FRAME
 F34. METAL WELDED FRAME
 F35. METAL WELDED FRAME
 F36. METAL WELDED FRAME
 F37. METAL WELDED FRAME
 F38. METAL WELDED FRAME
 F39. METAL WELDED FRAME
 F40. METAL WELDED FRAME
 F41. METAL WELDED FRAME
 F42. METAL WELDED FRAME
 F43. METAL WELDED FRAME
 F44. METAL WELDED FRAME
 F45. METAL WELDED FRAME
 F46. METAL WELDED FRAME
 F47. METAL WELDED FRAME
 F48. METAL WELDED FRAME
 F49. METAL WELDED FRAME
 F50. METAL WELDED FRAME
 F51. METAL WELDED FRAME
 F52. METAL WELDED FRAME
 F53. METAL WELDED FRAME
 F54. METAL WELDED FRAME
 F55. METAL WELDED FRAME
 F56. METAL WELDED FRAME
 F57. METAL WELDED FRAME
 F58. METAL WELDED FRAME
 F59. METAL WELDED FRAME
 F60. METAL WELDED FRAME
 F61. METAL WELDED FRAME
 F62. METAL WELDED FRAME
 F63. METAL WELDED FRAME
 F64. METAL WELDED FRAME
 F65. METAL WELDED FRAME
 F66. METAL WELDED FRAME
 F67. METAL WELDED FRAME
 F68. METAL WELDED FRAME
 F69. METAL WELDED FRAME
 F70. METAL WELDED FRAME
 F71. METAL WELDED FRAME
 F72. METAL WELDED FRAME
 F73. METAL WELDED FRAME
 F74. METAL WELDED FRAME
 F75. METAL WELDED FRAME
 F76. METAL WELDED FRAME
 F77. METAL WELDED FRAME
 F78. METAL WELDED FRAME
 F79. METAL WELDED FRAME
 F80. METAL WELDED FRAME
 F81. METAL WELDED FRAME
 F82. METAL WELDED FRAME
 F83. METAL WELDED FRAME
 F84. METAL WELDED FRAME
 F85. METAL WELDED FRAME
 F86. METAL WELDED FRAME
 F87. METAL WELDED FRAME
 F88. METAL WELDED FRAME
 F89. METAL WELDED FRAME
 F90. METAL WELDED FRAME
 F91. METAL WELDED FRAME
 F92. METAL WELDED FRAME
 F93. METAL WELDED FRAME
 F94. METAL WELDED FRAME
 F95. METAL WELDED FRAME
 F96. METAL WELDED FRAME
 F97. METAL WELDED FRAME
 F98. METAL WELDED FRAME
 F99. METAL WELDED FRAME
 F100. METAL WELDED FRAME

Suite D206 Door Schedule

NO.	DOOR TYPE	DOOR SIZE (H x W)	FRAME TYPE	FINISH	ROOM LOCATION	HWK SET	REMARKS	JAMB WIDTH
01	A	3'-0" x 7'-0"	MM	-	OFFICE 1	F15	W/SIDE LIGHT	4 1/2"
02	B	3'-0" x 7'-0"	MM	-	OFFICE 2	F15	W/SIDE LIGHT	4 1/2"
03	B	3'-0" x 7'-0"	MM	-	OFFICE 3	F15	W/SIDE LIGHT	4 1/2"
04	B	3'-0" x 7'-0"	MM	-	OFFICE 4	F15	W/SIDE LIGHT	4 1/2"
05	A	3'-0" x 7'-0"	MM	-	OFFICE 5	F15	W/SIDE LIGHT	4 1/2"
06	B	3'-0" x 7'-0"	MM	-	OFFICE 6	F15	W/SIDE LIGHT	4 1/2"
07	B	3'-0" x 7'-0"	MM	-	OFFICE 7	F15	W/SIDE LIGHT	4 1/2"
08	B	3'-0" x 7'-0"	MM	-	OFFICE 8	F15	W/SIDE LIGHT	4 1/2"
09	B	3'-0" x 7'-0"	MM	-	OFFICE 9	F15	W/SIDE LIGHT	4 1/2"
10	B	3'-0" x 7'-0"	MM	-	OFFICE 10	F15	W/SIDE LIGHT	4 1/2"
11	A	3'-0" x 7'-0"	MM	-	FLEX CONF ROOM 'A'	F15	W/SIDE LIGHT	4 1/2"
12	A	3'-0" x 7'-0"	MM	-	FLEX CONF ROOM 'B'	F15	W/SIDE LIGHT	4 1/2"
13	A	3'-0" x 7'-0"	MM	-	FLEX CONF ROOM 'C'	F15	W/SIDE LIGHT	4 1/2"
14	A	3'-0" x 7'-0"	MM	-	FLEX CONF ROOM 'D'	F15	W/SIDE LIGHT	4 1/2"
15	A	3'-0" x 7'-0"	MM	-	FLEX CONF ROOM 'E'	F15	W/SIDE LIGHT	4 1/2"
16	A	3'-0" x 7'-0"	MM	-	FLEX CONF ROOM 'F'	F15	W/SIDE LIGHT	4 1/2"
17	A	3'-0" x 7'-0"	MM	-	FLEX CONF ROOM 'G'	F15	W/SIDE LIGHT	4 1/2"
18	A	3'-0" x 7'-0"	MM	-	FLEX CONF ROOM 'H'	F15	W/SIDE LIGHT	4 1/2"
19	A	3'-0" x 7'-0"	MM	-	FLEX CONF ROOM 'I'	F15	W/SIDE LIGHT	4 1/2"
20	A	3'-0" x 7'-0"	MM	-	FLEX CONF ROOM 'J'	F15	W/SIDE LIGHT	4 1/2"

ALL HARDWARE TO BE ANSI A111 COMPLIANT.

HARDWARE:
 - GRADE 2, 6500 SERIES, KL DESIGN LEVER (NON-HANDLED), 2540 SANTI CHROME FINISH, BY SARGENT / ARCA APLDY
 - 14" x 4 1/4" ANSI FULL LIP STRIKE 261D
 - 4 1/4" x 4 1/4" 261D HINGES
 - WALL BRACKETS 401 FOR ALL DOORS AND DOOR SLIDERS (GRAY)
 - PROVIDE BITING SCHEDULE TO MATCH MASTER KEY AD AND CONTINUE NUMBERING SEQUENCE.

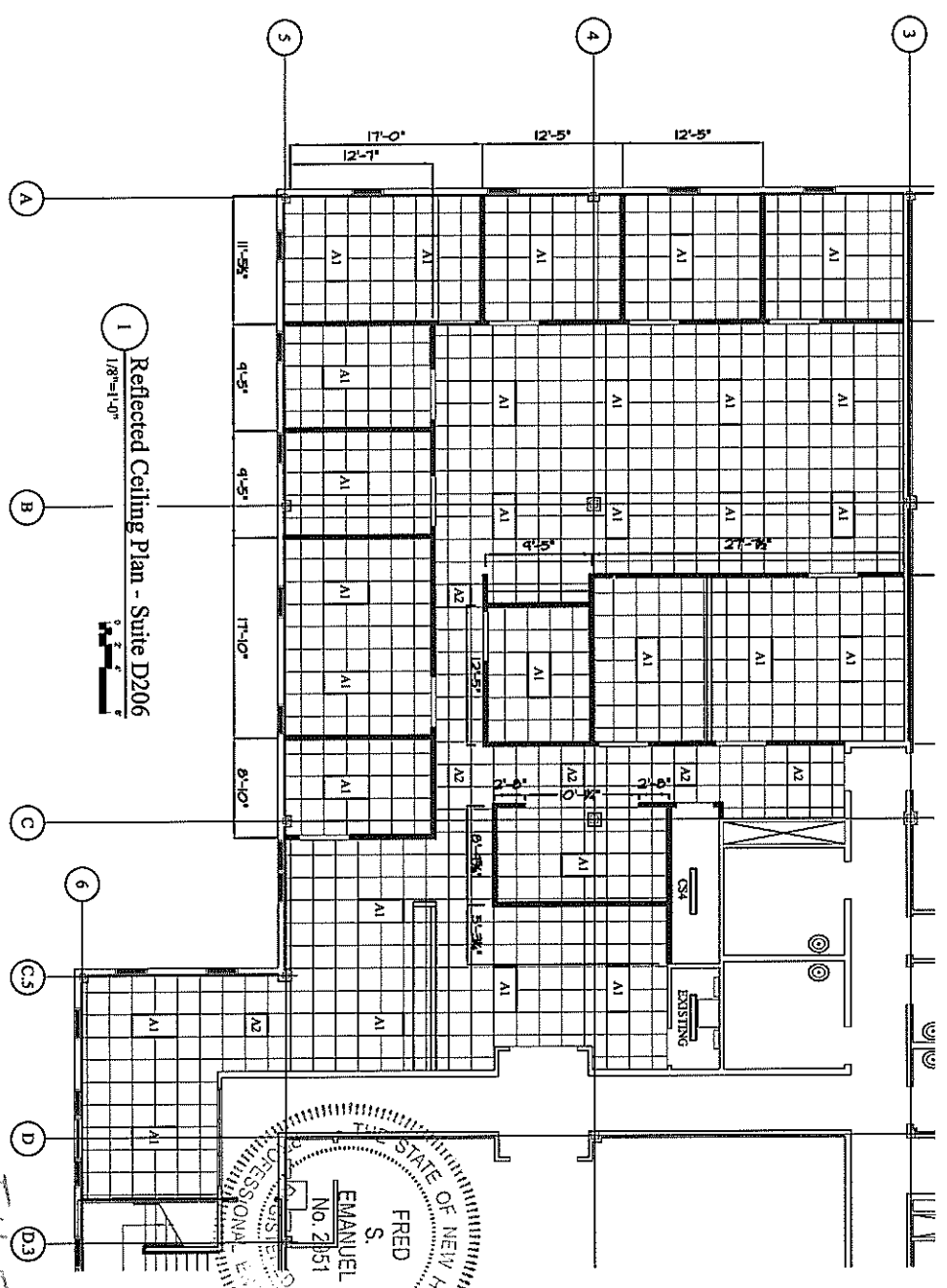
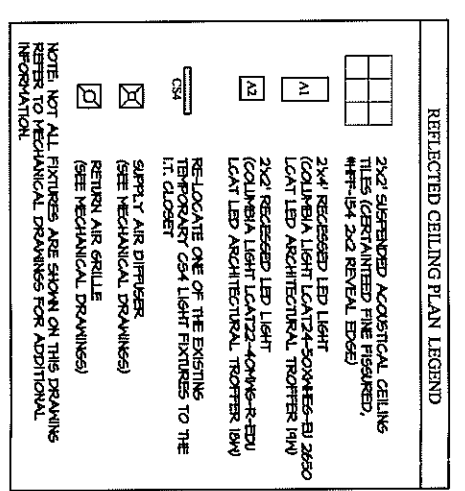
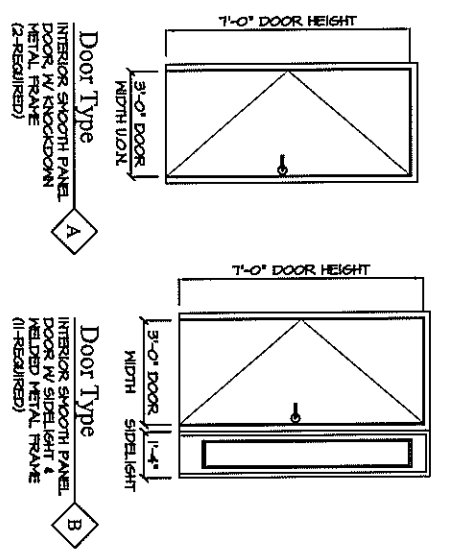

Professional Engineer Stamp for Fred S. Emanuel, No. 2151, State of New Hampshire.

Prepared for: Millbrook Building "D" 118 Portsmouth Avenue Stratham, NH 03885

Designed by: RHG
 Checked by: FSE
 Drawn by: RHG
 Date: 5/12/20

Millbrook Building "D" 118 Portsmouth Avenue Suite D206 Fit-Up Stratham

THE STRUCTURAL "PROFESSIONAL ENGINEER" STAMP AFFIXED TO THIS DRAWING DOES NOT COVER CODE REQUIREMENTS RELATED TO OTHER DISCIPLINES SUCH AS ARCHITECTURAL, MECHANICAL, ELECTRICAL, PLUMBING, LIFE SAFETY, ETC.

EMANUEL ENGINEERING
 118 PORTSMOUTH AVENUE, A202 STRATHAM, NH 03885
 P: 603-772-4400 F: 603-772-4487
 WWW.EMANUELENGINEERING.COM

ISS.	DATE	DESCRIPTION OF ISSUE	CHK.
1	02/11/20	PROGRESS	
2	05/06/20	FOR PERMIT	
3	05/12/20	EGRESS PATH	

Job #: 20-007
 Scale: AS NOTED
 DWG: 1 OF 1

A1.1