

FOR SUBLEASE

SECORD VILLAGE

SEC 231 STREET AND 97 AVENUE, EDMONTON, AB



1,200 SF AVAILABLE IMMEDIATELY



CUSHMAN & WAKEFIELD
Edmonton
Suite 2700, TD Tower
10088 - 102 Avenue
Edmonton, AB T5J 2Z1
www.cwedm.com

Gary Killips
Partner
780 917 8332
gary.killips@cwedm.com

Cody Miner, B.COMM.
Associate
780 702 2982
cody.miner@cwedm.com

Cushman & Wakefield Edmonton is independently owned and operated / A Member of the Cushman & Wakefield Alliance. No warranty or representation express or implied is made to the accuracy or completeness of the information contained herein, and same is submitted subject to errors, omissions, change of price, rental or other conditions, withdrawal without notice, and to any special listing conditions imposed by the property owner(s). As applicable, we make no representation as to the condition of the property for properties in question. January 2026



PROPERTY HIGHLIGHTS

- Easy access to Anthony Henday, Whitemud Drive and 231 Street.
- Close proximity to Stony Plain Road with a VPD of 38,232.
- Zoning: CN - Neighbourhood Commercial
- David Thomas School (K-9) adjacent to the property accommodates 900 students.
- EMSA West Soccer Complex located immediately to the west has 11 fields and is proposed to grow to 20 fields.

THE OPPORTUNITY

1,200 SF available for sublease.

Existing tenants include: Tim Hortons, Liquor Hut, PharmaSave, Subway, Petro Canada, Green Chili Pizza, Secord Pharmacy and Clinic, Star Learners Daycare.

PROPERTY DETAILS

Municipal Address: 22943 97 Ave NW,
Edmonton, AB T5T 7P5

Parking Area: Ample Parking

Availability: Immediately

Size: 1,200 SF

Additional Rent: \$21.00 per SF EST. (2025)

Lease Rate: Contact Agent



DEMOGRAPHICS

| POPULATION | POPULATION | | |
|------------|------------|--------|--------|
| | 1km | 3km | 5km |
| | 6,401 | 30,441 | 55,278 |

| HOUSEHOLDS | HOUSEHOLDS | | |
|------------|------------|-------|--------|
| | 1km | 3km | 5km |
| | 1,861 | 9,467 | 17,813 |

| AVERAGE INCOME | AVERAGE INCOME | | |
|----------------|----------------|-----------|-----------|
| | 1km | 3km | 5km |
| | \$155,953 | \$149,413 | \$148,897 |



SITE PLAN

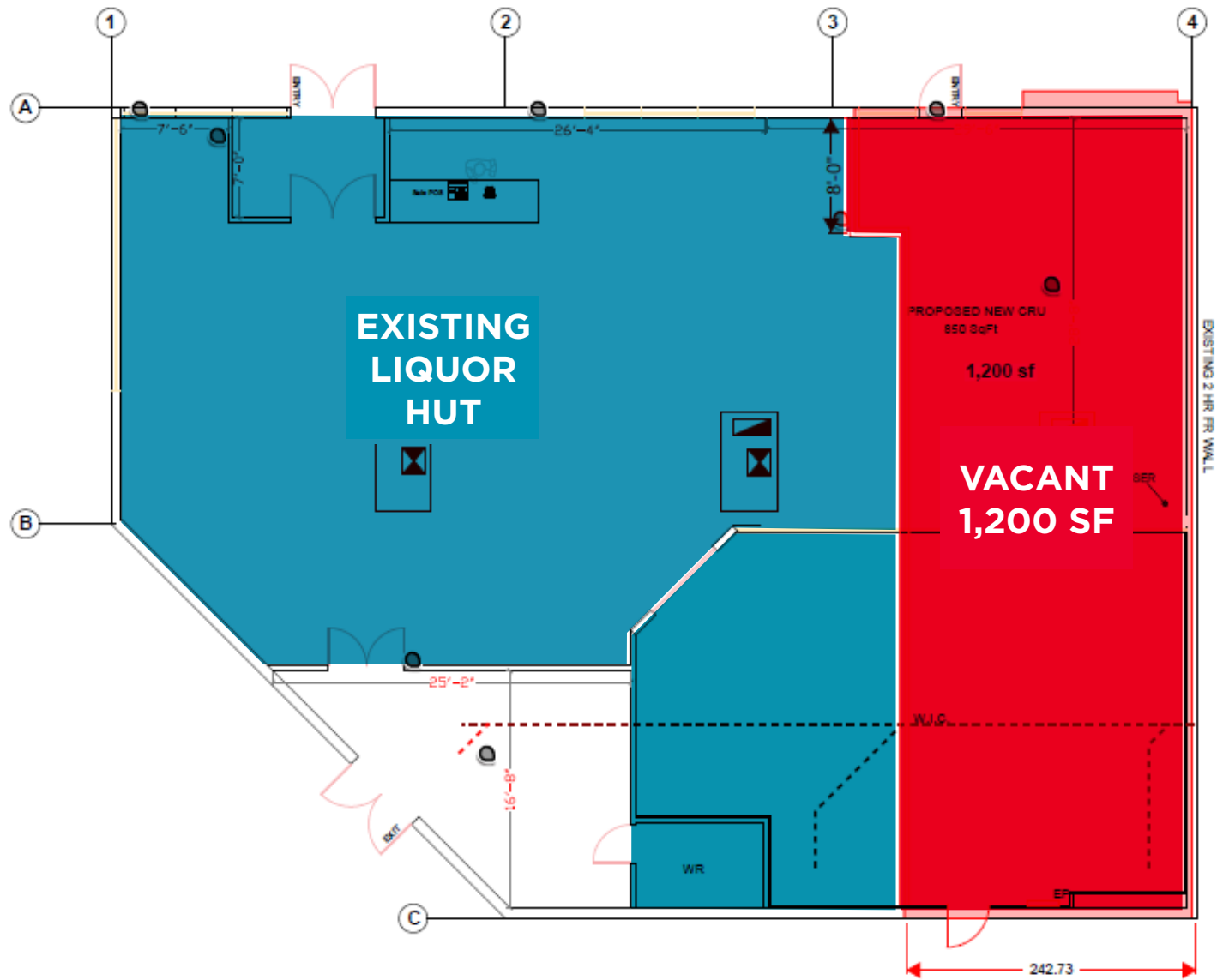

Gary Killips
Partner
780 917 8332
gary.killips@cwedm.com

Cody Miner, B.COMM.
Associate
780 702 2982
cody.miner@cwedm.com