

# 10TH FLOOR

ONE  
POST

Suite	1025
Size (RSF)	2,582
Date Available	Now

1 Boardroom  
2 Private offices  
Open space

\*\*Can be combined with Suite 1050 for a total of 7,275 RSF.

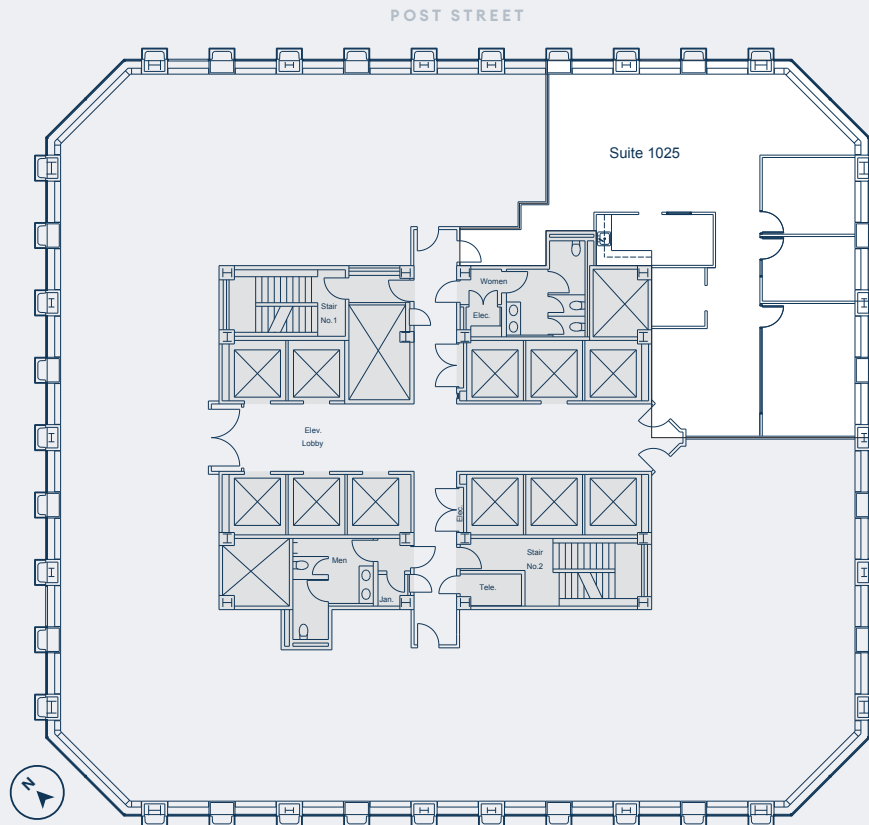

**MATTHEW SHEWEY**  
Senior Managing Director

415.395.7255  
matt.shewey@jll.com  
# License 0144515

**JAK CHURTON**  
Managing Director

415.395.7292  
jak.churton@jll.com  
# License 0127724

**CHARLIE HANAFIN**  
Senior Vice President

415.395.4951  
charlie.hanafin@jll.com  
# License 01856260

**CHRISTOPHER T. ROEDER**  
Vice Chairman

415.395.4971  
chris.roeder@jll.com  
# License 01190523



**Brookfield**  
Properties

Jones Lang LaSalle Americas, Inc.  
Real Estate License # 01223413