

# FOR LEASE

*240± Sq. Ft. Office / Retail Space*



*91 W. Main Street Suite D, Woodland, CA*

Located in well established retail complex  
2 Small Office or Salon Space  
Private parking lot  
Monument Signage

**Lease Rate: \$615.00**

**SALLING PROPERTIES INC.**

DRE No. 02201437

REAL ESTATE SALES, LEASING & PROPERTY MANAGEMENT

20 N. East Street, Suite 101, Woodland, CA 95776

Phone: (530) 666-5485 Website: [www.Sheffield-RealEstate.com](http://www.Sheffield-RealEstate.com)

E-Mail: [sallingproperties@kathysallingrealtor.com](mailto:sallingproperties@kathysallingrealtor.com)

The information contained herein has been obtained from sources we deem reliable. We cannot, however, assume responsibility for its accuracy.

Listing Agent: **Bryan Sheffield, Agent**  
CalBRE: **02065645**  
Phone: **(530) 219-0281**  
E-Mail: **bsheffield100@gmail.com**

# 240± Sq. Ft. Office / Retail Space

## 91 W. Main Street, Suite D • Woodland, CA



## SALLING PROPERTIES INC.

DRE No. 02201437

REAL ESTATE SALES, LEASING & PROPERTY MANAGEMENT

20 N. East Street, Suite 101, Woodland, CA 95776

Phone: (530) 666-5485 Website: [www.Sheffield-RealEstate.com](http://www.Sheffield-RealEstate.com)

E-Mail: [sallingproperties@kathysallingrealtor.com](mailto:sallingproperties@kathysallingrealtor.com)

The information contained herein has been obtained from sources we deem reliable. We cannot, however, assume responsibility for its accuracy.

Listing Agent: **Bryan Sheffield, Agent**  
CalBRE: **02065645**  
Phone: **(530) 219-0281**  
E-Mail: **[bsheffield100@gmail.com](mailto:bsheffield100@gmail.com)**

**240± Sq. Ft. Office / Retail Space**  
**91 W. Main Street, Suite D • Woodland, CA**

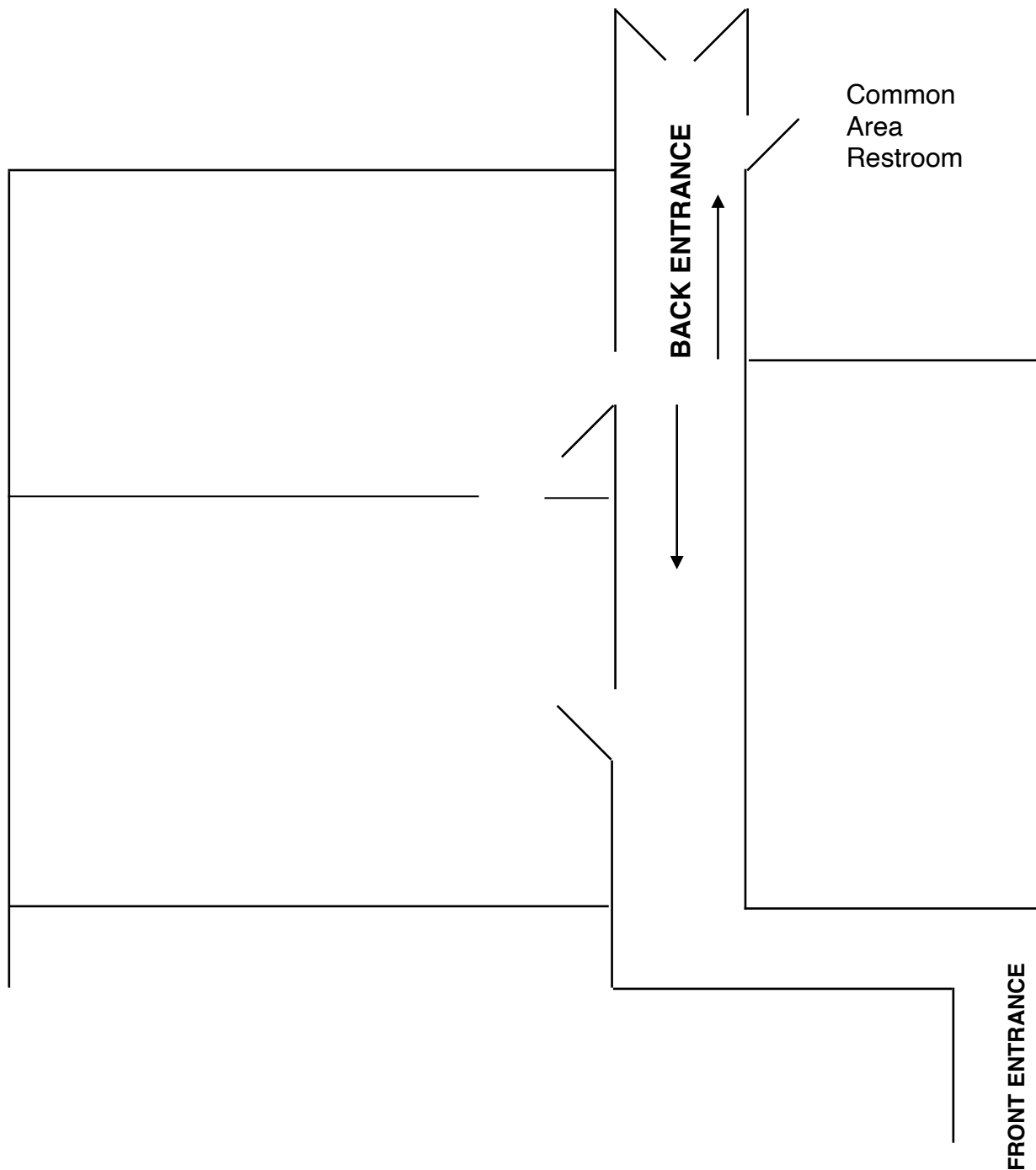

\*Drawing Not To Scale

**SALLING PROPERTIES INC.**

DRE No. 02201437

REAL ESTATE SALES, LEASING & PROPERTY MANAGEMENT

20 N. East Street, Suite 101, Woodland, CA 95776

Phone: (530) 666-5485 Website: [www.Sheffield-RealEstate.com](http://www.Sheffield-RealEstate.com)

E-Mail: [sallingproperties@kathysallingrealtor.com](mailto:sallingproperties@kathysallingrealtor.com)

The information contained herein has been obtained from sources we deem reliable. We cannot, however, assume responsibility for its accuracy.

Listing Agent: **Bryan Sheffield, Agent**  
CalBRE: **02065645**  
Phone: **(530) 219-0281**  
E-Mail: **bsheffield100@gmail.com**