

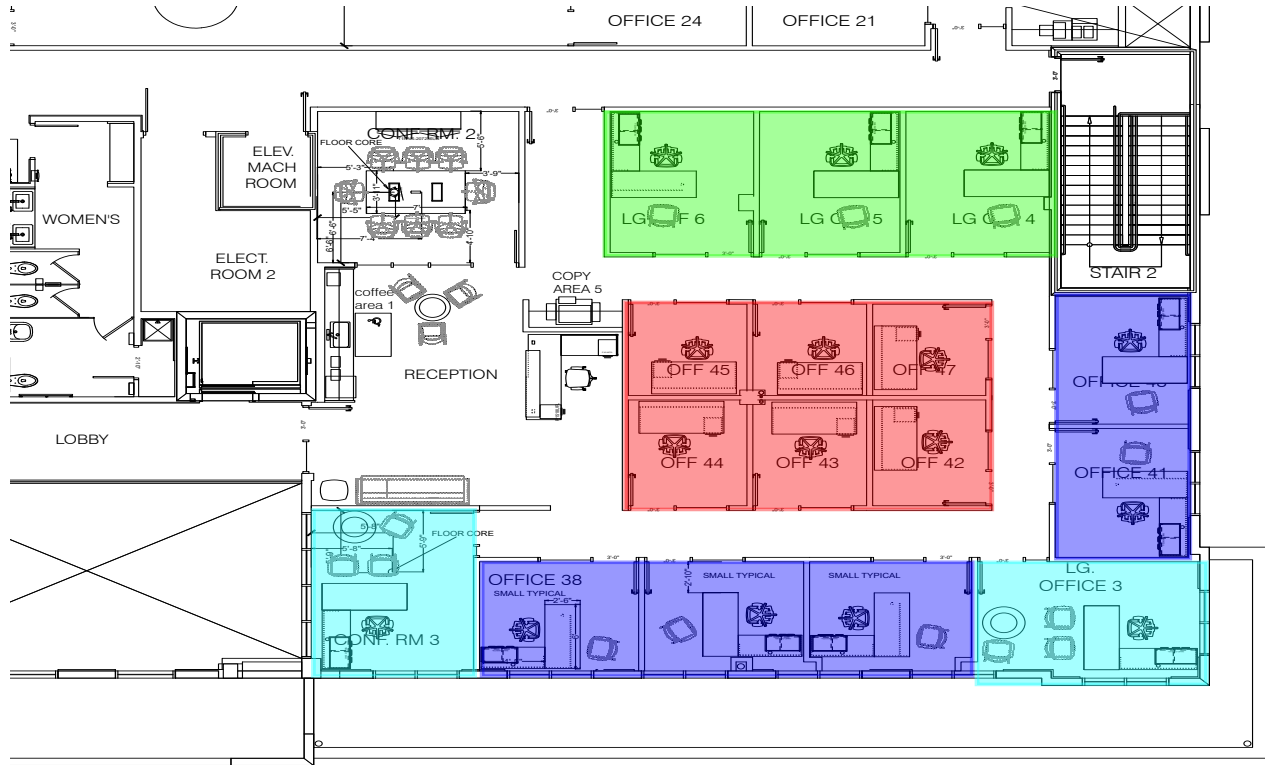

# Executive Suites



## SPACE FEATURES

- Short-term leases: 3, 6 & 12 months
- Fiber optic connectivity
- High-end finishes
- Modern exposed ceilings
- Corporate mailing address

FOR MORE  
INFORMATION  
PLEASE  
CONTACT

**CHRISTINE SIMPSON**  
EXECUTIVE DIRECTOR  
**Kelley Kronenberg**

Phone: 954.370.9970  
csimpson@kelleykronenberg.

